

Citizens Advisory Committee of the  
Eastern Neighborhoods Plan,  
City and County of San Francisco

**Notice of Meeting  
&  
Agenda**

1650 Mission Street, 4th Floor, Room 431  
**Monday, September 18, 2017**

**6:00 PM**

Walker Bass  
Chirag Bhakta  
Joe Boss  
Don Bragg  
Marcia Contreras

John Elberling  
Keith Goldstein  
Bruce Kin Huie  
Theresa Imperial  
Ryan Jackson  
Henry Karnilowitz

Toby Levy  
Irma Lewis  
Fernando Martí  
Dan Murphy  
Roshann Pressman  
Abbie Wertheim

---

**The Agenda is available at the Planning Department 1650 Mission Street, 4<sup>th</sup> floor and, on our website at [encac.sfplanning.org](http://encac.sfplanning.org), and at the meeting.**

1. Announcements and Review of Agenda.
2. Review and Approve Minutes from the June 19, 2017 and August 21, 2017 CAC Meetings.
3. The Central Waterfront / Dogpatch Public Realm Plan. Presentation by Planning Staff on the Central Waterfront / Dogpatch Public Realm Plan followed by discussion and potential action.
4. Dogpatch Complete Streets Projects. Presentation by SF Public Works staff on complete streets projects in the Dogpatch neighborhood and City staff's proposal for initial implementation followed by discussion and potential action.



5. Parks and Open Space in the Eastern Neighborhoods. Presentation by Recreation and Parks staff on proposed park rehabilitation projects in the Eastern Neighborhoods, the upcoming Parks Bond, and proposed approach to programming EN Recreation and Open Space funds, followed by discussion and potential action.
6. Neighborhood Engagement and EN Priority Projects. Discussions lead by CAC Chair on neighborhood engagement on EN priority capital projects, followed by discussion and potential action.
7. Public Comment. At this time, members of the public may address the Citizens Advisory Committee on items of interest to the public that are within the subject matter jurisdiction of the Committee but do not appear on the agenda. With respect to agenda items, the public will be given an opportunity to address the Committee when the item is reached in the meeting. Each member of the public may address the Committee for up to three minutes.

The Brown Act forbids a Committee from taking action or discussing any item not appearing on the posted agenda, including those items raised at Public Comment. In response to public comment on an item that is not on the agenda, the Committee is limited to:

- Briefly responding to statements made or questions posed by members of the public, or
- Requesting staff to report back on the matter at a subsequent meeting, or
- Directing staff to place the item on a future agenda. (Government Code Section 54954.2(a).)

#### **Cell Phone and/or Sound-Producing Electronic Devices Usage at Hearings**

Effective January 21, 2001, the Board of Supervisors amended the Sunshine Ordinance by adding the following provision: The ringing of and use of cell phones, pagers and similar sound-producing electronic devices are prohibited at this meeting. Please be advised that the Chair may order the removal from the meeting room of any person(s) responsible for the ringing or use of a cell phone, pager, or other similar sound-producing electronic devices (67A.1 Prohibiting the use of cell phones, pagers and similar sound-producing electronic devices at and during public meetings).

#### **San Francisco Lobbyist Ordinance**

Attention: Individuals and entities that influence or attempt to influence local legislative or administrative action may be required by the San Francisco Lobbyist Ordinance [SF Campaign and Governmental Conduct Code Section 21.00-2.160] to register and report lobbying activity. For more information about the Lobbyist Ordinance, please contact the Ethics Commission at 30 Van Ness Avenue, Suite 3900, San Francisco, CA 94102; telephone (415) 581-2300; fax (415) 581-2317; and web site <http://www.sfgov.org/ethics>.

#### **Accessible Meeting Policy**

Hearings are held at the Planning Department, 1650 Mission St., Room 431, fourth floor, San Francisco, CA. The closest accessible BART station is the Van Ness Avenue station located at the intersection of Market Street and Van Ness Avenue. Accessible curbside parking has been designated at points along Mission Street. Accessible MUNI lines serving the Planning Department are the 14 Mission, 26 Valencia, 47 Van Ness, 49 Van Ness/Mission, and the F Line. Accessible MUNI Metro lines are the J, K, L, M, and N. For more information regarding MUNI accessible services, call (415) 923-6142.

Disability Accommodations: To request assistive listening devices, real time captioning, sign language interpreters, readers, large print agendas or other accommodations, please contact the Department's ADA Coordinator, Candace SooHoo, at (415) 575-9157 or [candace.sooHoo@sfgov.org](mailto:candace.sooHoo@sfgov.org) at least 72 hours in advance of the meeting to help ensure availability. Accessible seating for persons with disabilities (including those using wheelchairs) will be available at meetings.



Language Assistance: To request an interpreter, please contact the Candace Soohoo, at (415) 575-9157, or [candace.sooahoo@sfgov.org](mailto:candace.sooahoo@sfgov.org) at least 72 hours in advance of the meeting.

**SPANISH**

Si desea asistir a la audiencia, y quisiera obtener información en Español o solicitar un aparato para asistencia auditiva, llame al (415) 575-9010. Por favor llame por lo menos 72 horas de anticipación a la audiencia.

**CHINESE**

聽證會上如需語言協助或求輔助設備 請致電(415) 575-9010。請在聽證會舉行之前的至少72個小時提出要求。

**FILIPINO**

Para sa tulong sa lengguwahe o para humiling ng Pantulong na Kagamitan para sa Pagdinig (headset), mangyari lamang na tumawag sa (415) 575-9121. Mangyaring tumawag nang maaga (kung maaari ay 72 oras) bago sa araw ng Pagdinig.

**RUSSIAN**

За помощью переводчика или за вспомогательным слуховым устройством на время слушаний обращайтесь по номеру (415) 575-9121. Запросы должны делаться минимум за 72 часов до начала слушания.

**Know Your Rights Under the Sunshine Ordinance**

Government's duty is to serve the public, reaching its decisions in full view of the public. Commissions, boards, councils and other agencies of the City and County exist to conduct the people's business. This ordinance assures that deliberations are conducted before the people and that City operations are open to the people's review.

For more information on your rights under the Sunshine Ordinance (Chapter 67 of the San Francisco Administrative Code) or to report a violation of the ordinance, contact Richard Knee, Chair of the Sunshine Ordinance Task Force, 1 Dr. Carlton B. Goodlett Place, Room 409, by phone at (415) 554-7724, by fax at (415) 554-7854 or by E-mail at [soff@sfgov.org](mailto:soff@sfgov.org).

Copies of the Sunshine Ordinance can be obtained from the Clerk of the Sunshine Task Force, the San Francisco Library and on the City's website at [www.sfgov.org/bdsupvrs/sunshine](http://www.sfgov.org/bdsupvrs/sunshine).

**PUBLIC COMMENT**

At this time, members of the public may address the Committee on items of interest to the public that are within the subject matter jurisdiction of the Committee except agenda items. With respect to agenda items, your opportunity to address the Committee will be afforded when the item is reached in the meeting with one exception. When the agenda item has already been reviewed in a public hearing at which members of the public were allowed to testify and the Committee has closed the public hearing, your opportunity to address the Committee must be exercised during the Public Comment portion of the Calendar. Each member of the public may address the Committee for up to three minutes.

The Brown Act forbids a committee from taking action or discussing any item not appearing on the posted agenda, including those items raised at public comment. In response to public comment, the committee is limited to:

1. responding to statements made or questions posed by members of the public; or
2. requesting staff to report back on a matter at a subsequent meeting; or
3. directing staff to place the item on a future agenda. (Government Code Section 54954.2(a))
4. submitting written public comment to Mat Snyder, 1650 Mission Street Ste. 400, San Francisco, CA 94103  
[mathew.snyder@sfgov.org](mailto:mathew.snyder@sfgov.org)





EASTERN NEIGHBORHOODS CITIZENS ADVISORY COMMITTEE  
UPDATE | 18 SEPTEMBER 2017



SFMTA  
Municipal  
Transportation  
Agency



San Francisco  
**Planning**





A photograph of a person standing on a rocky, uneven trail. The person is wearing a dark jacket, a light-colored skirt, and colorful striped socks. The background shows more rocks and some green grass. A dark blue rectangular overlay is positioned on the right side of the image, containing a list of topics for the evening.

## THIS EVENING'S TOPICS

1. Public Realm Plan Recap

2. Draft Outline

3. Pedestrian Master Plan

Pipeline map

Intersections of community concern

Key Pedestrian Routes

5. Timeline for Publication



# Policy Background

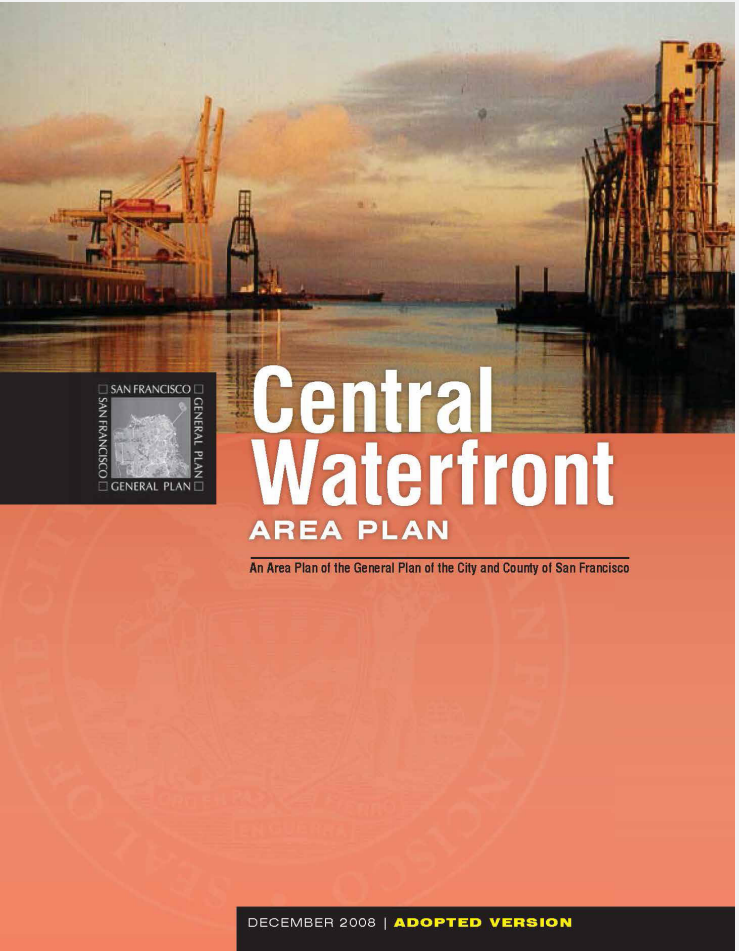
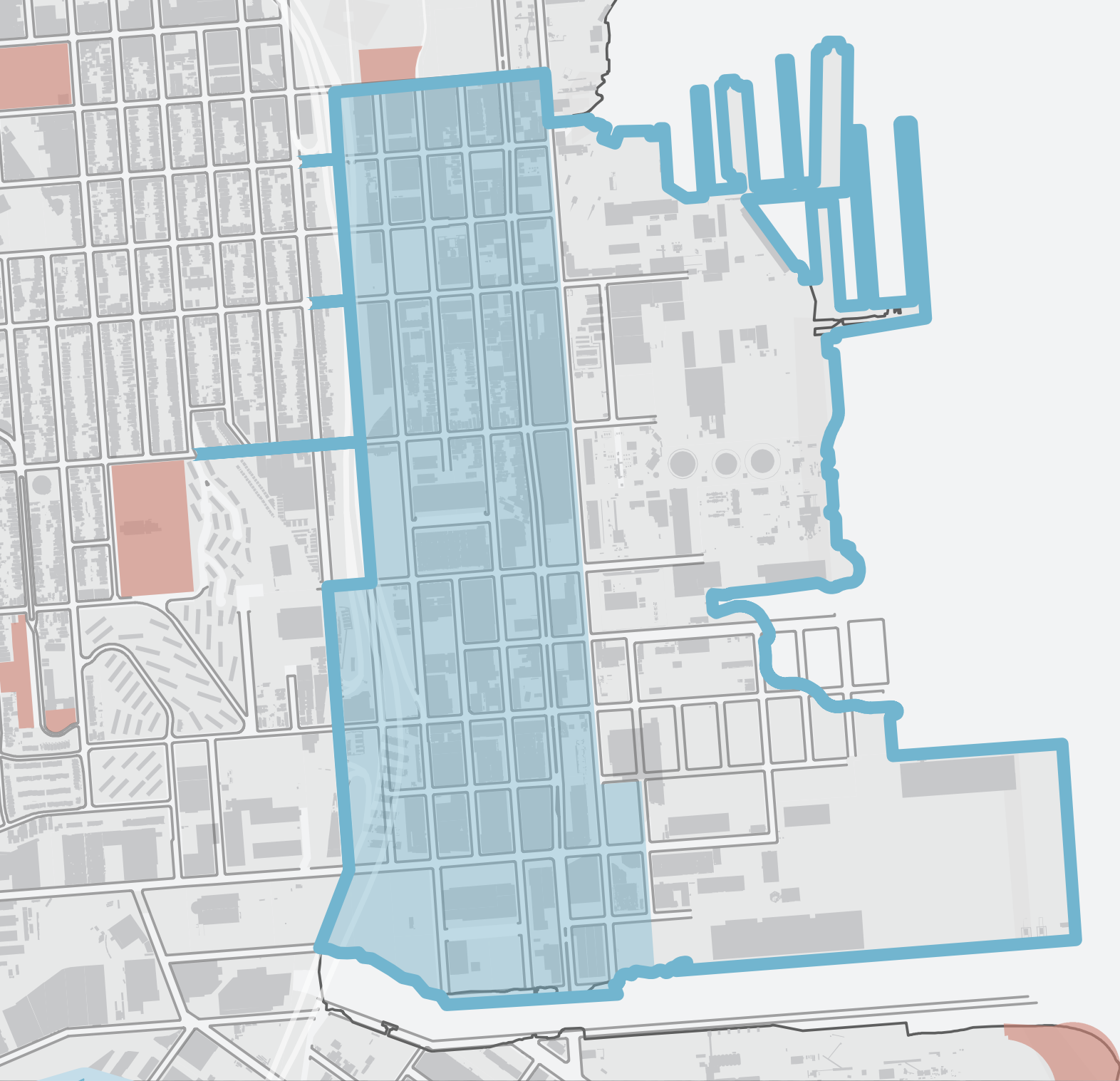

EASTERN NEIGHBORHOODS CITIZENS ADVISORY COMMITTEE  
PLAN UPDATE | 18 SEPTEMBER 2017





# Policy Background

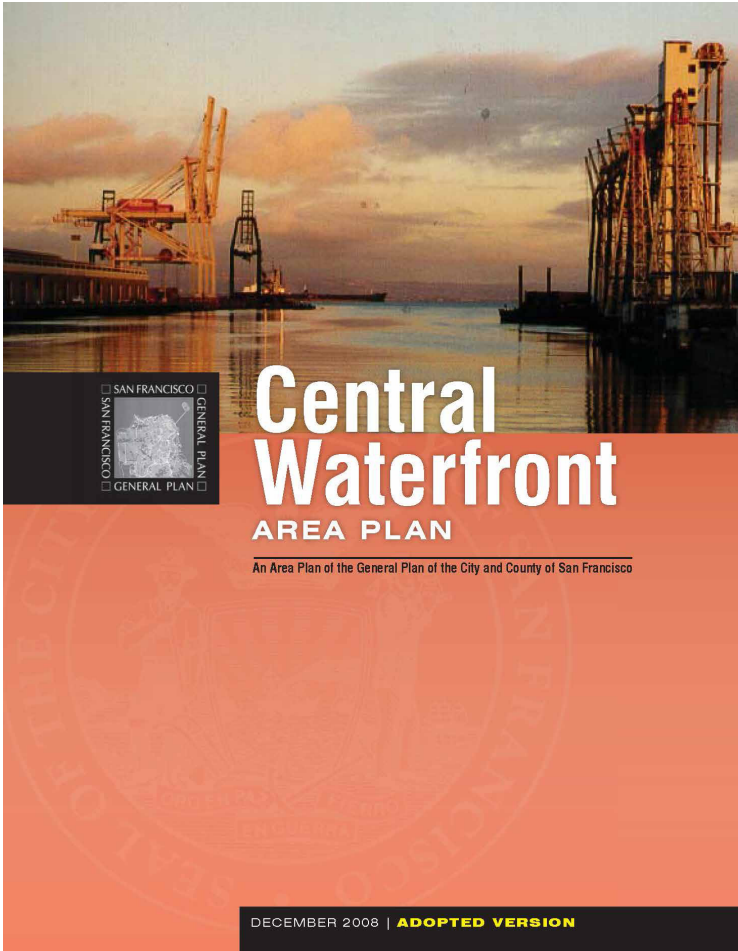

**OBJECTIVE 5.1** *Provide public parks and open spaces that meet the needs of residents, workers and visitors.*

**OBJECTIVE 5.3** *Create a network of green streets that connects open spaces and improves the walkability, aesthetics, and ecological sustainability of the neighborhood.*

**POLICY 5.3.1** *Redesign underutilized portions of streets as public open spaces, including widened sidewalks or medians, curb bulb-outs, “living streets” or green connector streets.*

**POLICY 5.3.2** *Maximize sidewalk landscaping, street trees and pedestrian scale street furnishing to the greatest extent feasible.*





# Policy Background

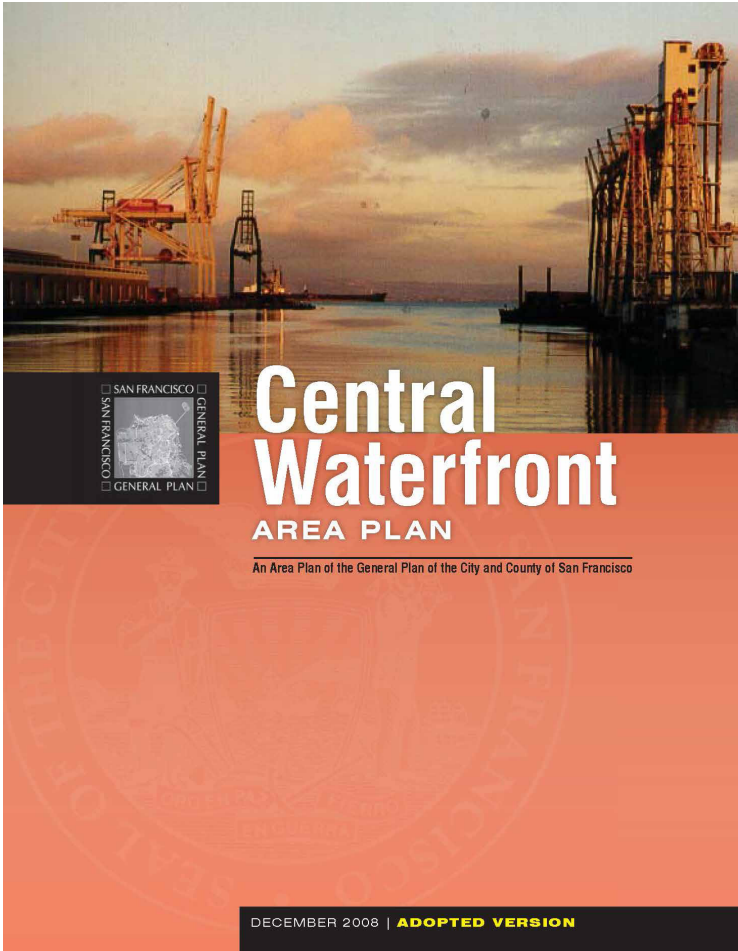

**POLICY 5.3.3** *Design intersections of major streets to reflect their prominence as public spaces.*

**POLICY 5.3.4** *Enhance the pedestrian environment by requiring new development to plant street trees along abutting sidewalks. When this is not feasible, plant trees on development sites or elsewhere in the plan area.*

**POLICY 5.3.5** *Significant above grade infrastructure, such as freeways, should be retrofitted with architectural lighting to foster pedestrian connections beneath.*

**POLICY 5.3.6** *Where possible, transform unused freeway and rail rights-of-way into landscaped features that provide a pleasant and comforting route for pedestrians.*





# Plan Process & Outcomes



## IDENTIFY PROJECTS

Through a robust community engagement process, finalize a prioritized list of streetscape, open space, and other public realm projects.



## DEVELOP DESIGNS

Working with neighborhood residents, businesses, and property owners, produce conceptual design for the highest priority projects. Develop design strategies for the remaining projects.



## ESTIMATE COSTS

Provide robust cost estimates for each of the projects identified in the plan, including area-wide improvements.



## PROGRAM IN CCP

Allocate public funds for projects based on the cost estimates. Schedule in the the City's capital plan for implementation, coordinating with existing public and private projects.



# Policy Background

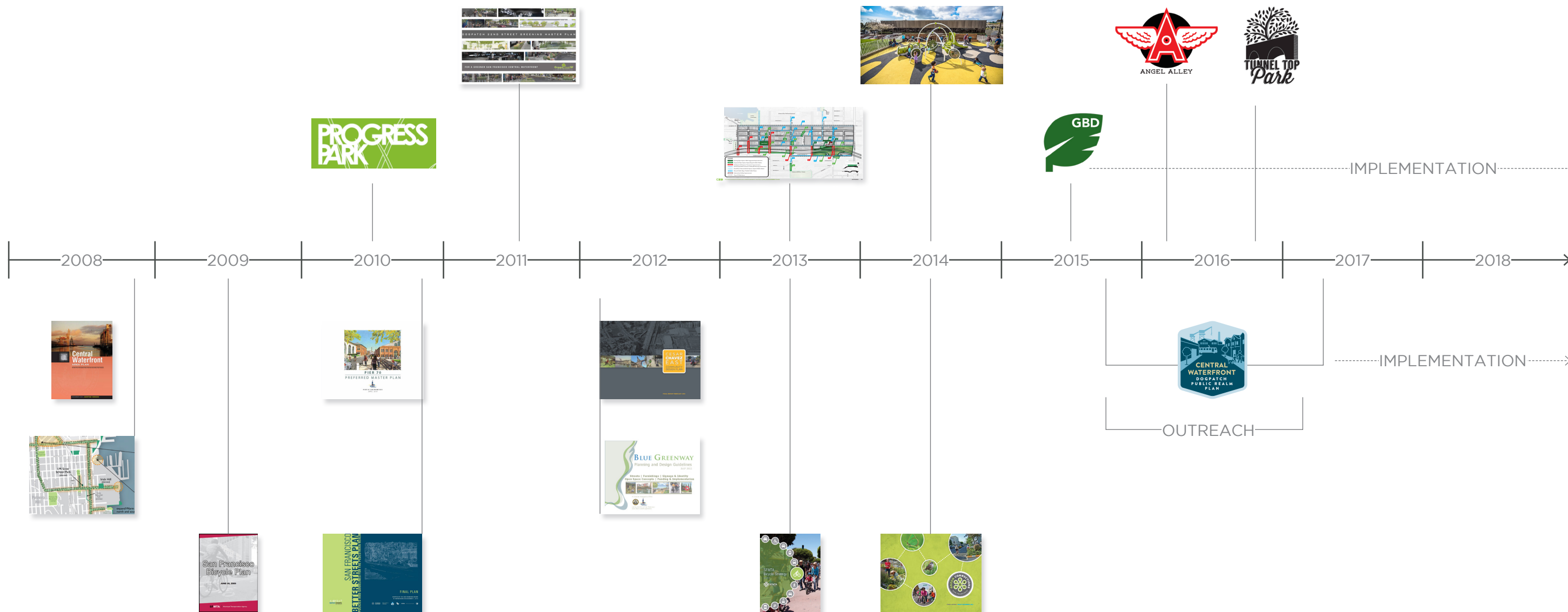



# Community Outreach & Engagement

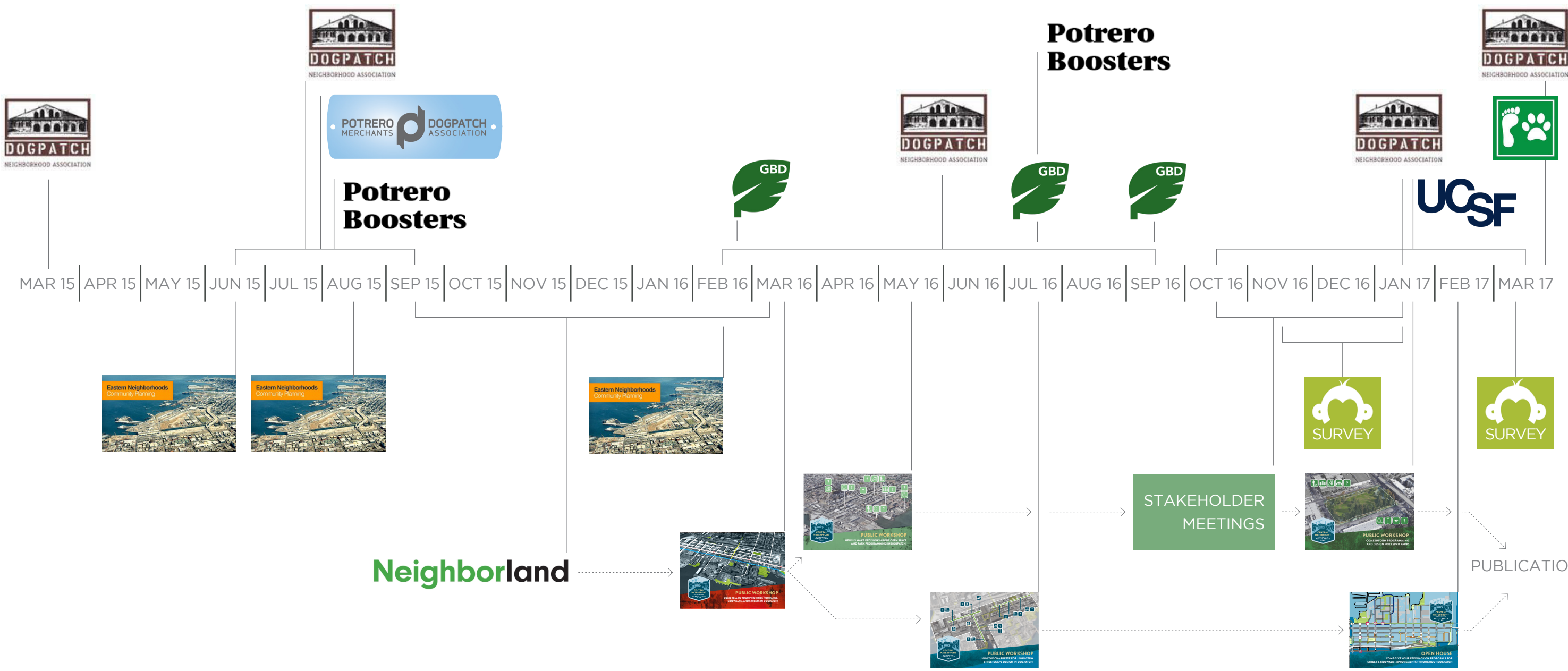





# CONTENTS

## INTRODUCTION X

Background and Context	x
Public Realm Plan Goals	x
Policy Background and Related planning Efforts	x

## PLAN DEVELOPMENT X

Community Engagement Overview	x
Workshop #1: Priorization	x
Workshop #2a: Open spaces and parks	x
Workshop #2b: Complete Streets	x
Stakeholder Focus Groups: Open spaces and parks	x
Workshop #3: Esprit Park	x
Workshop #4: Complete Streets	x

## PLAN AREA CONTEXT X

Historical Context <sup>1</sup>	x
Neighborhood Resources	x
Built Form	x
Zoning, Land Use, and Building Controls	x
Neighborhood Assets	x
Development Pipeline (2005 – 2015)	x
Demographics	x
Transportation & Transit	x
Tree coverage	x

## COMPLETE STREETS X

Existing Conditions	x
Streetscape Design Principles	x
Area-Wide streetscape improvements	x
Priority Design Corridors	x
Minnesota Street, north	x
Minnesota Street, south	x
24th Street Green Connection	x
Parking Management Plan	x
Indiana Street Bikeway	x

## PARKS AND OPEN SPACE X

District-level Analysis	x
Priority Open Spaces	x
Esprit Park	x
Warm Water Cove	x
Tunnel Top Park	x
Woods Yard	x
Minnesota Grove	x
Caltrans Parcels	

## RECOMMENDATIONS FOR IMPLEMENTATION X

Parks & Open Space	x
Complete Streets	x





# Streetscape: Area - Wide Improvements

PUBLIC REVIEW DRAFT: POTENTIAL AREA-WIDE IMPROVEMENTS (02/14/2017)

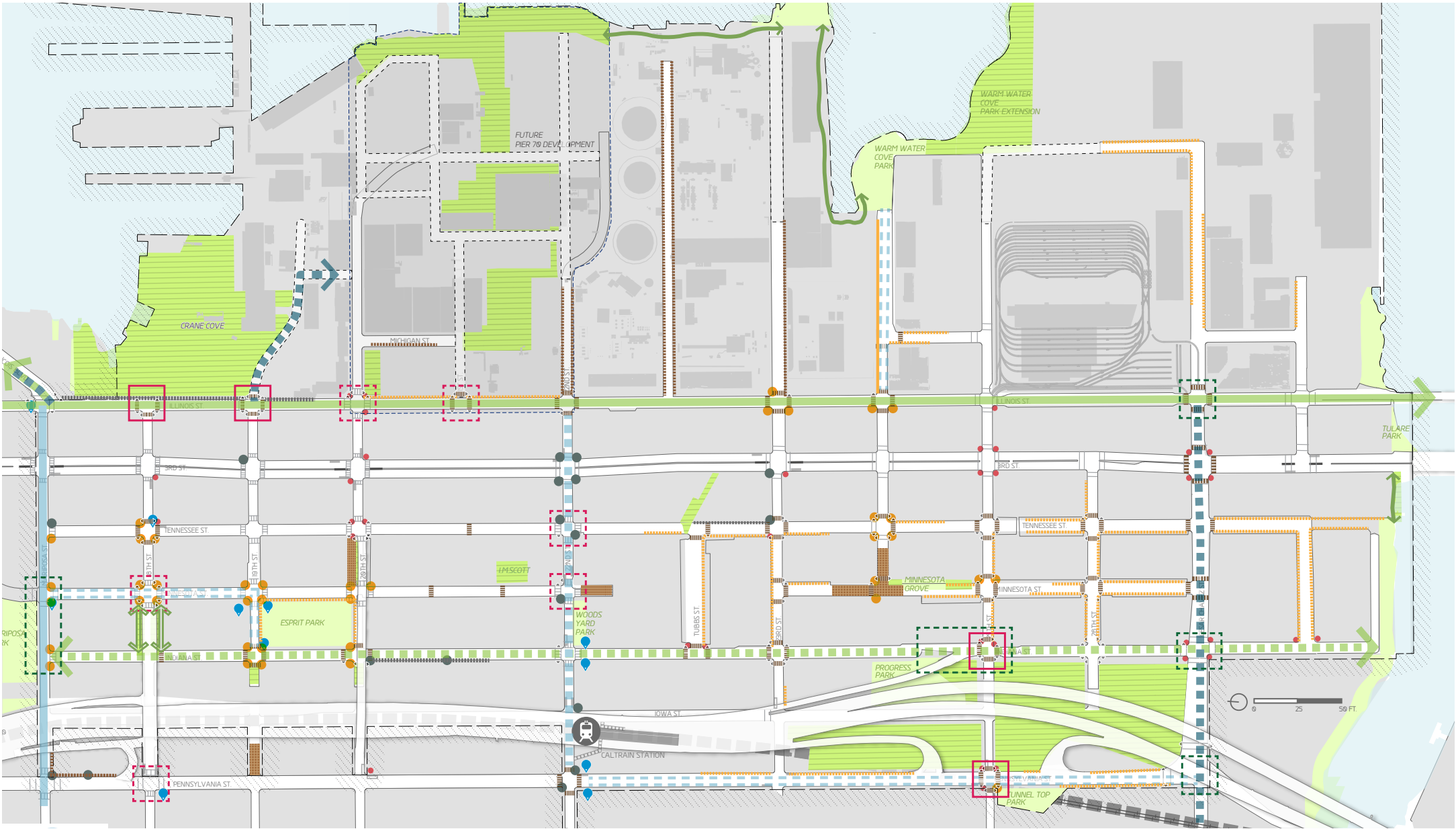

- PEDESTRIAN CONNECTION PLANNED
- PEDESTRIAN CONNECTION PROPOSED
- SIDEWALK / PATH OF TRAVEL IMPROVEMENT PROPOSED
- SIDEWALK PLANNED
- SIDEWALK UNDER CONSTRUCTION

- BULB-OUT PROPOSED
- BULB-OUT PLANNED
- BULB-OUT POTENTIAL (IF DESIGNED FOR LARGE TURNING VEHICLES)
- CURB RAMPS PROPOSED

- EXISTING CROSSWALKS
- CROSSWALK IMPROVEMENT PROPOSED
- NEW STOP CONTROL PROPOSED
- NEW SIGNALIZATION PROPOSED
- INTERSECTION IMPROVEMENTS FOR CYCLISTS PROPOSED

- CLASS IV CYCLE TRACKS PLANNED
- EXISTING CLASS II BIKE LANE
- CLASS II BIKE LANE PLANNED
- EXISTING CLASS III BIKE ROUTE
- CLASS III BIKE ROUTE PLANNED
- CLASS III BIKE ROUTE PROPOSED
- STREET CONNECTION PLANNED

- POTENTIAL SHARED STREET
- POTENTIAL BIKESHARE STATIONS
- EXISTING BUS STOPS
- EXISTING OPEN SPACE
- FUTURE OPEN SPACE

ASSUME NEW INFILL STREET TREES, SIDEWALK PLANTINGS, & PEDESTRIAN LIGHTING THROUGHOUT PLAN AREA



# Development Pipeline

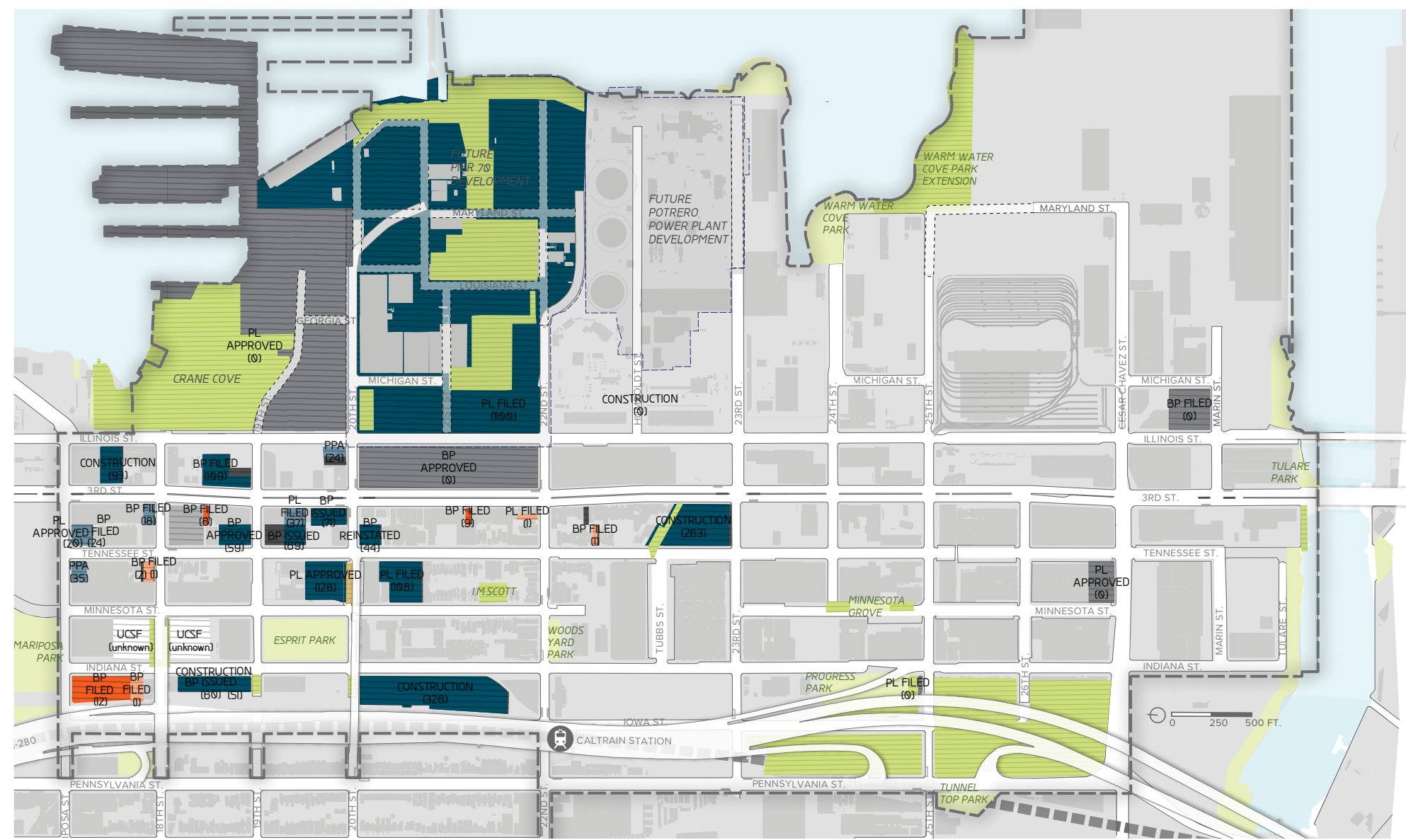

## Q3 2016 PIPELINE PROJECTS 11/14/2016

- 1-4 UNITS
- 5-14 UNITS
- 15-39 UNITS
- 40+ UNITS
- COMMERCIAL
- EXISTING OPEN SPACE
- FUTURE OPEN SPACE



# Development Pipeline + Existing Residential Density

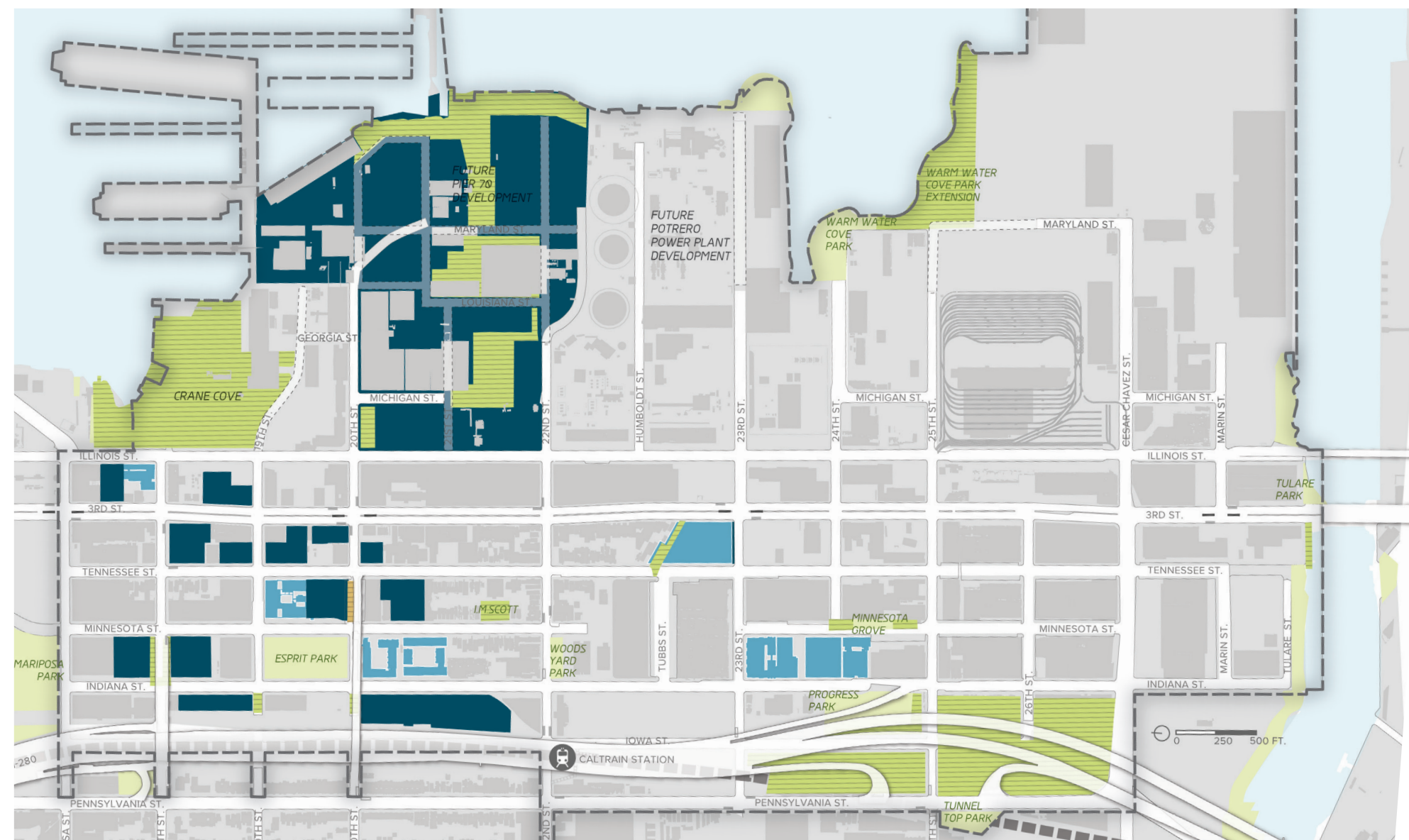

## Q3 2016 PIPELINE PROJECTS

- over 39 Units existing
- over 39 units pipeline
- EXISTING OPEN SPACE
- FUTURE OPEN SPACE



# Community & Cultural Institutions

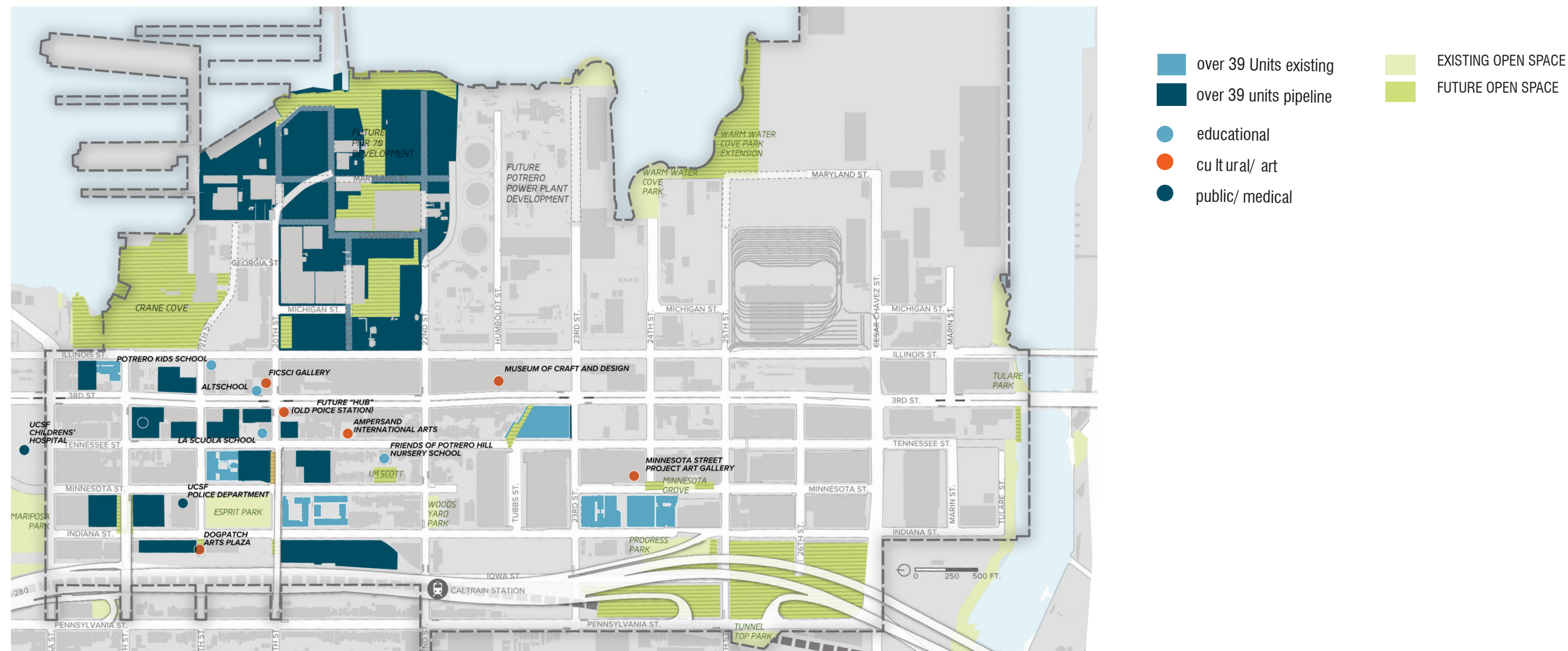



# Community & Cultural Institutions + Intesections of Concern





# draft Key Pedestrian Routes

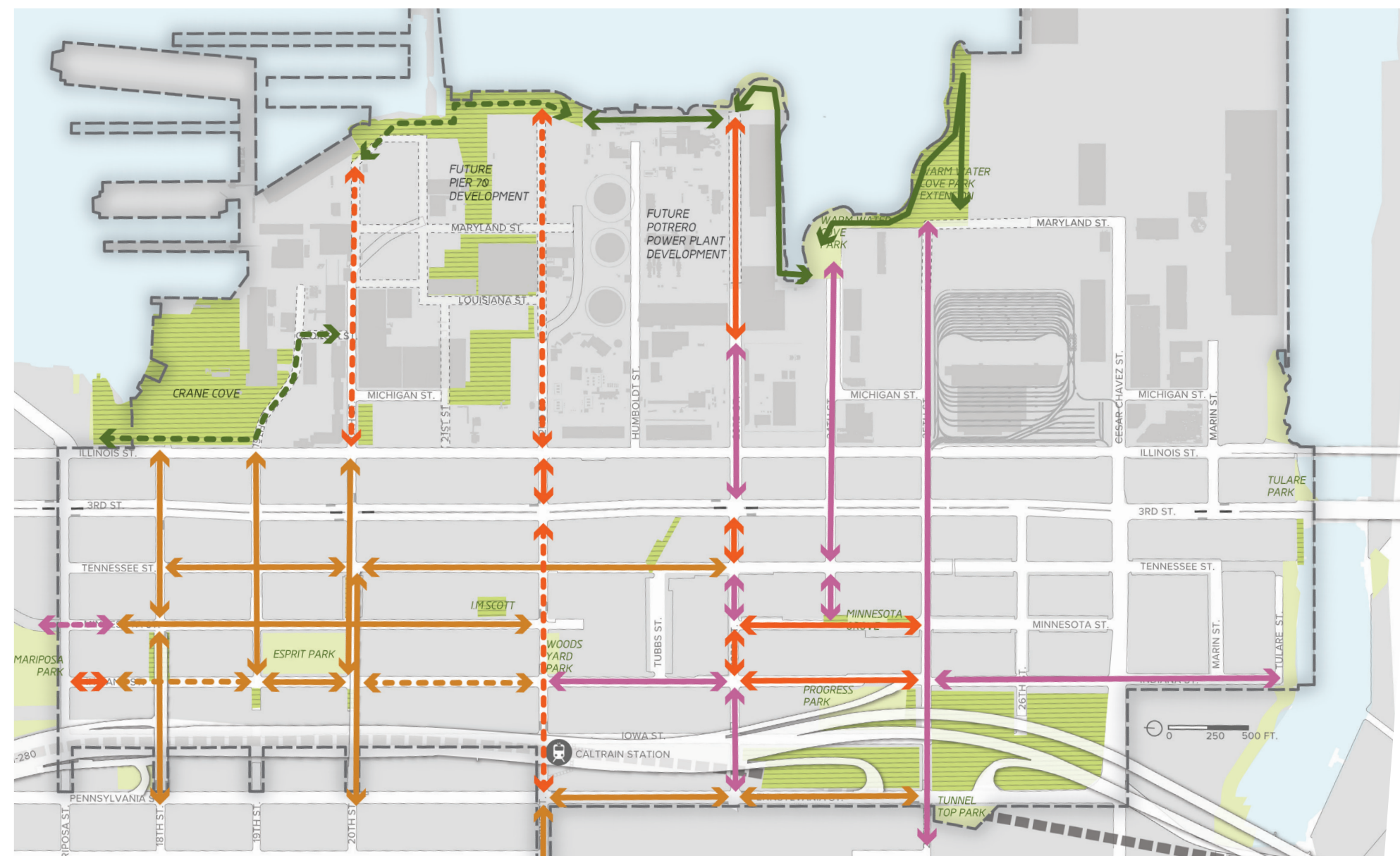

- residential
- mixed
- pdr
- shoreline

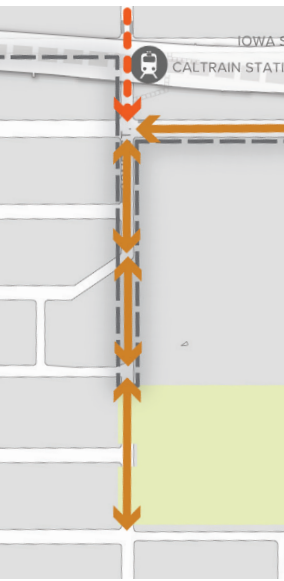



# Planning Effort Timeline

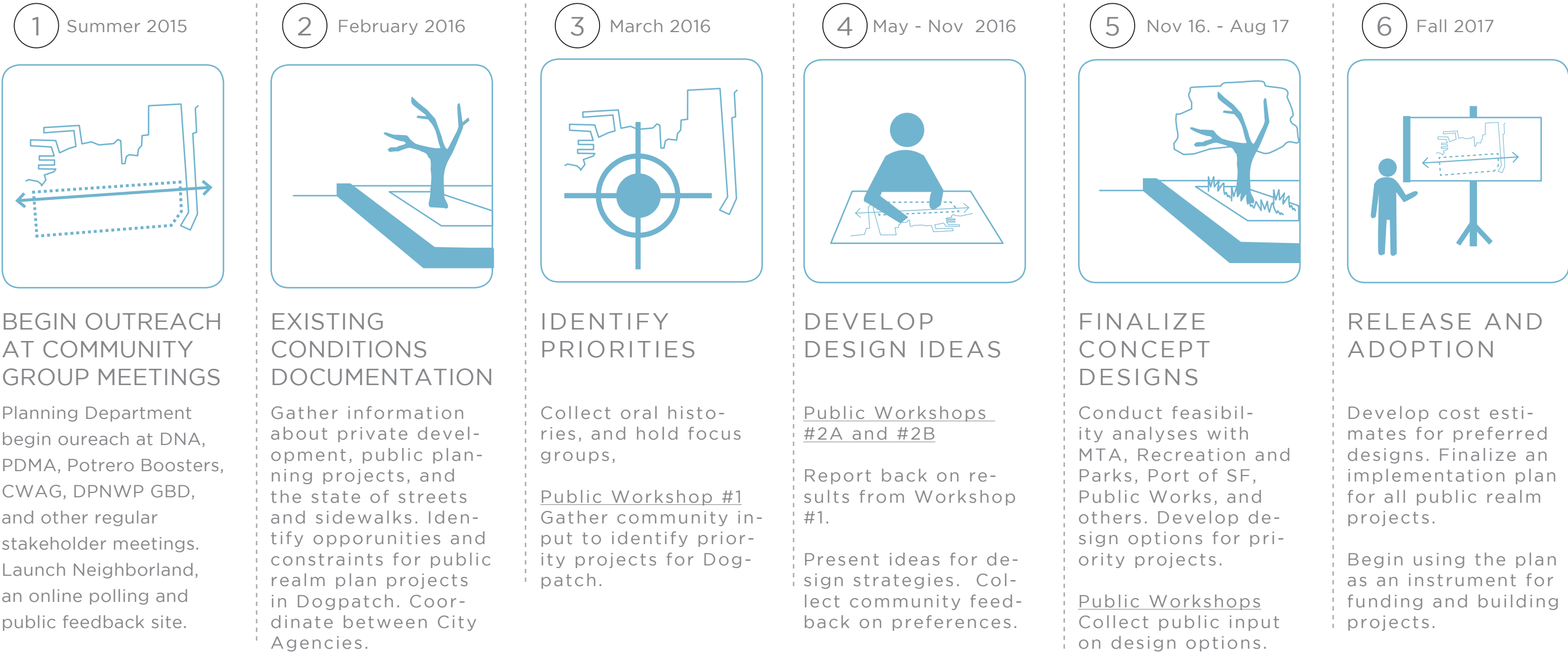



# Community Meeting Public Realm Plan Launch Thursday, November 9, 2017



EASTERN NEIGHBORHOODS CITIZENS ADVISORY COMMITTEE  
PLAN UPDATE | 18 SEPTEMBER 2017



SFMTA  
Municipal  
Transportation  
Agency



San Francisco  
**Planning**





# Next Steps

OCT 2017	Interagency Peer Review
NOV 2017	Release Public Review Draft
DEC 2017	Potrero Boosters
3rd WEDS	Central Waterfront Advisory Committe
1st THURS	Penninsula Joint Powers Board of Directors (Caltrain)
AS NEEDED	Dogpatch - NW Potrero Hill Green Benefit District
AS NEEDED	Tunnel Top Park Steering Committee
AS NEEDED	Port of SF / Office of Economic & Workfoce Devel
AS NEEDED	HOPE SF / Portrero Hill





# Dogpatch Capital Planning

ENCAC Meeting – September 18, 2018



**SFMTA**  
Municipal  
Transportation  
Agency



# DOGPATCH CAPITAL PLANNING

## ❑ WHO:

Led by Public Works and MTA, departments who implement capital projects

## ❑ WHAT:

- The capital planning process will identify projects, in order of priority, to secure funding
- Prioritized projects can begin with a commitment of partial funding

## ❑ HOW:

The City's considers the following input

- Public Realm Plan- analysis of data, feedback at community meetings,
- Other community input - EN CAC, other community concerns
- City's Prioritization Criteria – from Josh Low's, Capital Planning, May 15, 2017 presentation

## ❑ WHEN:

- Once priorities are established, funding can be programmed and included in the City's capital budget
- Today we are looking at Dogpatch capital planning over the next 3- 5 years
- Funding commitments made by November 2017 go into the City's FY 18/19 capital budget



## ■ Common across project types:

- Accommodate new growth
- Creating a network between major uses
- Proximity to density

*Josh Low, Capital Planning  
May 15, 2017, EN CAC Presentation*

## ■ Streetscapes

- Safety & Vision Zero
- Heaviest pedestrian routes
- Ownership of the street

## ■ Open Space

- Filling system-wide program gaps
- Seismic retrofitting
- Potential to expand



Q3 2016 PIPELINE PROJECTS  
11/14/2016

PIPELINE PROJECTS

## CURRENT LAND USE

EXISTING OPEN SPACE  
FUTURE OPEN SPACE  
RESIDENTIAL  
MIXED (RESIDENTIAL)  
COMMERCIAL RETAIL  
COMMERCIAL RESTAURANT

MIXED (NON-RESIDENTIAL)  
PDR OR OFFICE  
CULTURAL / INSTITUTIONAL / EDUCATIONAL  
VACANT / UNKNOWN

# Land use Map

ENCAC Meeting – September 18, 2017

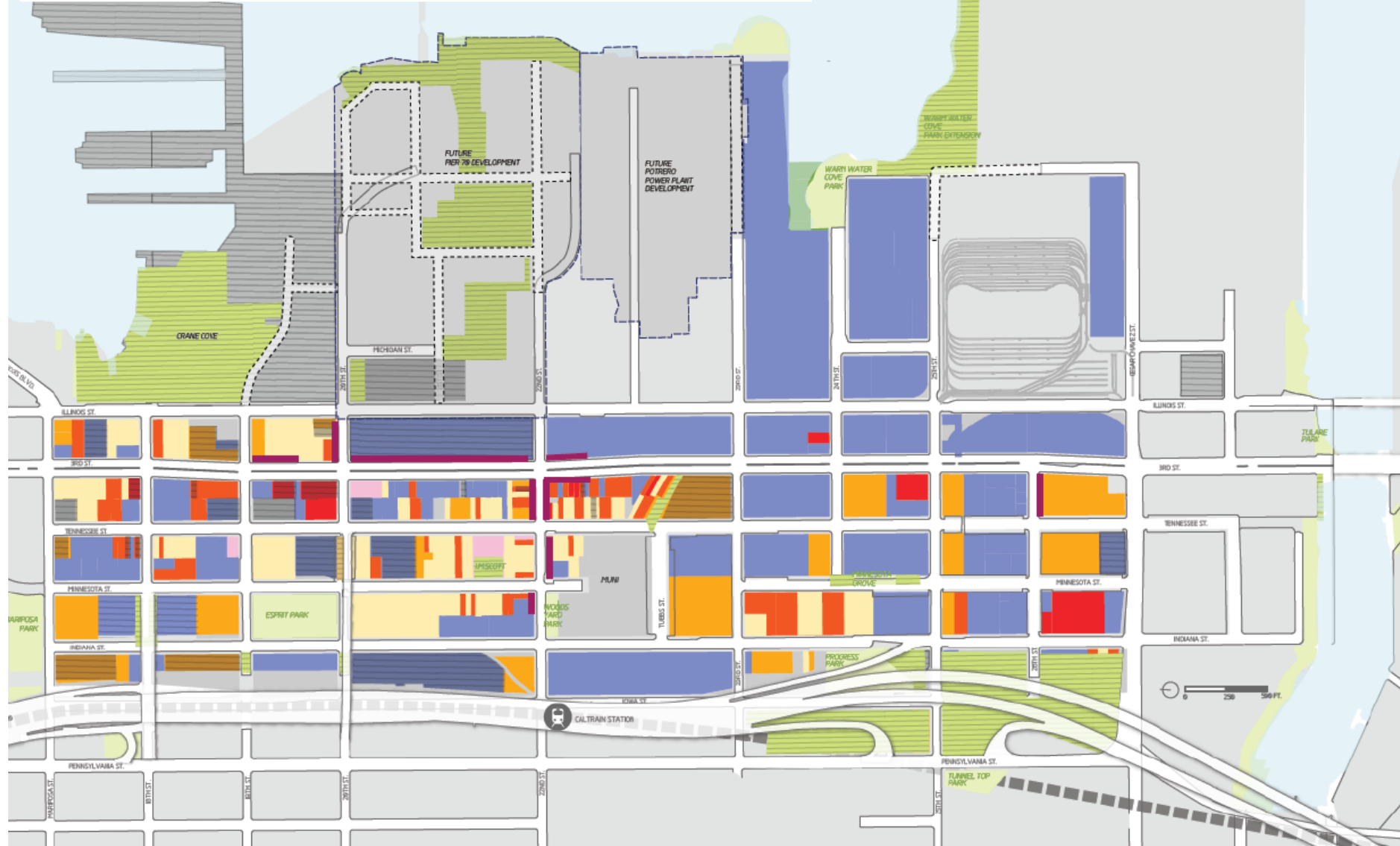



ENCAC Meeting – September 18, 2017





## E



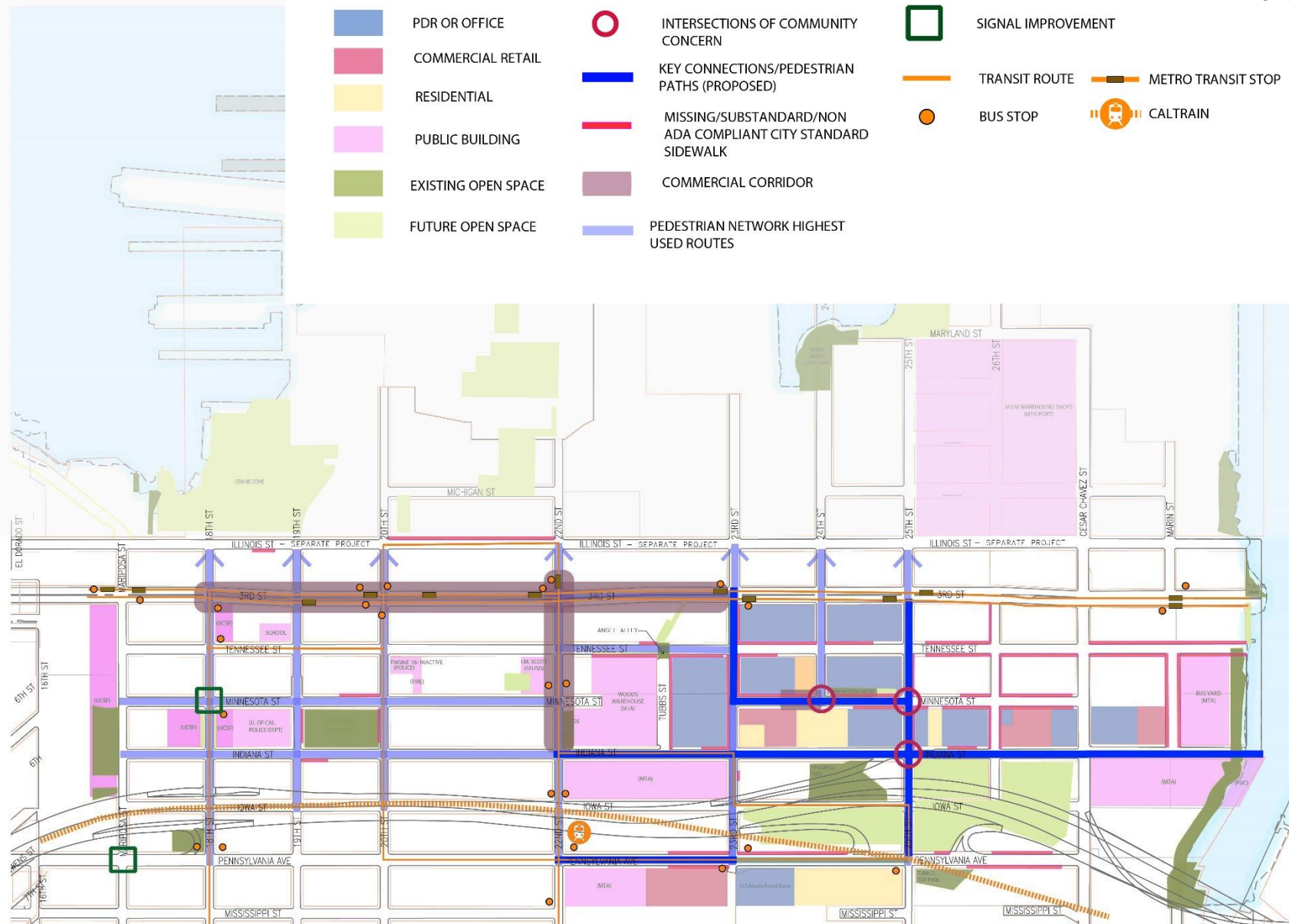

## PEDESTRIAN NETWORK PRIORITIZATION (09/18/2017)

### SIDEWALKS, INTERSECTIONS AND PEDESTRIAN CROSSINGS





# PRIORITY PROJECTS 2018-2023

## 1. Minnesota Street, 23rd to 25th streets, including Minnesota Grove

Scope: infill sidewalks and streetscape, intersection improvements, Minnesota Grove upgrades (ADA compliance, lighting, extension southward)

Cost estimate: ~\$2.3M

## 2. 25th Street, 3rd to Pennsylvania streets

Scope: infill sidewalks and lighting, bulbouts at Pennsylvania, Minnesota and Indiana streets where feasible.

Cost estimate: ~\$5.5M

## 3. 23rd Street, 3rd to Minnesota streets (phase I)

Scope: infill sidewalks and lighting, bulbouts at Tennessee where feasible

Cost estimate: ~\$2.5M

## 4. Indiana Street, 22nd Street to Islais Creek (most potential for an ADA compliant route)

Scope: infill sidewalks, lighting and bulbouts where needed and feasible

Cost estimate: ~\$3.5M

## 5. Pennsylvania Street, 22nd to 23th streets

Scope: infill sidewalks

Cost estimate: ~\$675K



**Questions?**



San Francisco Recreation & Parks Department

# Eastern Neighborhoods

Citizens Advisory Committee

RPD Project Update

*September 18, 2017*



Inspire, Connect, Play!









Opened June 23, 2017

**IPIC Funding:**  
\$3,160,000

**Total Project Budget with Acquisition:**  
\$7,818,000

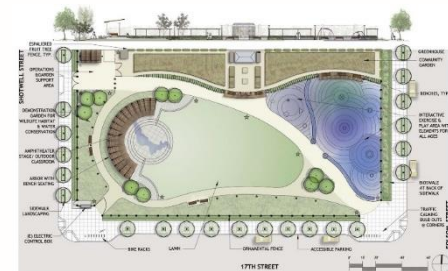





Opened March 7, 2017

**IPIC Funding:**  
\$1,500,000

**Total Project Budget :**  
\$4,010,000





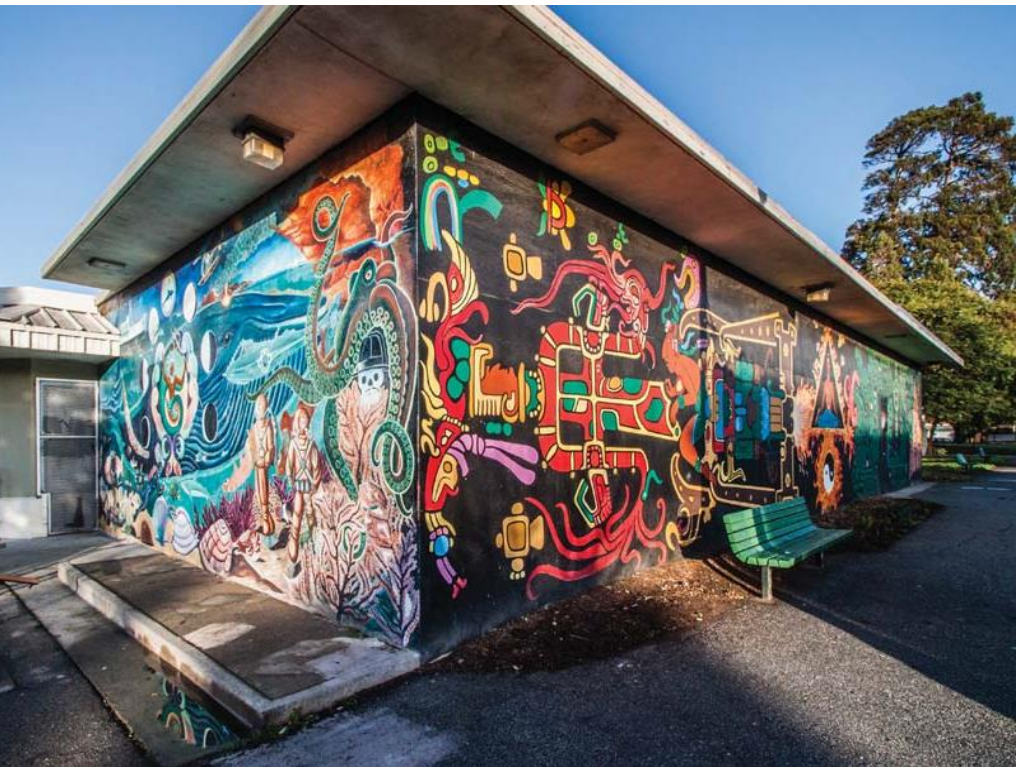







Within a quarter-mile of Garfield Pool, there are...

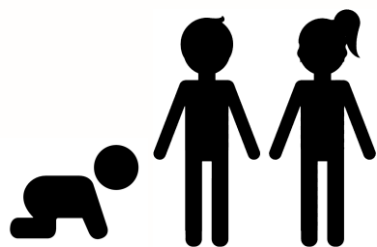

**2,000+**

youth ages 0-17

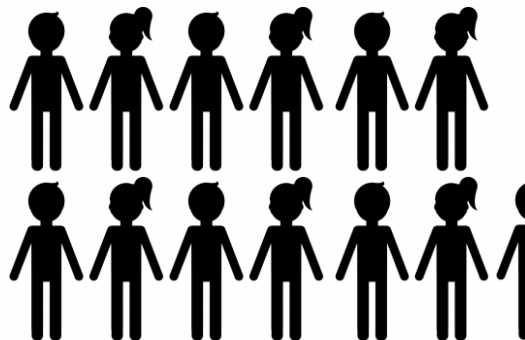

**12.5**

youths per acre

*City-wide is 2.05  
youths per acre*



**52%**

Hispanic/Latino population



At Garfield Pool from Fall 2016 through Summer 2017:

**1,593**  
youths ages  
0-17 were  
enrolled in  
programmed  
classes.

 **724** were waitlisted.





## Garfield Pool Survey Responses: Agree/Disagree Questions

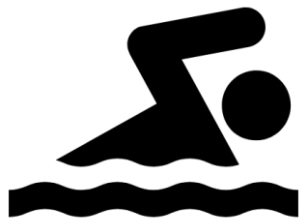

94%

like to go  
swimming



22%

are confused  
about how to  
access the pool  
(e.g. hours, location,  
cost, programs)

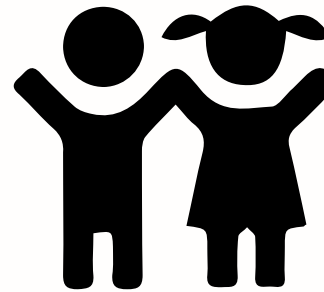

35%

would use pool  
more if it had  
more kid-friendly  
activities



64%

were participating in  
the public feedback  
process with the City  
for the first time



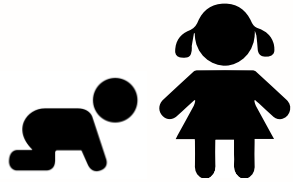

**79%**

of children in households with incomes less than **\$50,000** have little-to-no swimming ability.<sup>1</sup>



Formal swimming lessons reduces the likelihood of childhood drowning by

**88%.**<sup>2</sup>



**10** people drown each day in the United States.<sup>3</sup>



**64%** of African-American,  
**45%** of Hispanic/Latino,  
**40%** of Caucasian children have little to no swimming ability.<sup>2</sup>



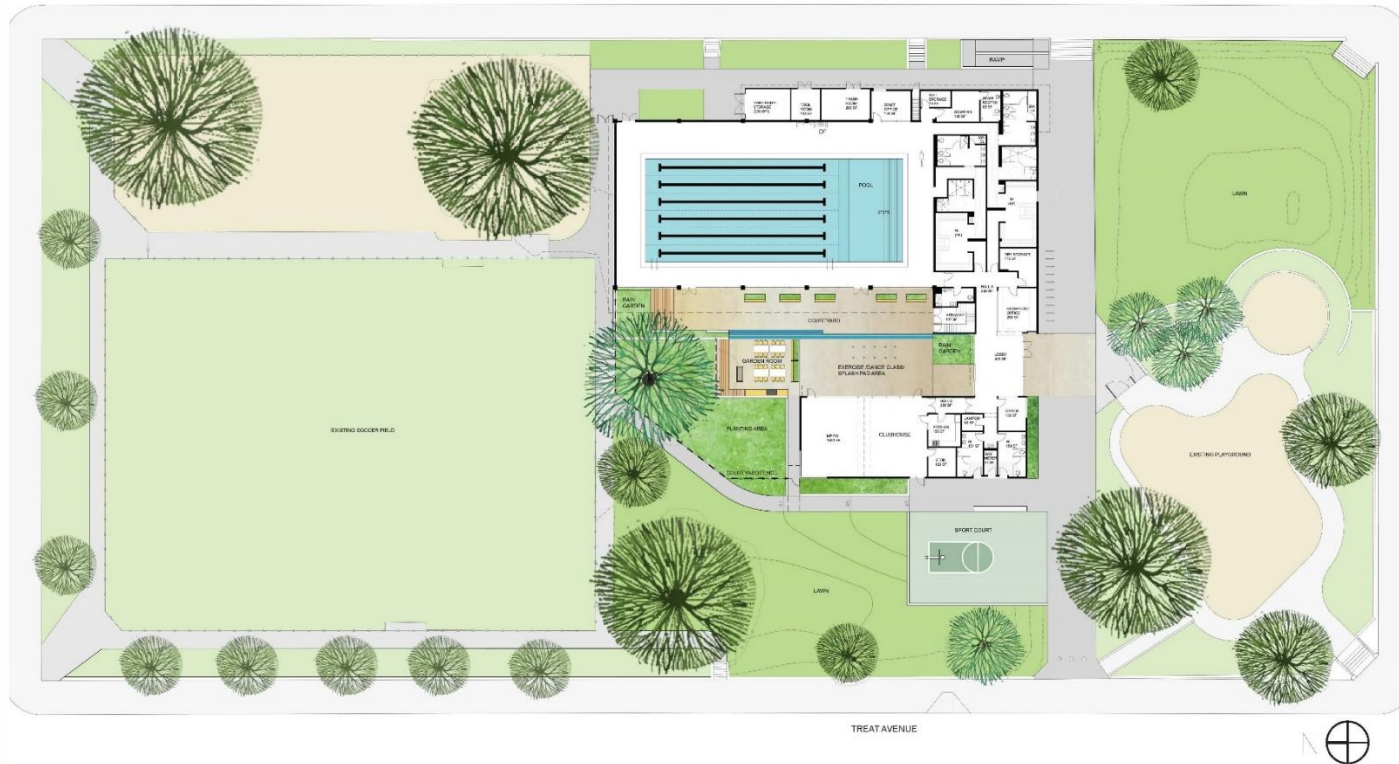

**IPIC Funding:**  
\$5,538,000

**Total Project Budget:**  
\$18,138,000

**Gap in Funding:**  
\$1,600,000

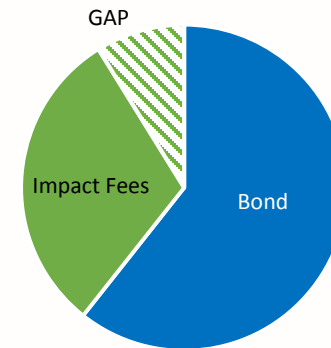





Existing lights to be evaluated and replaced



SAN FRANCISCO  
PUBLIC  
WORKS

## Project Scope and Limits

Building Design & Construction

RPD | Potrero Hill Recreation Center: Field Improvements  
Community Meeting (3) | June 16, 2016



10

**IPIC Funding:**  
\$ 180,000

**Total Project Budget:**  
\$ 4,200,000

**Gap in Funding:**  
\$ 900,000

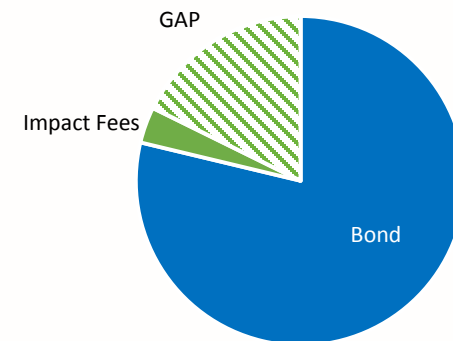





**IPIC Funding:**  
\$825,000

**Bond Funding:**  
\$324,000

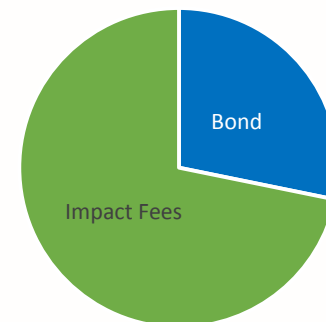





## SCHEMATIC DESIGN

3.14.17 R



SCHEMATIC LANDSCAPE DESIGN PLAN

FLETCHER STUDIO

GREEN BENEFIT DISTRICT  
DESIGN REVIEW



**Requested IPIC Funding:**  
\$2,700,000

**UCSF Donation:**  
\$5,000,000



San Francisco Recreation and Park Department



Central Waterfront



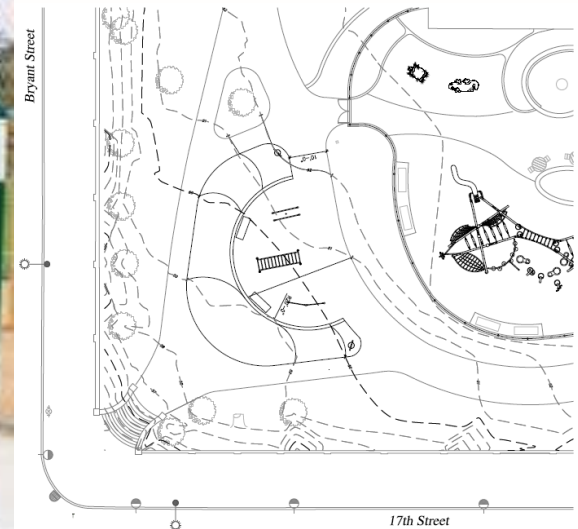

**IPIC Funding:**  
\$120,000

**Total Project Budget:**  
\$235,000

**Gap in Funding:**  
\$90,000

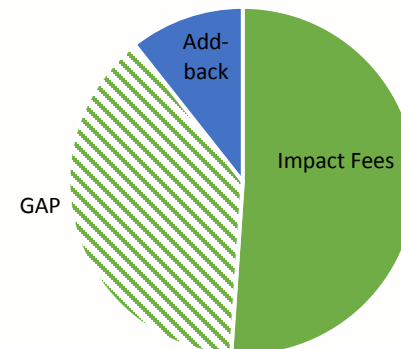





**IPIC Funding:**  
\$ 1,869,000







PROPOSED SITE PLAN



ENCAC MEETING  
MAY 15, 2017

PUBLIC OPEN SPACE - 900% INCREASE  
PLAYGROUND AREA - 175% INCREASE  
COMMUNITY GARDENS - 250% INCREASE  
NEW DOG RUN  
NEW PUBLIC PLAZAS



FLETCHER STUDIO LANDSCAPE ARCHITECTURE  
Jackson Liles ARCHITECTURE  
Danks Alliance  
VERDE DESIGN

**IPIC Funding:**  
\$ 1,640,000

**FOJP/developer fundraising:**  
\$4,420,000



## Gene Friend Recreation Center



CONCEPTUAL DESIGN **FIRST FLOOR PLAN** [SCHEME 1]

WRNSSTUDIO



**IPIC Funding:**    **TPL in-kind services:**  
\$ 1,800,300    \$ 500,000



San Francisco Recreation and Park Department



*East SoMa*



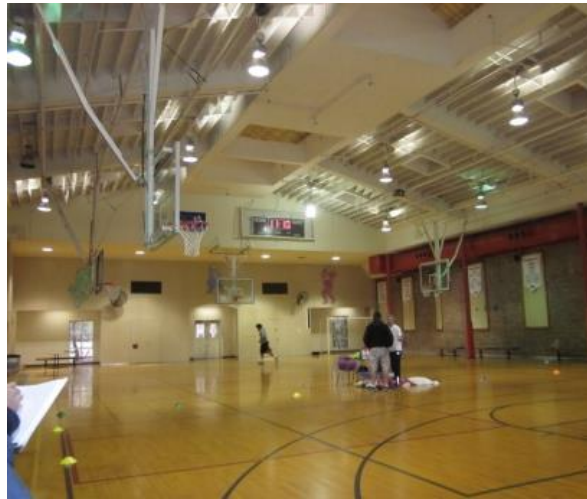

**IPIC Funding:**  
\$3,740,000





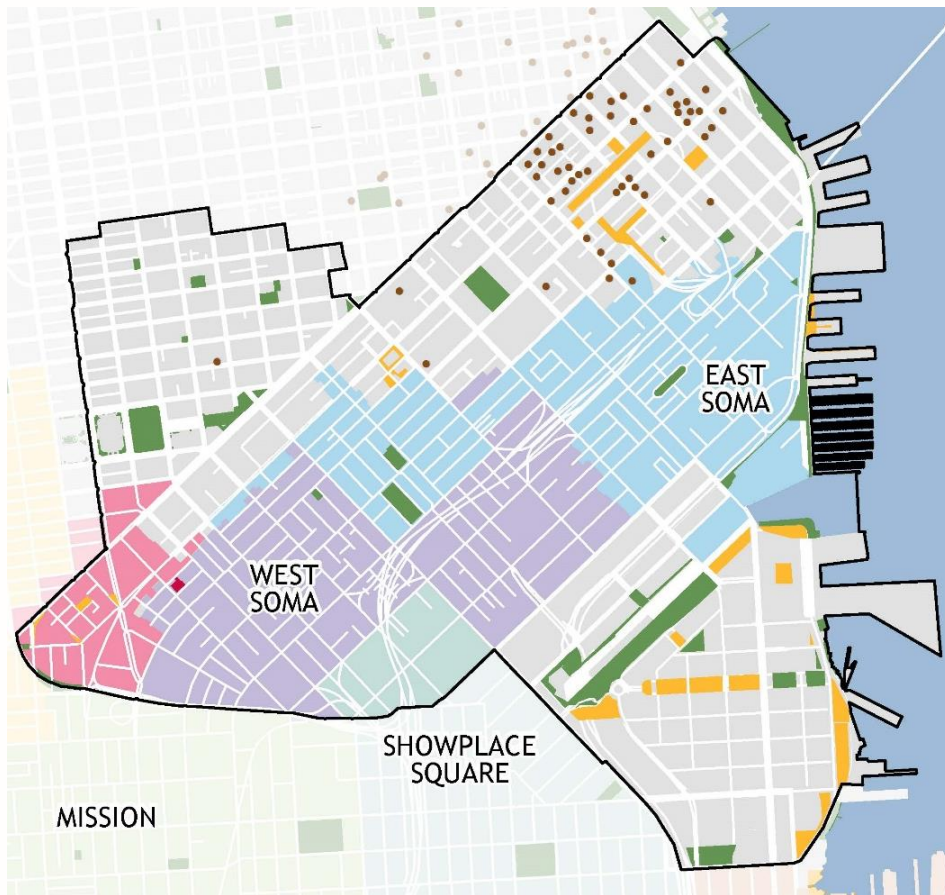

**IPIC Requested:**  
\$8,810,000

**Open Space Acquisition Funding:**  
\$9,725,000



## Open Space

Existing

Proposed

Existing POPOs

## Plan Areas

East SoMa

West SoMa

The Hub





# Bond Planning and Implementation with Eastern Neighborhoods Impact Fees

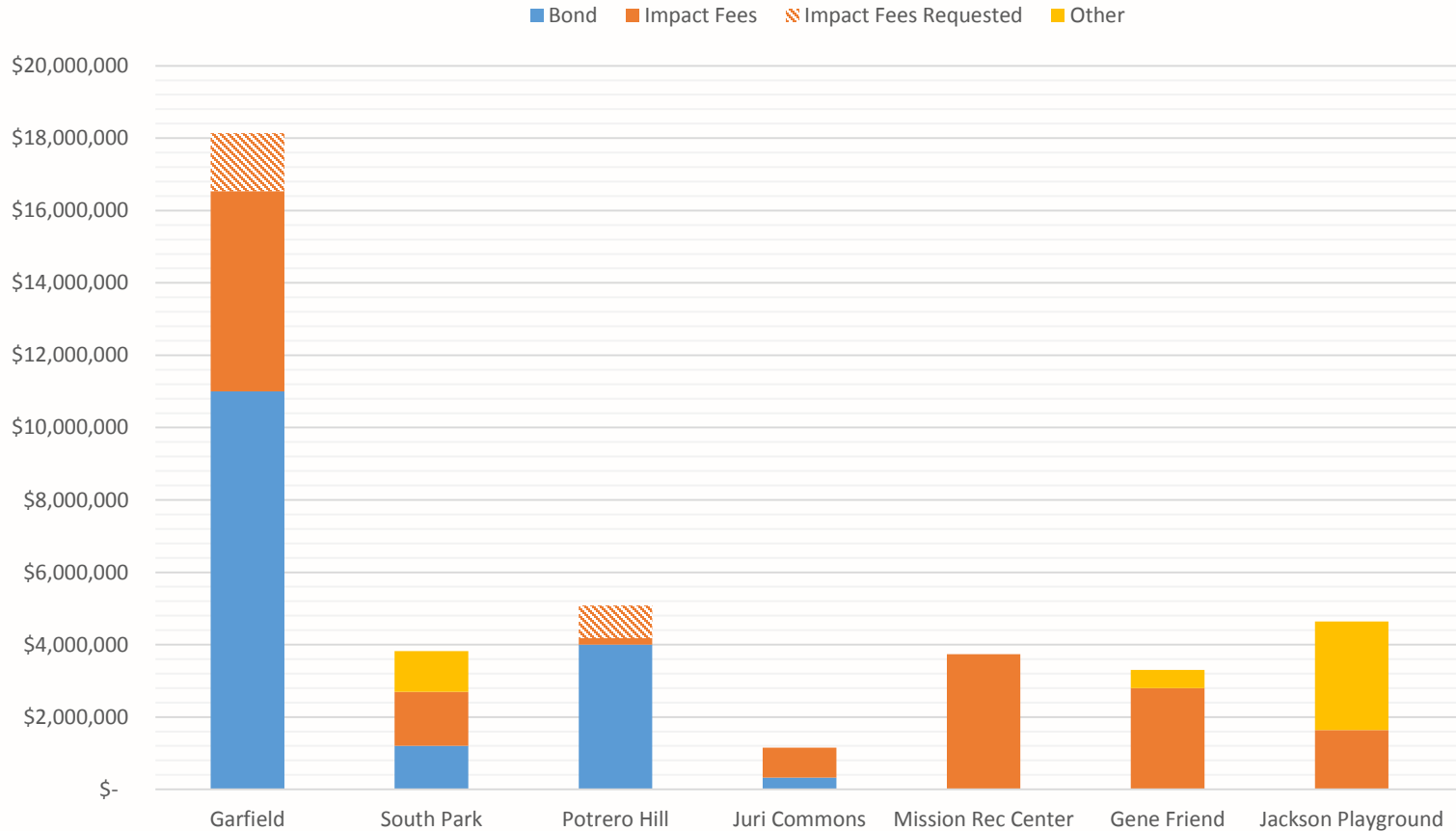



## Bond Planning & Implementation With IPIC Expenditure Plan

	FY 2018	FY 2019	FY 2020	FY 2021	FY 2022	FY 2023
<b>2012 Bond Implementation</b>						
<b>2019 Bond Planning</b>						
<b>2019 Bond @ Board &amp; to Electorate, 1<sup>st</sup> Bond Sale</b>						
<b>2019 Bond Implementation</b>						

<b>EXPENDITURE PLAN for IPIC funds</b>	FY 2018	FY 2019	FY 2020	FY 2021	FY 2022	FY 2023
Central Waterfront Recreation and Open Space: Esprit Park		2,700,000				
New Parks in South of Market : 11 <sup>th</sup> & Natoma Park Development		8,810,000				
Garfield Center		1,600,000				
Franklin Square		90,000				
Potrero Rec Center		900,000				
Bond Planning & Implementation				6,000,000	3,000,000	3,000,000

