

San Francisco Recreation & Parks Department Eastern Neighborhoods CAC RPD Update *December 4, 2023*

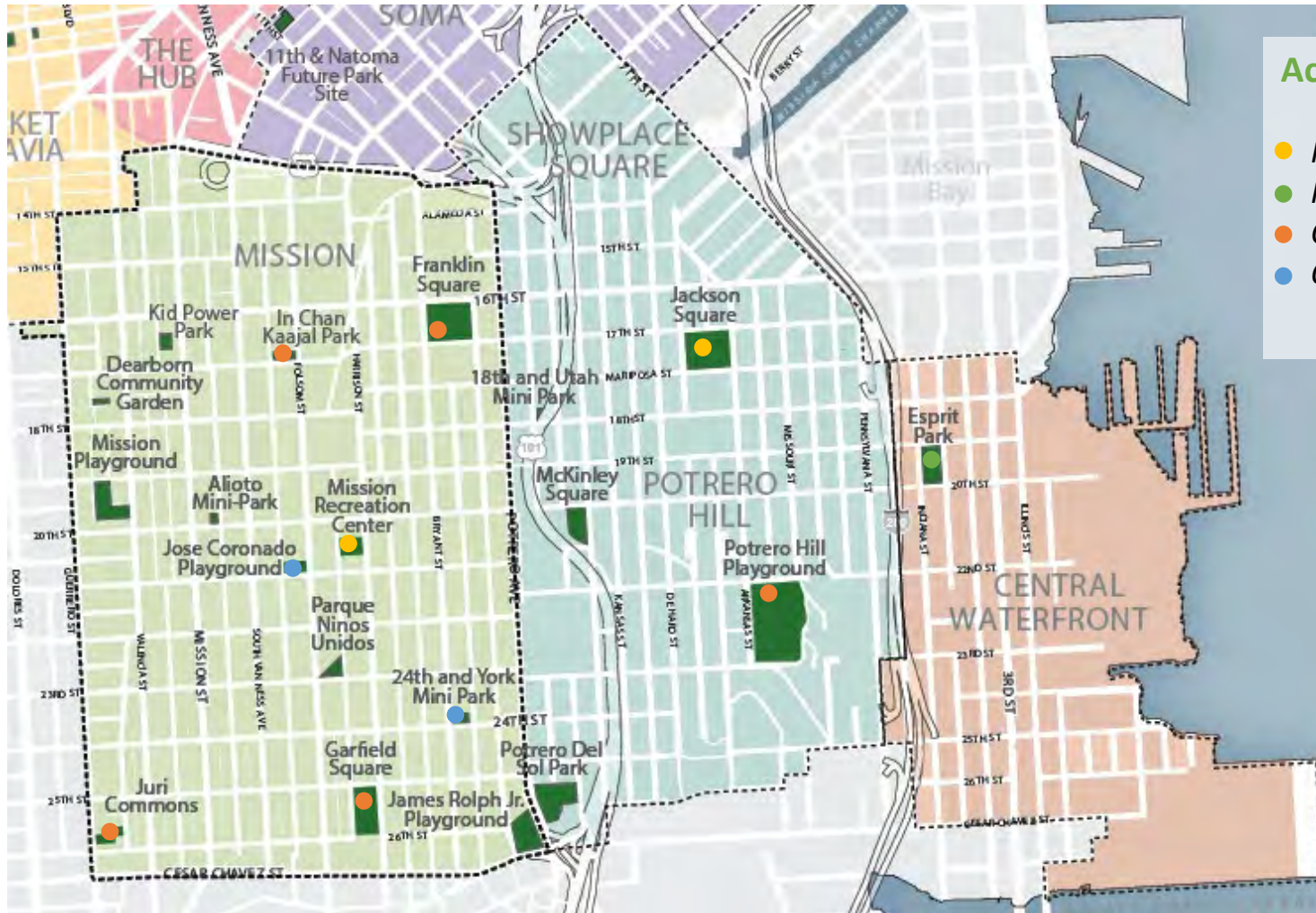

Inspire, Connect, Play!

Eastern Neighborhoods Parks



Active & Recent Projects

- *Projects in Planning*
- *Projects in Construction*
- *Completed Projects*
- *Operations Projects*



Projects in Construction





Project Elements

- Improving site amenities and pathways
- Clarifying functional use areas
- Refining park circulation
- Updating adult exercise equipment
- Renewing landscape, including trees, plantings and meadow

Total Project Budget	\$8,500,000
UCSF Grant (cash)	\$4,200,000
UCSF Grant Managed by GBD (in kind)	\$800,000
Impact Fees	\$3,500,000

Existing



Proposed



Construction Progress

- NTP / Construction Start January 19, 2023
- Irrigation system installation nearly complete
- Domestic water line installation complete
- Storm drainage system nearly complete
- Concrete seat walls poured
- Granite seat walls nearly complete
- Boardwalk decking piers and joists in place
- Adult exercise equipment fabricated and delivered
- Trees selected
- Substantial completion and park re-opening expected by Spring 2024



Tree Protection and Monitoring



Tree Protection Zones



Watering (sprinkler)



Watering (truck)



Root Protection for Trenches



Regular Field Coordination



Additional Protection Measures



Field Verification



Community Engagement

- General project and contact information posted on site
- Monthly updates to the project page of the Rec and Park website (bit.ly/espritproject)
- Emails to core stakeholder groups
- Physical posting on site for tree removals
- Timely response to inquiries from members of the public

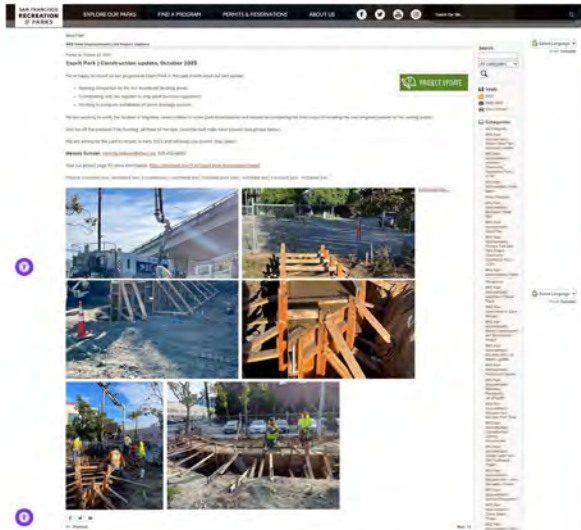

Attention!
Construction Advisory: November 2023

**Esprit Park Renovation:
Tree Removal and Replacement**

During our ongoing monitoring efforts, we discovered that a tree that we were attempting to preserve in place during construction was in decline. The tree is located adjacent to 20th Street and is in the immediate vicinity of the planned large plaza and picnic area in the renovated park. Based on the tree's status and in consultation with and recommendation from our arborist, Rec and Park has decided to remove and replace this tree. The new tree species will match the new trees being planted in that vicinity to replace the program that our consulting arborist suspects were poisoned.

This tree was in fair condition prior to construction and was flagged as having only medium suitability for preservation, with the following note: Top setback and one-side branching to south. Suggested by adjacent posters. In the 2021 assessment, the following additional notes were added by the consulting arborist: Wind burn. Crown thin at top. The arborist recommended "retain and prune to reduce height and branch weights." As part of the current construction contract, the prescribed pruning was completed, with oversight from our consulting arborist. The tree was ranked as 7 or 8 out of 12 for risk rating with 12 being the highest possible risk. For reference, Rec and Park places trees with risk rating of 9 and above, where resources allow.

Of note is that this is the exception, not the norm. We have been regularly monitoring the trees retained on site. Many other similar trees show leaf construction activities in the immediate vicinity, and they are not to decline.

The tree that is pictured will be removed on or after November 23, 2023 and will be replaced when the rest of the park's planting effort commences in the coming weeks.

For questions, or to be added to our email list for project dates, please contact the project manager: [Melinda Sullivan_parks@sfgov.org](mailto:Melinda.Sullivan_parks@sfgov.org), 510-463-8046.

LEARN MORE: Visit the project webpage at: bit.ly/espritproject



DOGPATCH / *Esprit Park* (bit.ly/espritproject)



Projects in Planning and Design



POTRERO / Jackson Playground



Improvements may include:

- Reconfigure existing field design to be more functional
- Create passive open spaces
- New CPA & outdoor courts
- Relocate and renovate historic clubhouse
- Refine site circulation

Total Project Budget	\$40,072,000
<i>Private funding received to date</i>	\$2,798,000
Private funding - FoJP Fundraising	\$9,643,000
Public Funding - FoJP-advocated ENCAC Impact Fees	\$4,600,000
Public Funding - Development Impact Fees - ENCAC	\$8,000,000
Public Funding - General Fund	\$5,024,000
Public Funding - Open Space Fund	\$7,000
Public Funding - 2020 Health & Recovery Bond	\$10,000,000



POTRERO / Jackson Playground



MISSION / Mission Recreation & Art Centers



Improvements may include:

- Seismic, structural and feasibility analysis to identify potential improvements

Recently completed improvements in the courtyard:

- Installed new stairs
- Painted metal structures

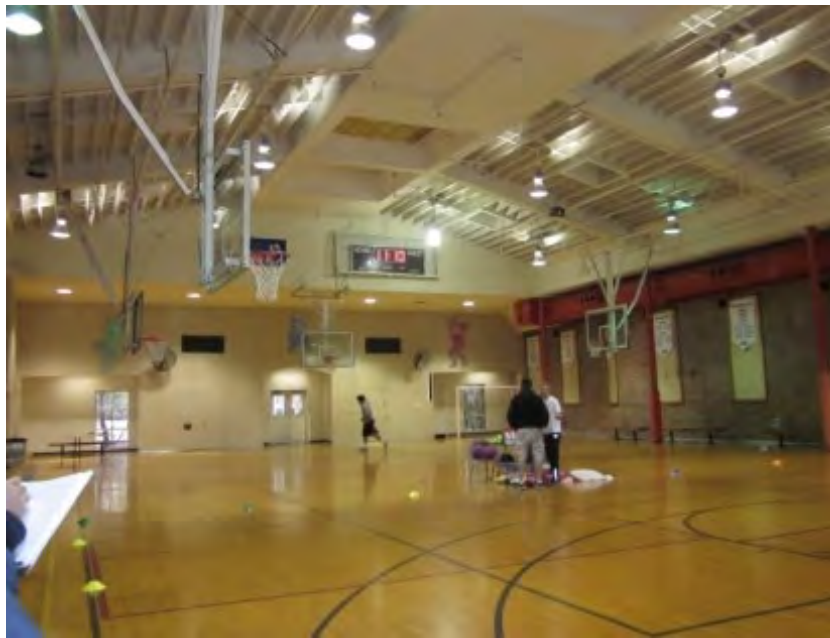

Planning
Underway

Design
TBD

Bid/Award
TBD

Construction
TBD

Opening
TBD



Completed Projects





Improvements Include:

- New playground
- Improved accessible circulation
- New adult exercise equipment
- Landscaping & multi-use lawn
- Varied seating options
- Adding reference to historic railroad

Total Project Budget	\$1,925,000
Impact Fees	\$1,000,000
2012 Bond (COF + LPSF!)	\$850,000
SFPA Grant	\$75,000

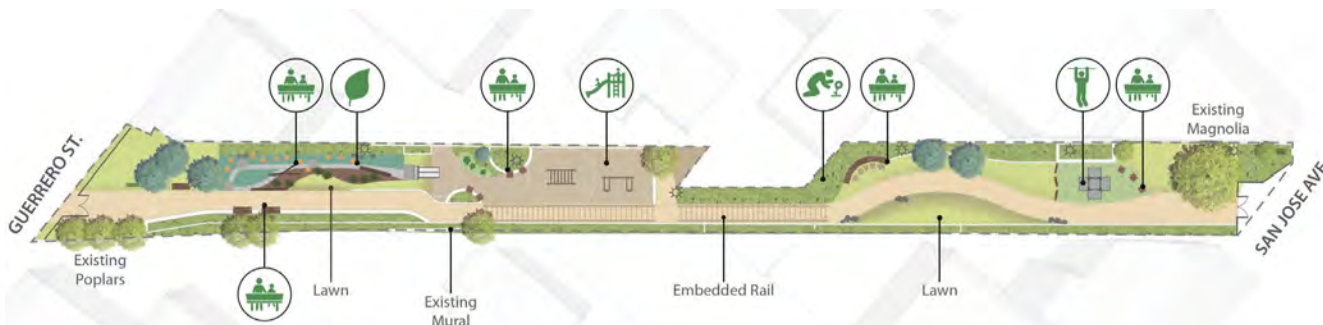



Improvements Include:

- 40% additional capacity
- New shallow space for kids
- 50% more space in multi-purpose room
- New courtyard for additional programming
- New murals + refurbishing existing

Total Project Budget	\$20,064,000
GO Bond	\$11,000,000
Impact Fees	\$8,738,000
Open Space	\$326,000





Improvements Include:

- Replace the synthetic turf playfields
- Funding through the General Fund

Total Project Budget	\$210,000
General Fund	\$210,000





Improvements Include:

- ADA Accessibility
- Concrete seat wall to delineate edge of equipment
- Additional lighting
- Parcourse equipment
- Replacement of pathway along Bryant St.

Total Project Budget	\$235,000
Impact Fees	\$210,000
Addback	\$25,000





Improvements Include:

- Improvements to the natural turf playfields and lower-level dog play area
- Lighting upgrades at on-site pathway for the Walking School Bus Route

Total Project Budget	\$5,530,000
GO Bond	\$4,000,000
Impact Fees	\$1,330,000
General Fund	\$200,000





Total Project Budget	\$7,818,000
Impact Fees	\$3,160,000





Thank You

