

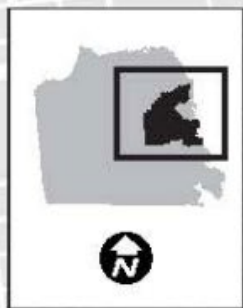

**South of Market  
Citizen's Advisory Committee  
September 2021 Meeting**



Market  
Octavia

Western SoMa

Showplace  
Square

East  
Soma

Mission  
Bay

## Construction

- 6th Street Pedestrian Improvement Project
- Safer Taylor Improvements Project
- Harrison Streetscape Improvement Project

# 6<sup>th</sup> Street Pedestrian Safety Project

**Project Description:** This project is a Vision Zero priority project that includes sidewalk widening, roadway, bulbouts, sub-sidewalk basement work, abatement, street lighting, traffic signal, OCS, landscaping.



**Project Status:** NTP Anticipated Fall 2021

**IPIC Funds:** N/A    **Total Cost:** \$10.1M



# Safer Taylor Project

**Project Description:** This project is a Vision Zero priority project that includes roadway, sidewalk widening, protected cycle tracks, transit islands, traffic signals, street lighting, water work, landscaping and site furniture.



**Project Status:** NTP Pending

**IPIC Funds:** NA    **Total Cost:** \$9M



# Harrison Street Infrastructure Improvement Project

**Project Description:** This project is a Vision Zero priority project that includes roadway, sidewalk widening, protected cycle tracks, transit islands, traffic signals, street lighting, water work, landscaping and site furniture.

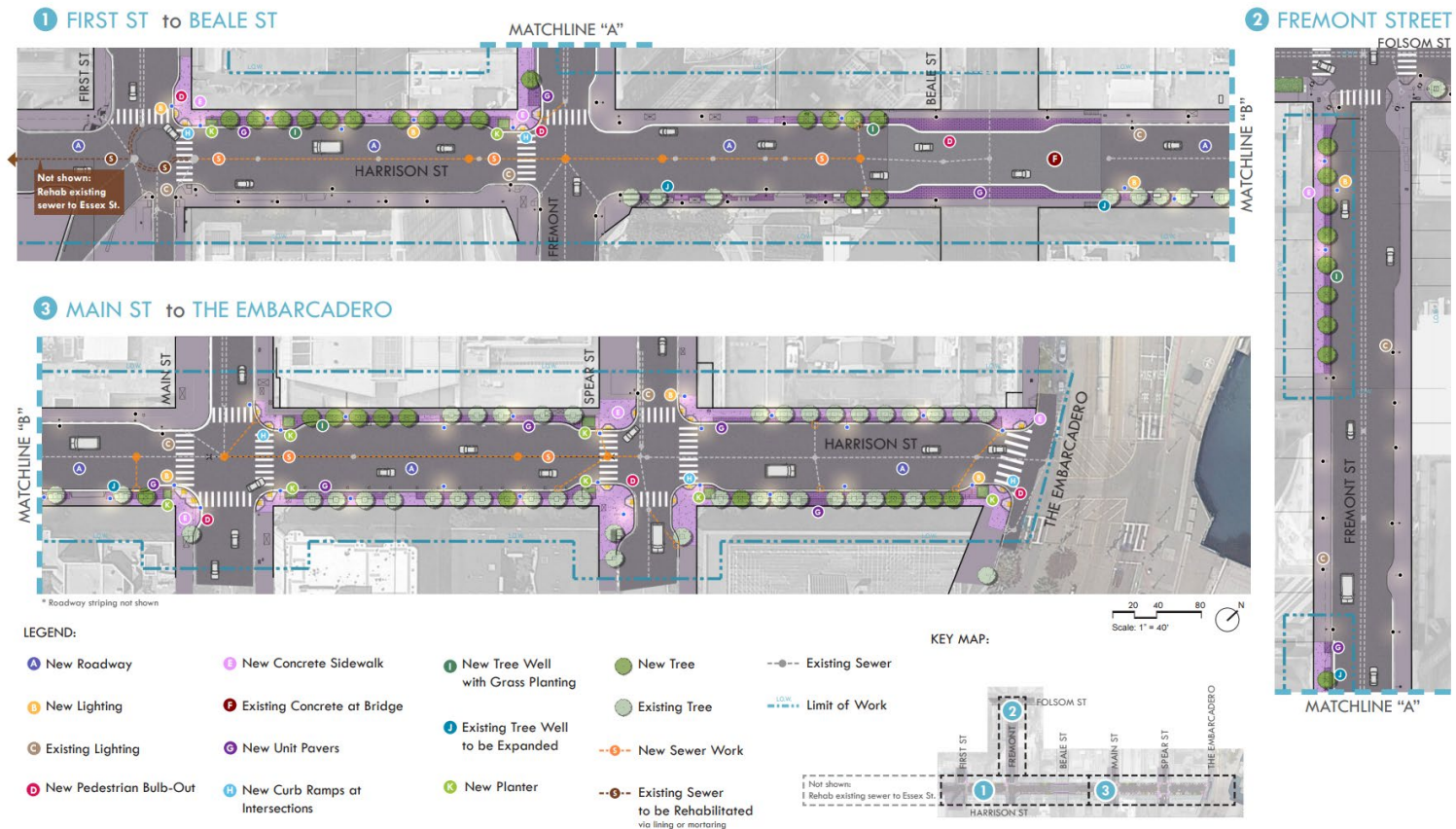

**Project Status: NTP 7/6/2021**

**IPIC Funds: \$7.5 million    Total Cost: \$9.3M**

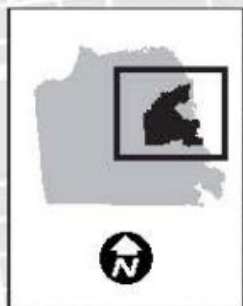

Market  
Octavia

Western SoMa

Showplace  
Square

East  
Soma

Mission  
Bay

## Design

- Folsom Streetscape Improvements Project
- 5th Street Quick Build / Long-Term Project



# Folsom Street Improvement Project

**Project Description:** This Vision Zero project will include sidewalk widening, bike lanes, transit boarding islands, traffic signal and street light upgrades, roadway improvements, curb ramp improvements, decorative crosswalks, public realm improvements, landscaping and site furniture.



**Project Status:** 100% design anticipated Spring 2022

**IPIC Funds:** \$13.1M    **Total Cost:** \$34.4M

# 5<sup>th</sup> Street Quick Build / Long-Term Project

**Project Description:** The 5<sup>th</sup> Street project includes upgrade bicycle facilities, transit stop improvements, curb ramp upgrades and pedestrian safety treatments.

## 5TH STREET IMPROVEMENT PROJECT: Quick-Build Improvements - Draft

5th Street from Market to Shipley streets



5th Street from Clara to Townsend streets



**Project Status:** 100% Design Winter 2021

**IPIC Funds:** NA    **Total Cost:** \$1.8M



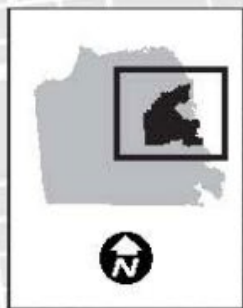

Market  
Octavia

Western SoMa

Showplace  
Square

East  
Soma

Mission  
Bay

## Construction Completed / Long-Term Plant Establishment

- Transbay Folsom Streetscape Project
- 2<sup>nd</sup> Street Infrastructure Improvement Project

# 2<sup>nd</sup> Street Improvements Project

**Project Description:** The 2<sup>nd</sup> Street Improvement project is intended to transform the 2<sup>nd</sup> Street corridor in the east South of Market (SoMa) neighborhood into a pedestrian- and bicycle-friendly complete street, consistent with the vision identified by the community in the East SoMa Area Plan.

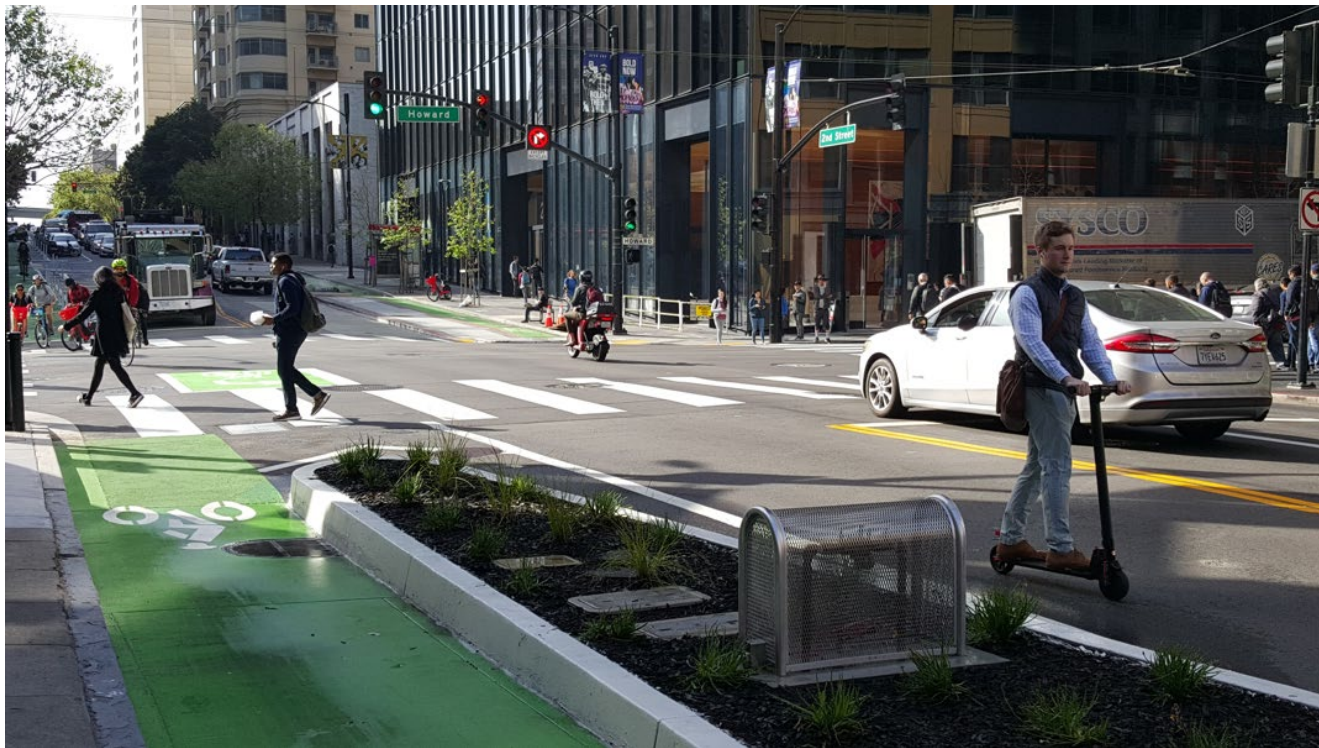

**Project Status:** Substantial Completion reached in October 2020; LTPE ongoing

**IPIC Funds:** \$10.8 million    **Total Cost:** \$39.8M







# Transbay Folsom Streetscape Project

**Project Description:** This is a Complete Streets project that includes roadway, sidewalk widening, protected cycle tracks, transit islands, traffic signals, street lighting, water work, rain gardens, landscaping



**Project Status:** Substantial Completion Reached in February 2021; LTPE ongoing  
**IPIC Funds:** N/A    **Total Cost:** \$16.4M



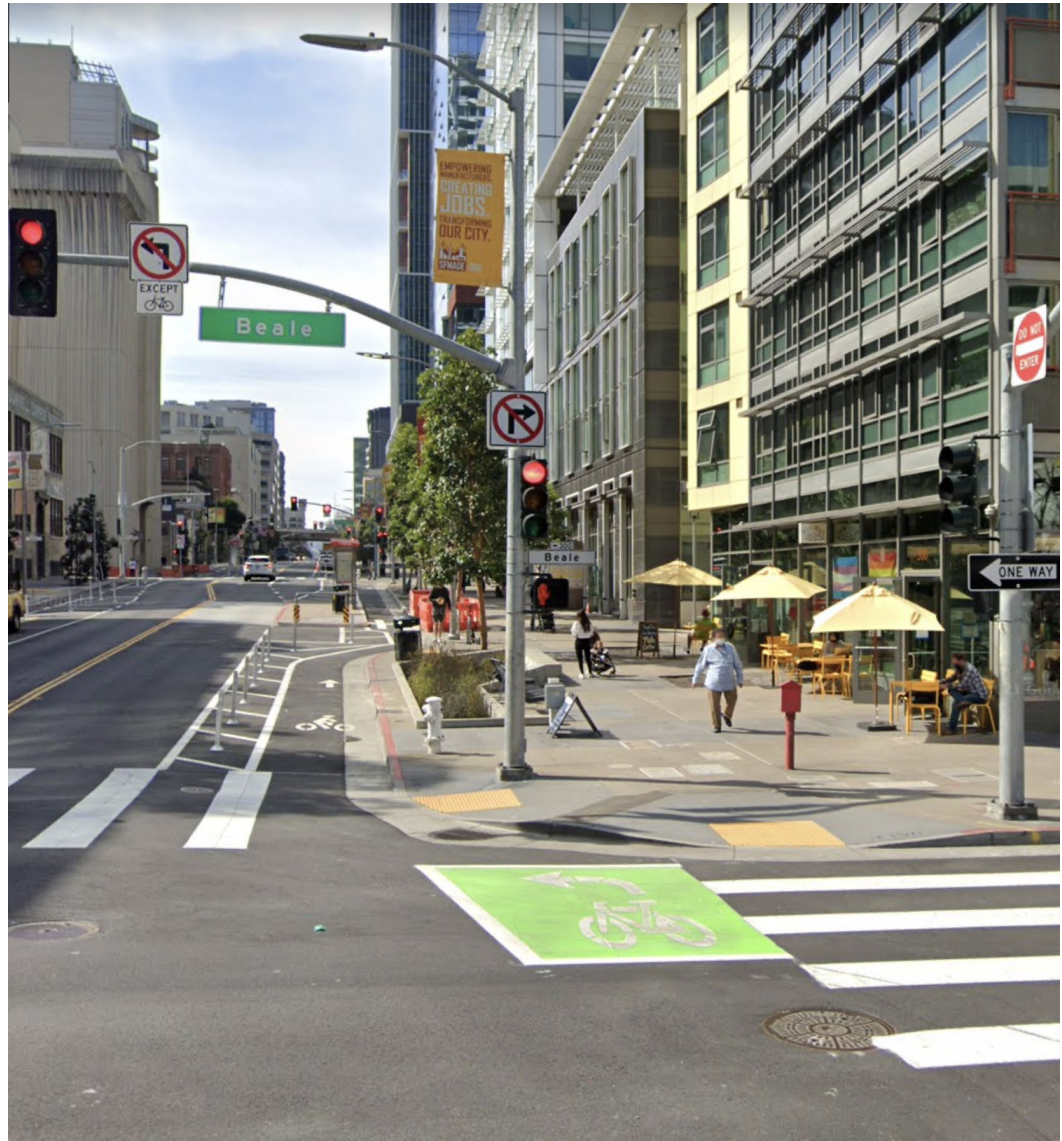











# CENTRAL SOMA

PLAN & IMPLEMENTATION STRATEGY

FINAL PLAN  
ADOPTED DECEMBER 2018

Figure 2  
PROPOSED AMENITY SUMMARY

This table summarizes the information contained in the following pages.

																	
STREET																	
2nd	X	X	X			X	X			X	X	X					
3rd		X	X	X			X	X			X						
4th		X	X	X			X				X						
5th		X			X		X	X	X		X						
6th	X	X			X		X				X						
Howard		X				X	X	X	X		X	X					
Folsom	X	X	X	X		X	X	X		X	X	X					
Harrison	X	X					X		X		X		X				
Bryant									X		X		X				
Brannan	X	X		X		X	X	X	X			X					
Townsend		X	X			X	X					X					
	SIDEWALK WIDENING				PEDESTRIAN IMPROVEMENTS		TRANSIT IMPROVEMENTS	TRANSIT-ONLY LANES	CONVENTIONAL BIKE LANES	PROTECTED BIKE LANES	CURB SPACE DEMAND MGMT	GREEN INFRASTRUCTURE	ENHANCED STREET TREES	SF GREEN CONNECTION	LED STREETLIGHTS (SFPUC)	LED STREETLIGHTS (CSP)	EV-CHARGING STATIONS



# **South of Market Street Tree Nursery Facility & Operations Concept**

SAN FRANCISCO PUBLIC WORKS  
BUREAU OF URBAN FORESTRY

September 2021





# STREET TREE NURSERY CONCEPT DESIGN



BUREAU OF URBAN FORESTRY  
+ LANDSCAPE ARCHITECTURE

*December 2020*





# Policy History



2014

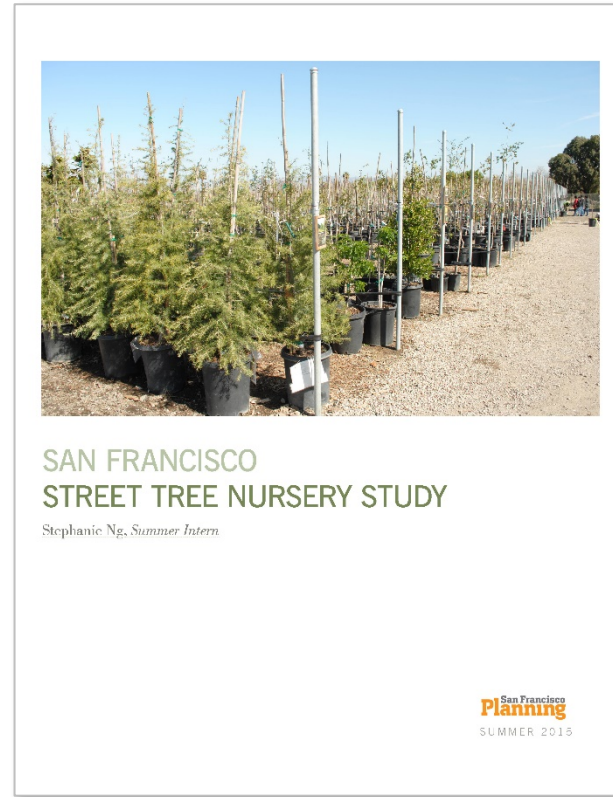

2015

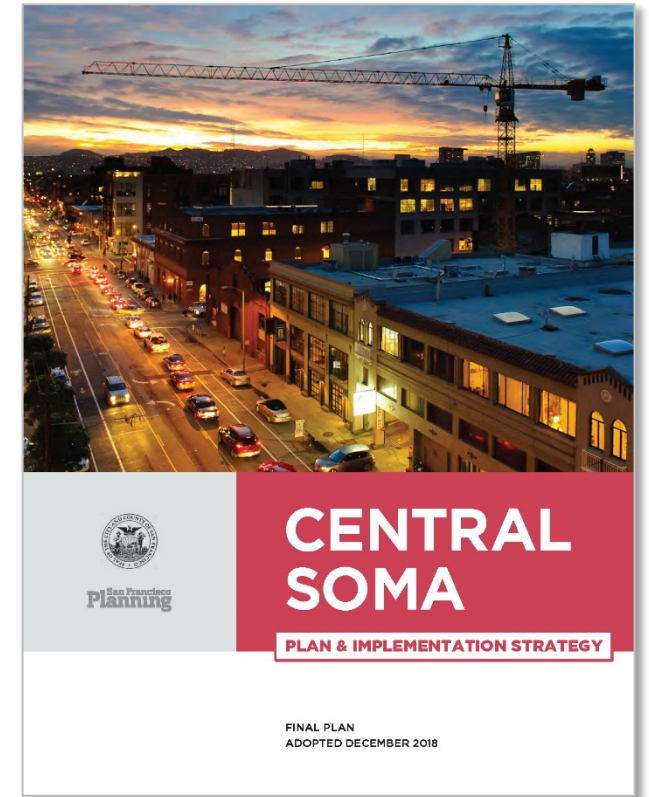

2018



# CURRENT VIEW 1: BIRD'S EYE LOOKING EAST





# BUF NURSERY CONCEPT DIAGRAM

- fenced behind plaza
- 12,500 ft<sup>2</sup> total nursery area
- 15' gravel driveway
- 2 vehicle entries at wings
- partnership opportunities

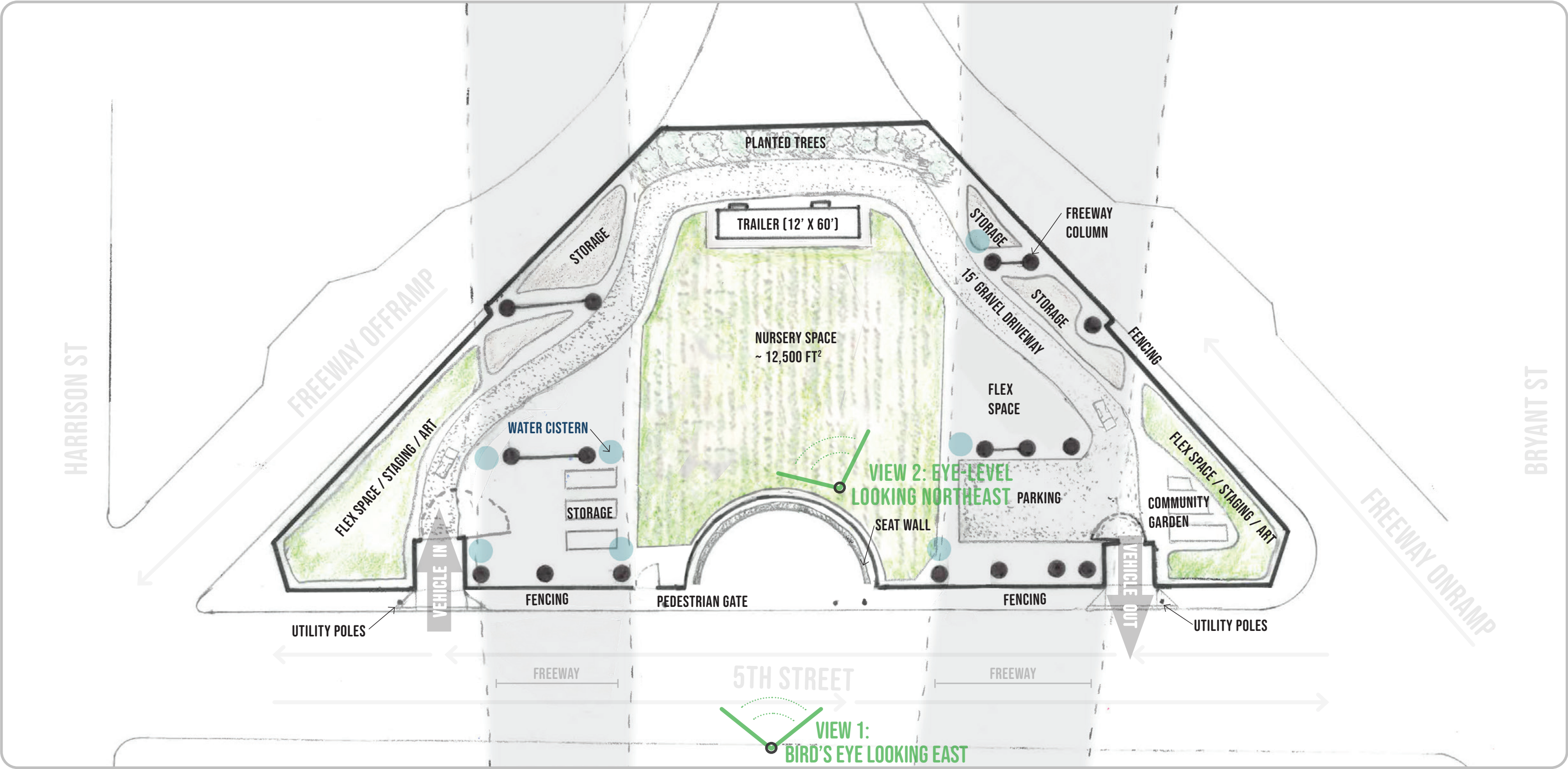

STREET TREE NURSERY CONCEPT DESIGN UPDATE  
BUREAU OF URBAN FORESTRY +  
BUREAU OF LANDSCAPE ARCHITECTURE

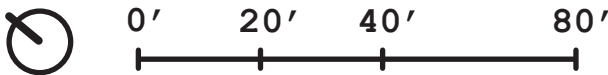



# CURRENT VIEW 1: BIRD'S EYE LOOKING EAST





# VIEW 1: BIRD'S EYE LOOKING EAST





# VIEW 2: EYE-LEVEL LOOKING NORTHEAST





# Operations Concept

*Stage street trees for future plantings*



*Grow trees uncommon in nursery trade and that are acclimated to San Francisco's unique climate*



*Create green jobs, workforce training and educational opportunities*





# Facility Needs



**Fencing**



**Storage Container**



**Portable toilets**



**Lighting**



**Signage**



**Materials Storage**



**Irrigation**



**Security**





**Art & Placemaking**





# Street Tree Planting Needs







## Preserve and Grow

# Urban Tree Canopy



## Advance

# Racial & Social Equity

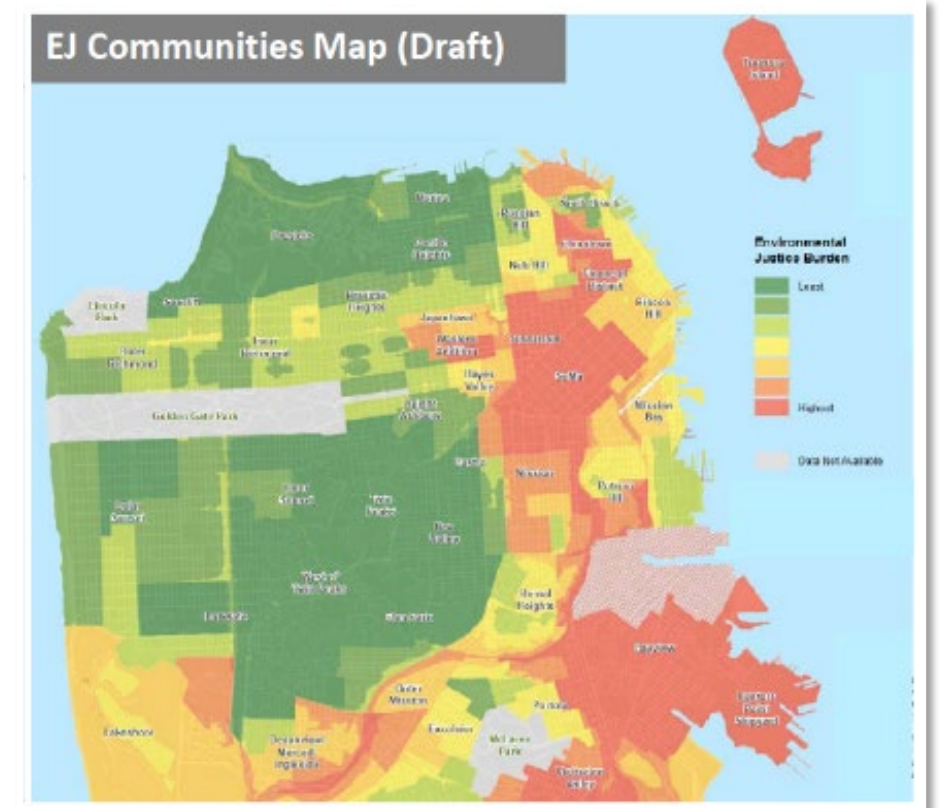

Promote

# Climate Resilience & Adaptation



# Urban Tree Canopy by Neighborhood

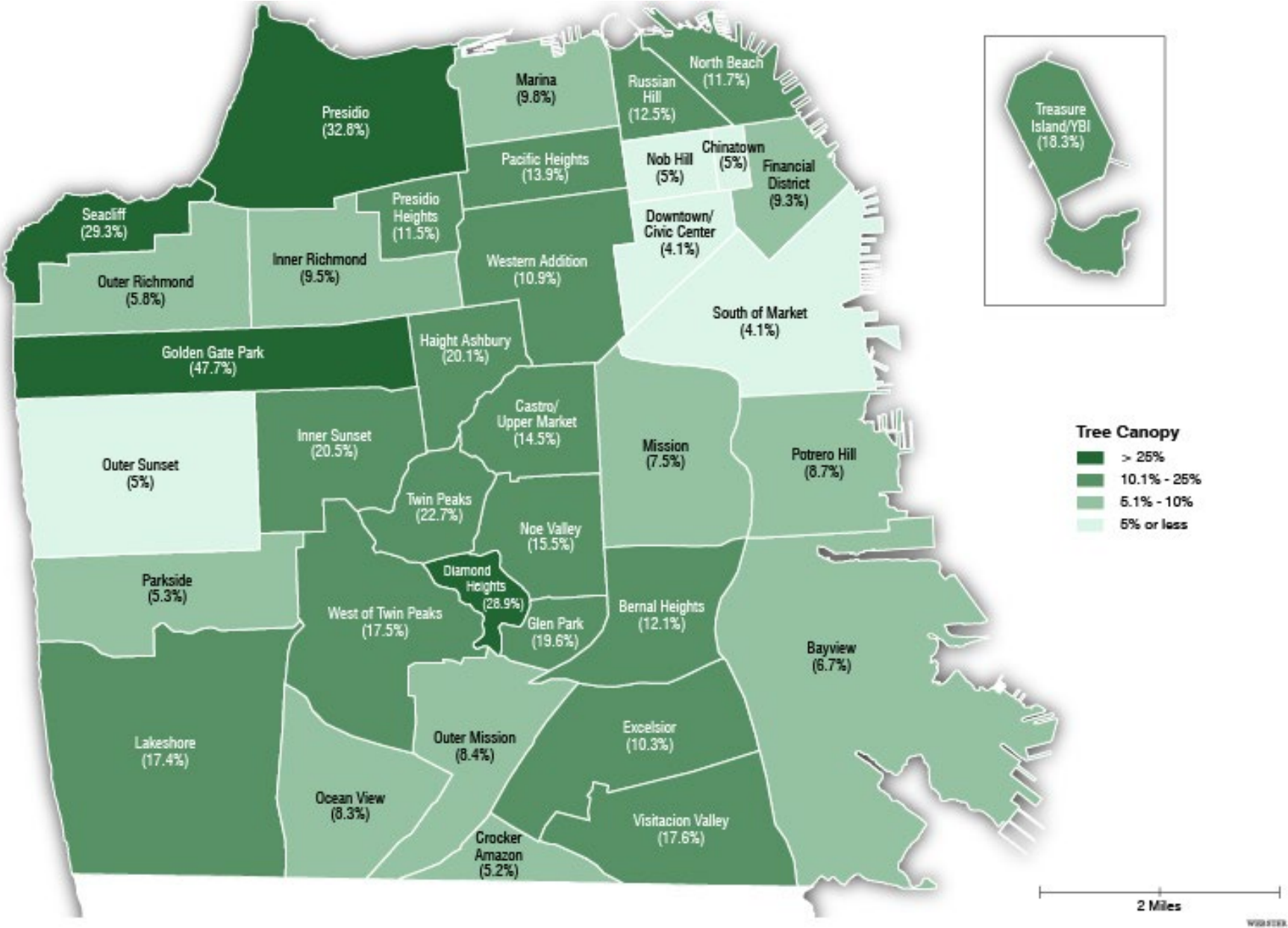

**SOMA:**  
**4.1%**



# Street Trees Per Street Mile

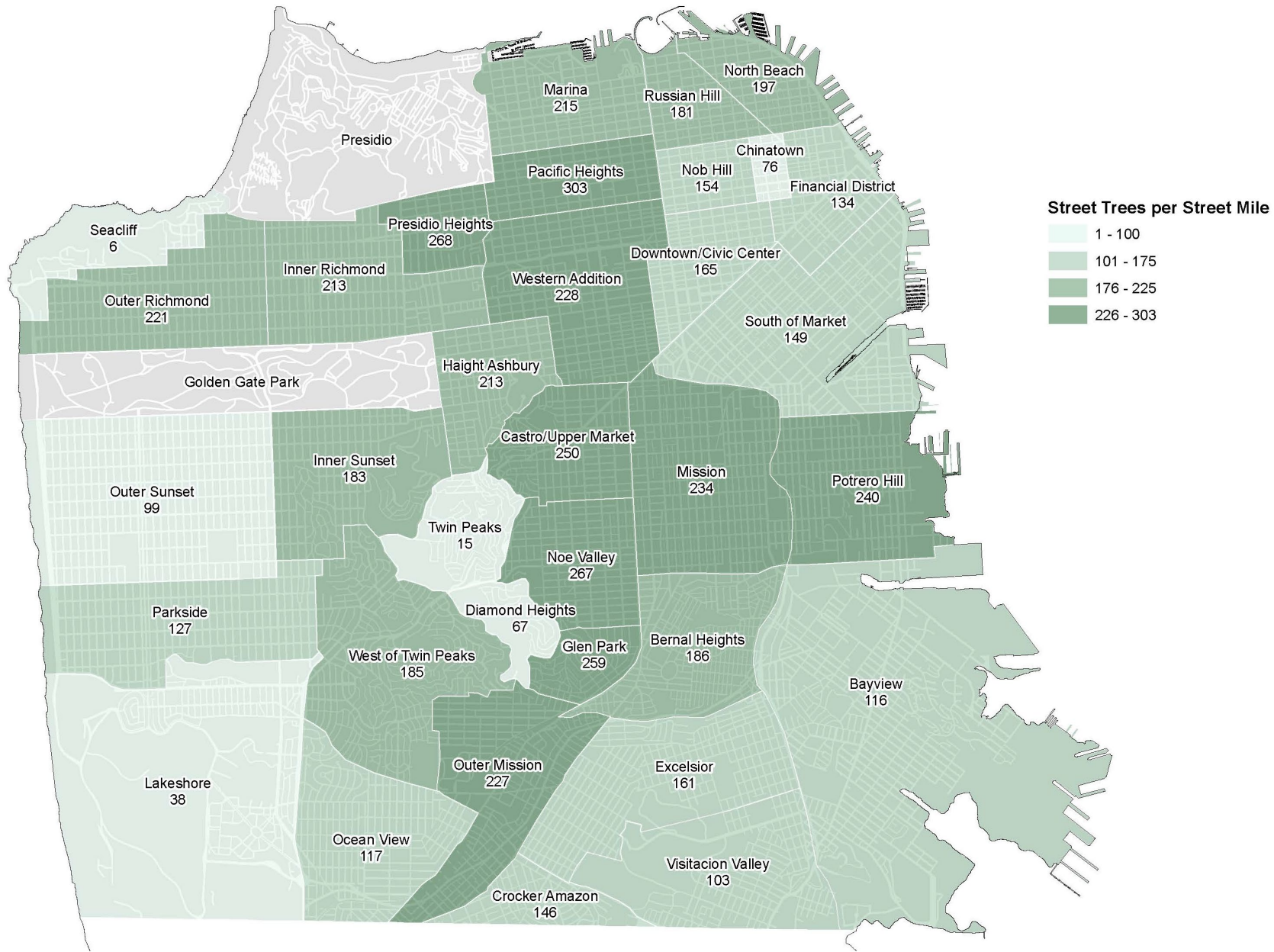

# SOMA:

149

street trees per  
treet mile



# Environmental Justice Communities (SF Planning)

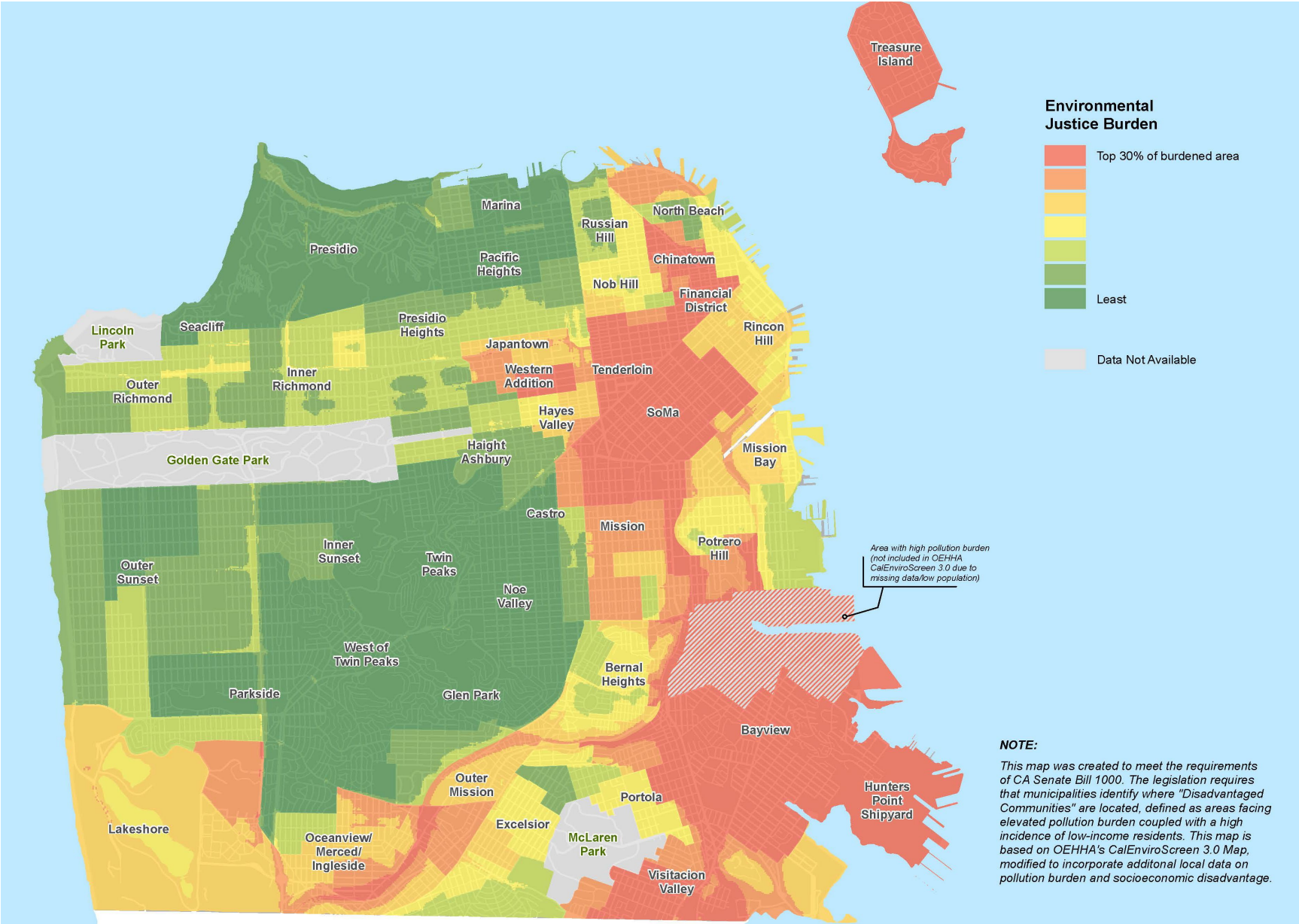



# Environmental Justice Communities (SF Planning)

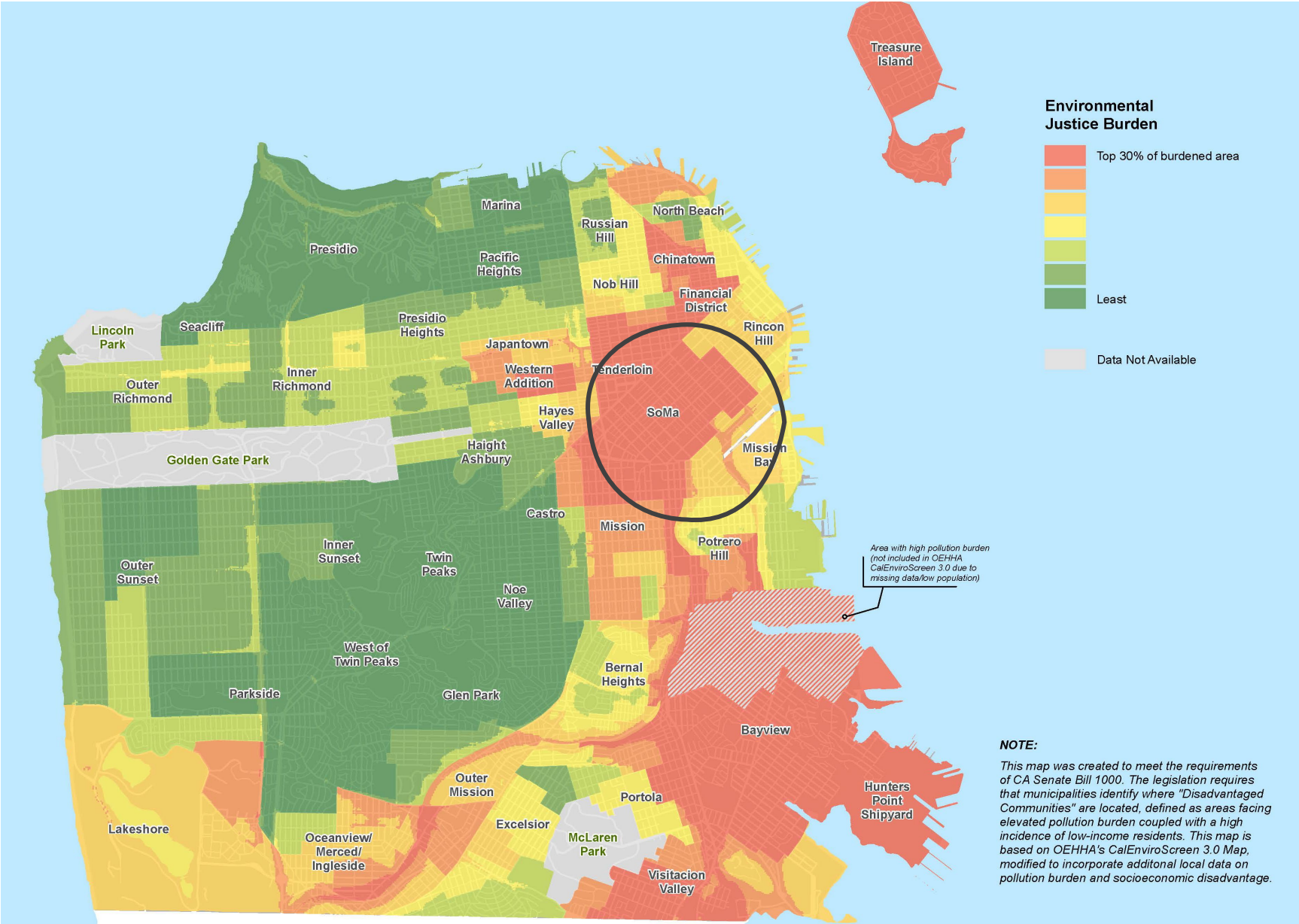



# Questions?