

September 9, 2020

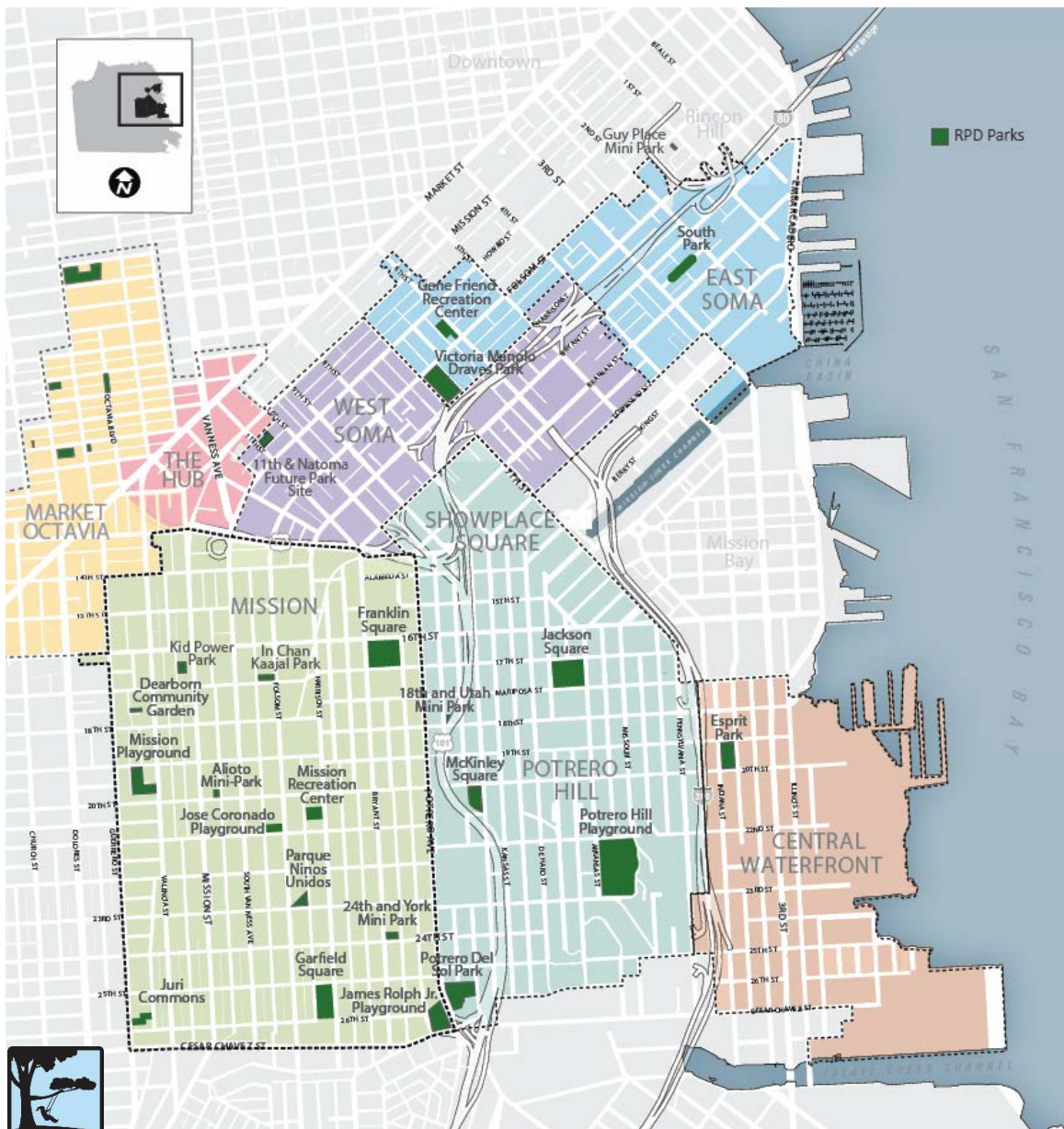

# Inspire, Connect, Play!



## Active & Recent Projects

### SoMa & East Cut

#### Recently Opened

- Guy Place Mini Park

#### In Process

- Victoria Manalo Draves Park

#### Projects in Planning

- Gene Friend Rec Center
- 11<sup>th</sup> & Natoma
- 88 Bluxome
- 1133 Mission/633 Minna
- Under-freeway Parcels

#### Completed Projects

- South Park



# *Recently Opened Projects*

---







### Improvements Include:

- 3 outdoor “rooms”
- Artist-designed fence
- Pet fountain and permeable dog relief area

Total Project Budget	\$5,300,000
Impact Fees	\$5,240,000
Addback	\$60,000

Existing Conditions



Construction



Planning  
February 2014

Design  
January 2015

Bid/Award  
December 2017

Construction  
August 2018

Opening  
July 2020





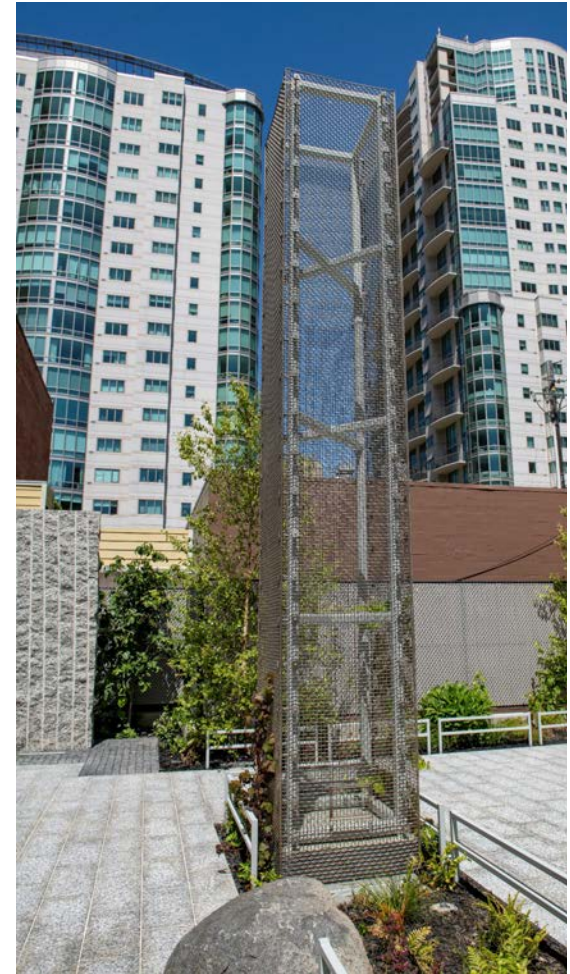

# *Projects in Progress*

---







### Improvements Include:

- Lighting upgrades to the ballfield, basketball court and pathways
- Additional seating and improved site circulation
- Expansion of the community garden with added planters

Total Project Budget	\$2,600,000
Impact Fees (Intercontinental)	\$2,600,000



Planning  
July 2018

Design  
July 2019

Bid/Award  
November 2020

Construction  
May 2021

Opening  
Sept 2021









# *Projects in Planning*

---





### Improvements Include:

- Increase indoor space by 1.5x
- 2 indoor courts
- 3 multi-purpose rooms
- Larger exercise room
- All new playground, outdoor court & other amenities

<b>Total Project Budget</b>	<b>\$58,800,000</b>
Impact Fees, received	\$2,800,000
<i>Impact Fees, pending</i>	<i>\$25,000,000</i>
Downtown Park Fee	\$1,000,000
<i>2020 Health &amp; Recovery Bond</i>	<i>\$30,000,000</i>



**Planning**  
August 2014

**Design**  
July 2020

**Bid/Award**  
Feb 2022

**Construction**  
July 2022

**Opening**  
Jan 2024





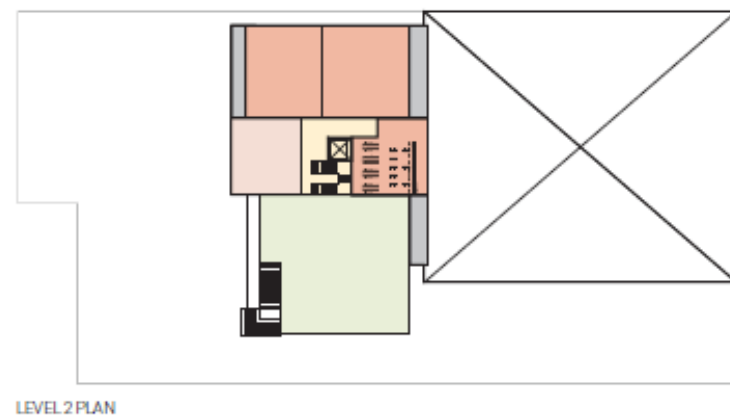
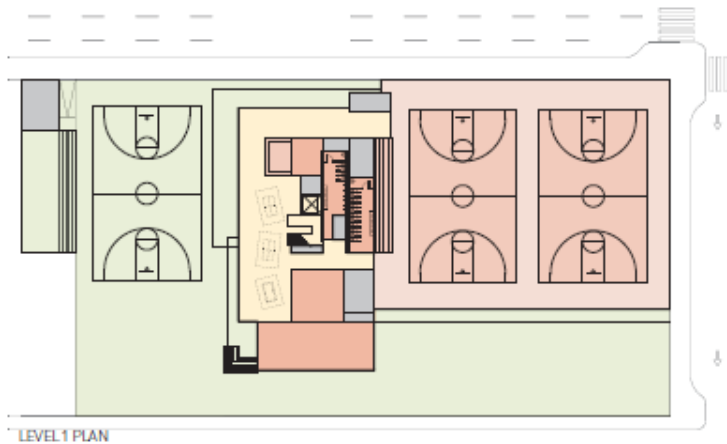

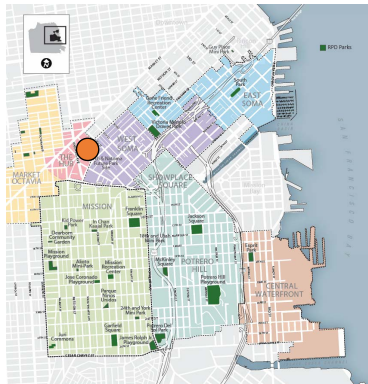

Open Space Acquisition Fund	\$275,000
Impact Fees (EN & MO)	\$11,800,000





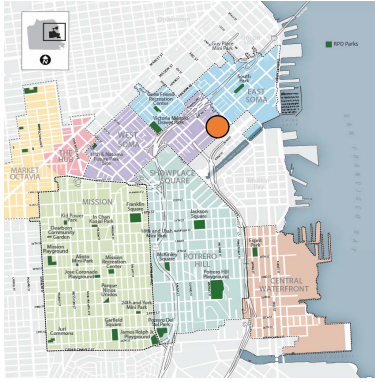

### Improvements Include

- New facility to be constructed by developer and dedicated to RPD upon completion
- 11,820 square-foot underground rec center
- 13,250 square-foot underground pool, including a children and senior pool and a 6-lane pool
- Pool provided by Developer; first floor community center delivered by City



Planning  
Aug 2020

Design  
In Process

Bid/Award  
TBD

Construction  
TBD

Opening  
TBD



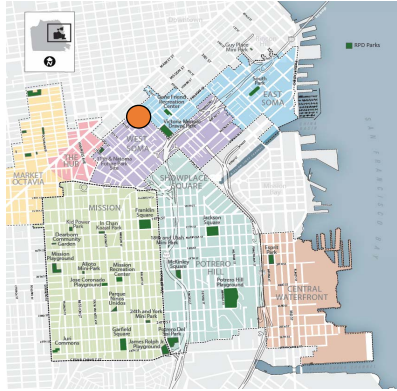

- 0.14-acre (6,150 sq.ft.) site on Mission St. between 7<sup>th</sup> & 8<sup>th</sup> streets
- Currently used as a parking lot
- Accessible from Mission St. (northeast) and Minna St. on (southeast) and bounded by buildings on two sides
- Suitable for both passive and active recreation uses
- Staff currently exploring the site



Planning  
In Process

Design  
TBD

Bid/Award  
TBD

Construction  
TBD

Opening  
TBD





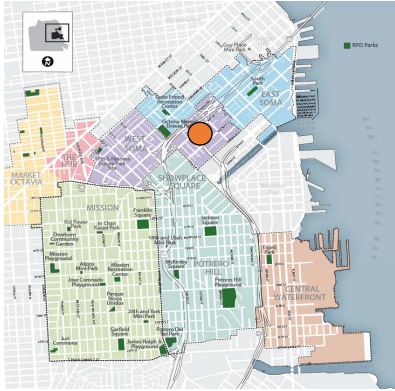

- ~10 acres of Caltrans-owned under-freeway land available in central SoMa through AB 857
- Near-term potential for ~5 acres between 4th and 5th streets
- RPD + Planning + SFE working to develop potential open space projects and identify funding

### Potential Improvements on these parcels may include:

- large dog run
- Bike/skate park
- Pollinator garden/native tree nursery
- Environmental initiatives

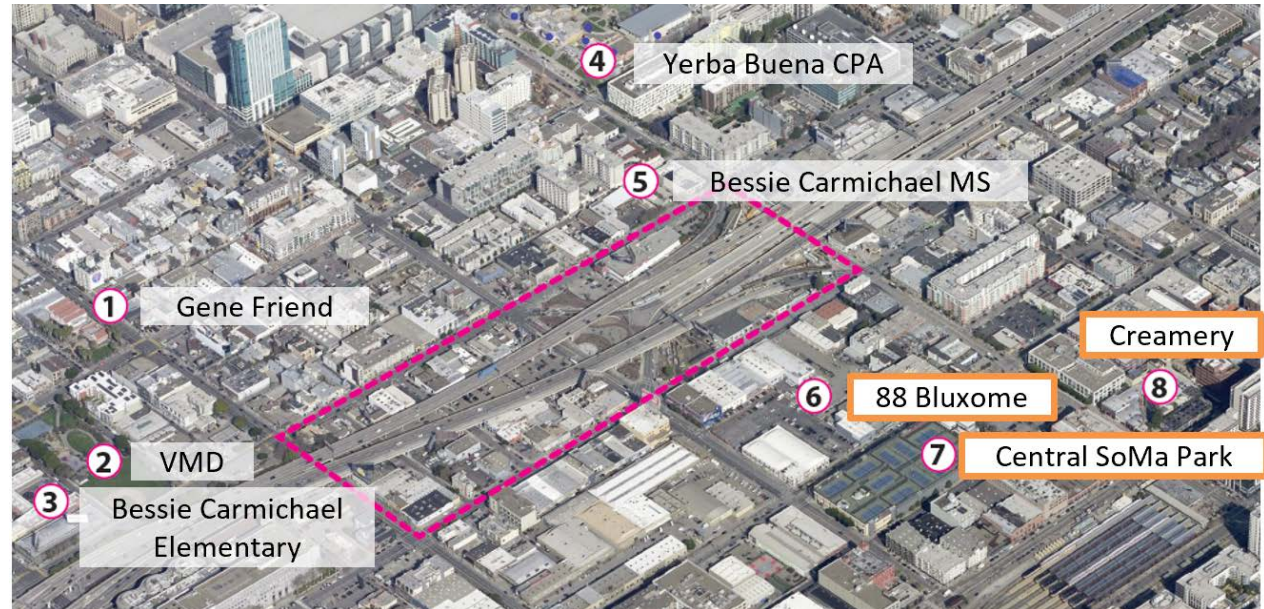

Planning  
August 2020

Design  
TBD

Bid/Award  
TBD

Construction  
TBD

Opening  
TBD



# *Completed Projects*

---







Total Project Budget	\$4,010,000
Impact Fees	\$1,500,000

Opened March 2017







# Thank You

