

# SURVEY RESULTS: PRIORITIZING PLACES

SF Planning launched a survey in late June 2019 to collect feedback on the community's priorities for locations of streetscape improvements, types of amenities, and neighborhood identity. We received nearly 150 responses!

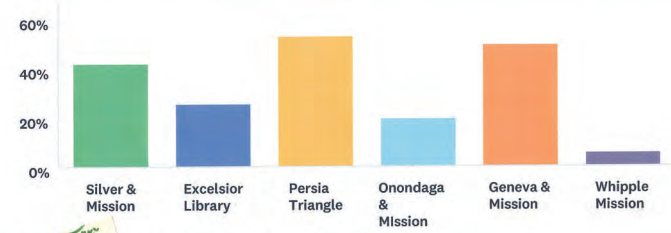

Based on prior outreach, we identified six community hubs along the Mission Street corridor. We've highlighted three areas where streetscape improvements would be most beneficial for the community, according to survey results.

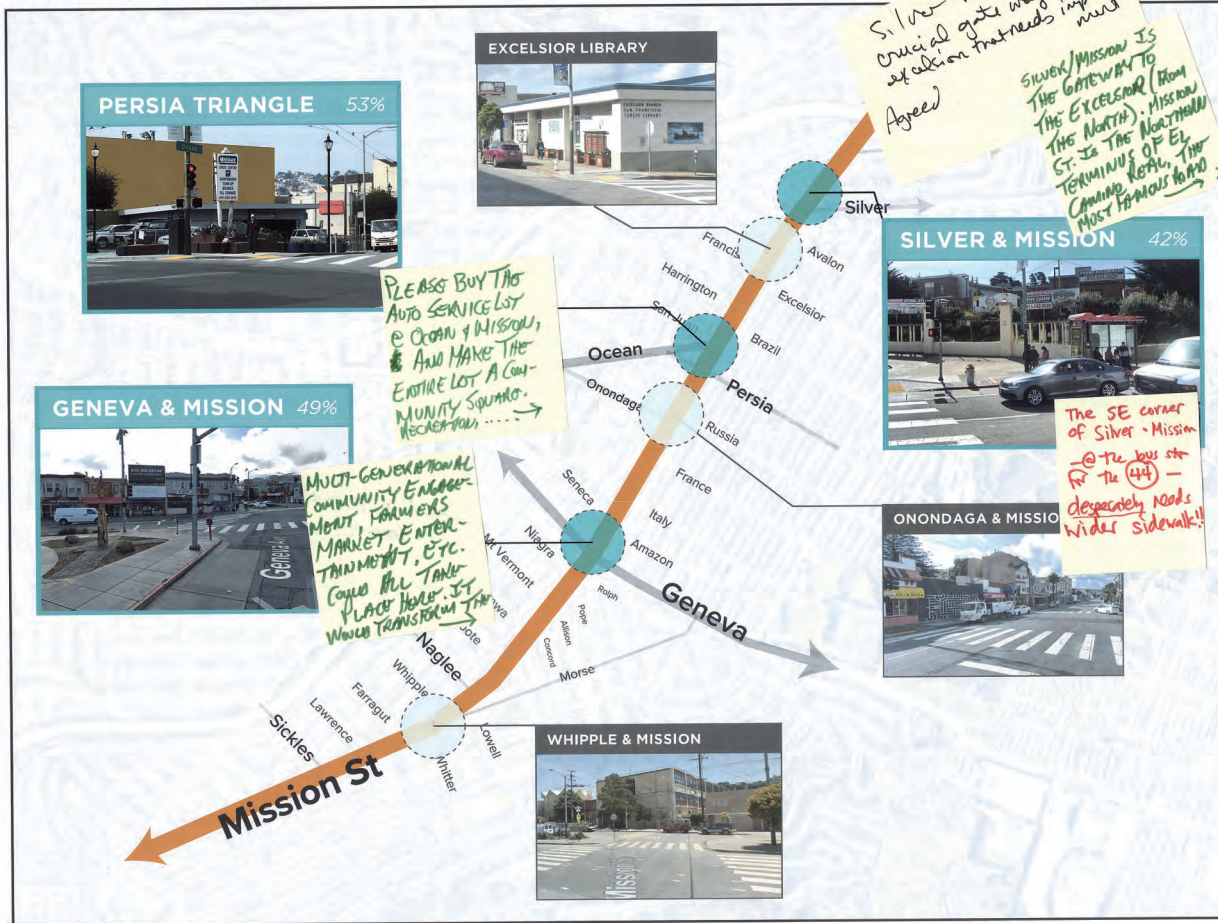

(out of 147 responses)

**COMMUNITY HUBS**

Key entrance and connection points between neighborhoods. These spaces offer the opportunity to reaffirm the neighborhood's identity and establish landmarks.

**TRANSIT HUBS**

Areas that have frequent transit service and high volumes of passenger loading. Typically, opportunities here include improving comfort, safety, and way-finding.

**ACTIVITY HUBS**

Areas with commercial, cultural, and community institutions that attract many visitors. Improvements here would help connect these places and provide spaces for the community to pause and to gather.

**EXAMPLES:**

- Balboa St
- 24th St
- Ocean Ave



For more information and to sign up for project updates, visit: <https://sfplanning.org/excelsior-outer-mission-streetscape-design-guidelines>

JULY 2019

# SURVEY RESULTS: PRIORITIZING AMENITIES

SF Planning launched a survey in late June 2019 to collect feedback on the community's priorities for locations of streetscape improvements, types of amenities, and neighborhood identity. We received nearly 150 responses!

Survey results  
(out of 147 responses)

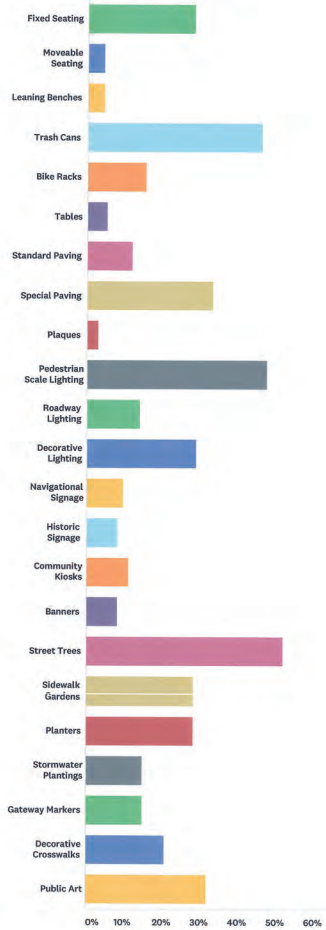

These are the top five (5) streetscape elements that would benefit the community the most, according to survey results.

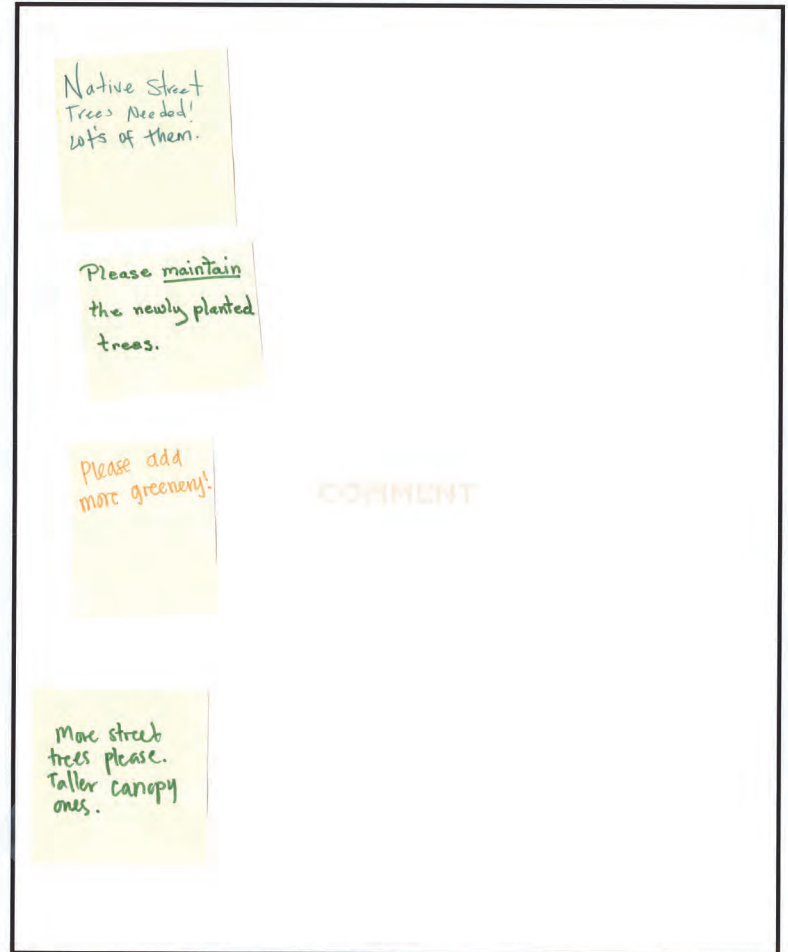
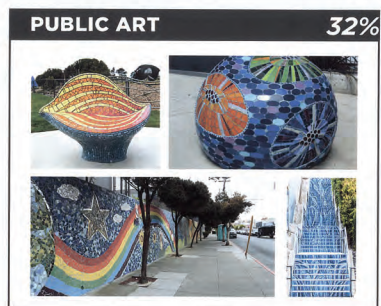

# SURVEY RESULTS: NEIGHBORHOOD IDENTITY

SF Planning launched a survey in late June 2019 to collect feedback on the community's priorities for locations of streetscape improvements, types of amenities, and neighborhood identity. We received nearly 150 responses!



## Which themes best reflect Excelsior's identity: Top 3 choices

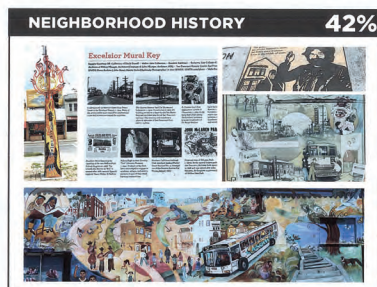
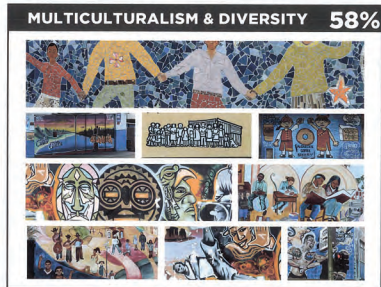

## Which set of textures and materials best reflect Excelsior's identity: Top 3 choices

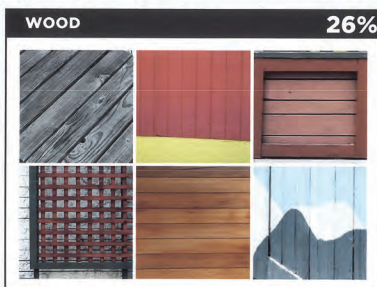
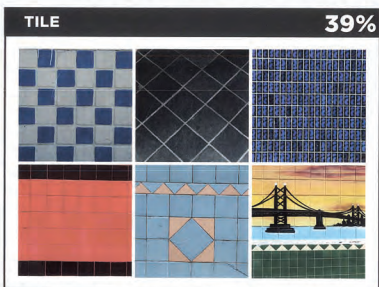
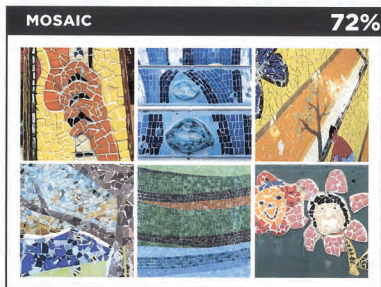

## Which color palette best reflects Excelsior's identity?

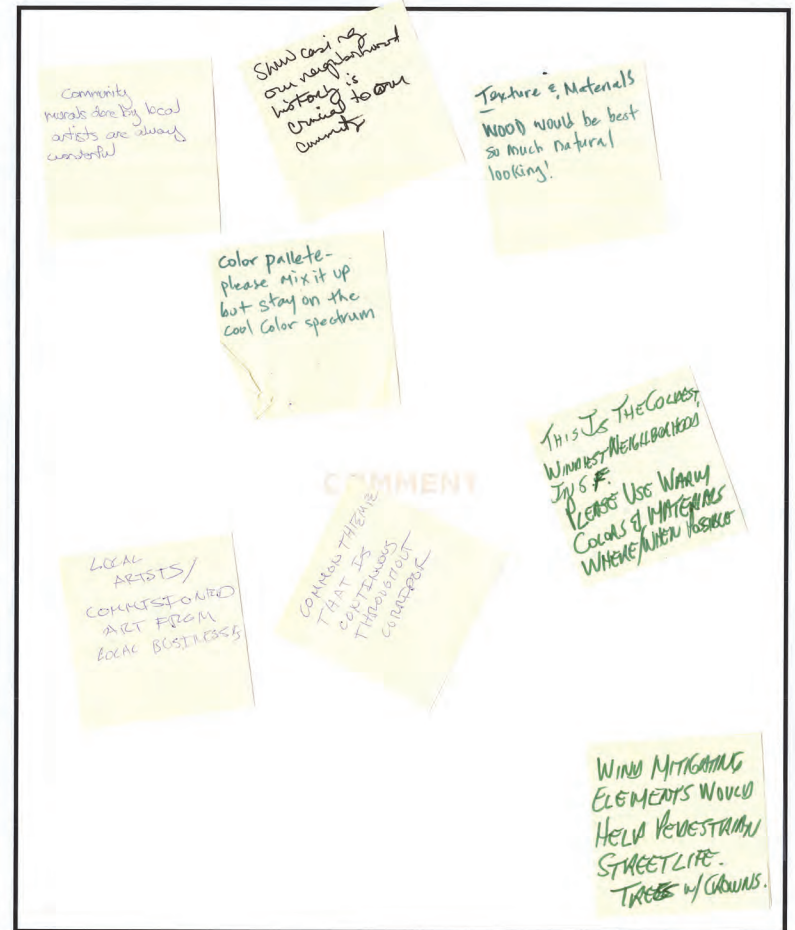

For more information and to sign up for project updates, visit:

<https://sfplanning.org/excelsior-outer-mission-streetscape-design-guidelines>

**JULY 2019**

# GUIDELINES COMPONENTS

The EOM Streetscape Design Guidelines will define two to four street typologies and a selection of streetscape materials.



## STREET TYPOLOGIES

A **street typology** identifies a type of intersection, in this case along the Mission Street corridor, from Trumball St to Sickles Ave. These typologies will propose a standard treatment and layout for street furniture, sidewalk pavers, trees, and seating elements.



*Safety projects are important, however, streets should not be drastically narrowed! - Don't over narrow! Thanks.*

## TRANSIT BULB TYPOLOGY

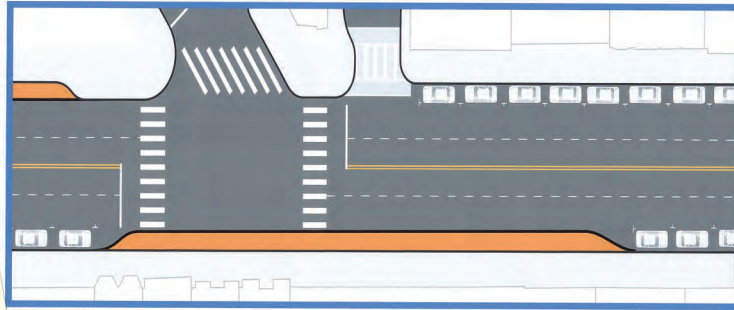

Whenever a transit bulb is present, this typology will prioritize passenger loading, while providing additional options for seating, as well as greening. The proposed street amenities can also be adapted to reflect the neighborhood's identity.

## PEDESTRIAN BULB TYPOLOGY

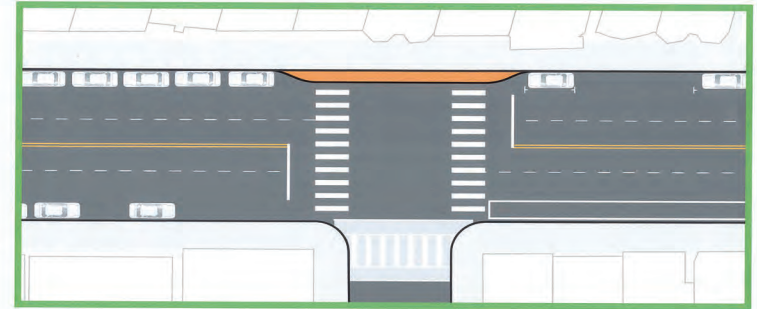

A pedestrian bulb is meant to improve the walking conditions and safety of pedestrians. For this typology, it spans two crosswalks on a "T" intersection, and can provide amenities for the public to pause and activate the commerces around the area.

## FOR REFERENCE: MISSION STREET EXCELSIOR SAFETY PROJECT

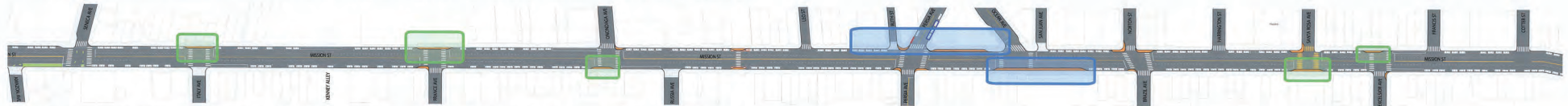

Portion of proposed safety improvements from the SFMTA Excelsior Mission St Safety Project

LEGEND ■ Bus bulbs ■ T-intersection Bulb-out

## MATERIALS SELECTION

The **materials selection** will define specific styles, materials, and colors for greening, lighting, furnishing, and community identity elements to encourage a unified identity. Here are some examples of materials found around the neighborhood

### MOSAIC



### WOOD

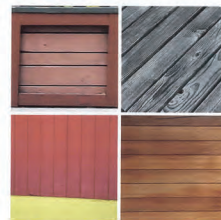

### TILE

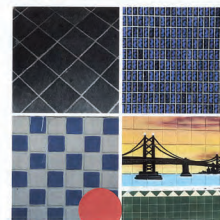

### BRICK



### METAL



### CONCRETE



For more information and to sign up for project updates, visit:

<https://sfplanning.org/excelsior-outer-mission-streetscape-design-guidelines>

JULY 2019

# CONCEPT A

THIS DESIGN UTILIZES A BANDING PAVING PATTERN THAT CONNECTS THE SIDEWALK TO GATHERING SPACES AT KEY LOCATIONS. THE DESIGN INCLUDES RAISED PLANTERS AND SEATING WITH MOSAIC TILES THAT REFLECT THE NEIGHBORHOOD MURALS. PLANTING WILL CELEBRATE AND SUPPORT BIODIVERSITY AND INCLUDE NATIVE CHOICES. NEW LIGHTING, BIKE RACKS, & TRASH RECEPTACLES WILL BE INCLUDED. THESE TYPOLOGIES WILL SERVE AS GATHERING SPACES WITHIN THE NEIGHBORHOOD.

\*THE LOCATIONS AND DESIGN OF STREETScape ELEMENTS ARE SUBJECT TO CHANGE DEPENDING ON AVAILABILITY OF MAINTENANCE RESOURCES.

## PEDESTRIAN TYPOLOGY

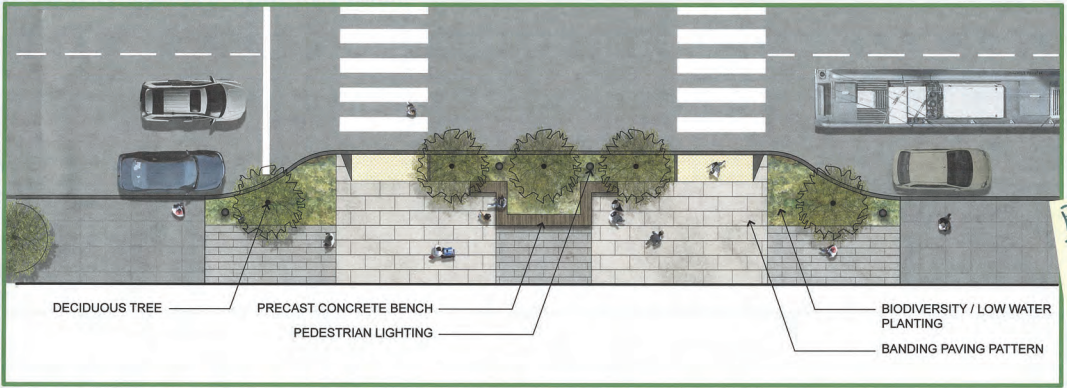

*Please anchor tables and chairs in areas that are green - would help reduce community stress! Yay! more tables!*

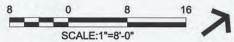

## DESIGN SECTIONS

### BENCH AND PLANTING

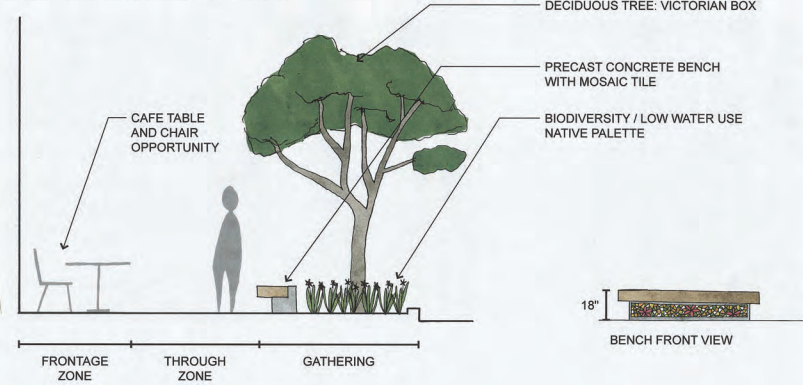

## TRANSIT TYPOLOGY

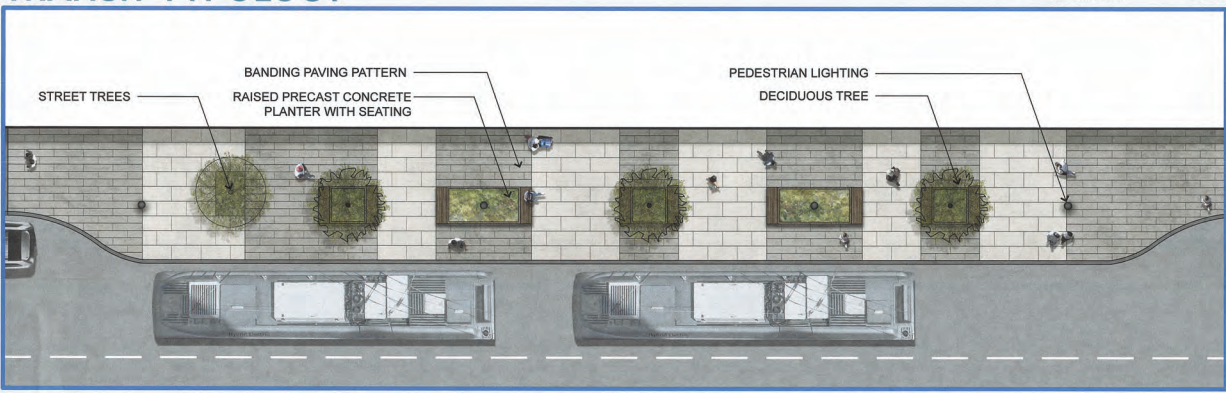

### RAISED PLANTERS

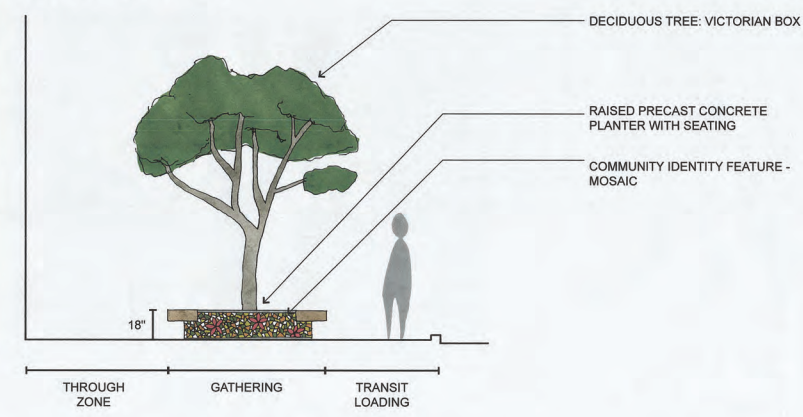

## MISSION STREET EXCELSIOR SAFETY PROJECT



### CONCEPTUAL DESIGN



JULY 2019

FOR MORE INFORMATION AND TO SIGN UP FOR PROJECT UPDATES, VISIT: [HTTPS://SFPLANNING.ORG/EXCELSIOR-OUTER-MISSION-NEIGHBORHOOD-STRATEGY](https://sfplanning.org/excelsior-outer-mission-neighborhood-strategy)



# STREETSCAPE ELEMENTS

VOTE ON YOUR FAVORITE IMAGE IN EACH CATEGORY

## CONCEPT A IMAGERY

## CONCEPT B IMAGERY

PLANTING



DECIDUOUS TREES



BIODIVERSITY / LOW WATER USE NATIVE PALETTE



MULTI-TRUNK PALM



MEDITERANEAN / LOW WATER USE PLANT PALETTE



LIGHTING



TEARDROP PEDESTRIAN LIGHTING



CATENARY LIGHTING (BY OTHERS)



POST TOP PEDESTRIAN LIGHTING



CATENARY LIGHTING (BY OTHERS)

*if there are going to be bike racks (which is great!) would be nice to have more bike-friendly routes in this neighborhood*

SITE FURNISHINGS



PRECAST CONCRETE PLANTER / BENCH WITH WOOD TOP



BIKE RACKS



TRASH RECEPTABLES



RAISED STEEL PLANTERS WITH SEATING



BIKE RACKS



TRASH RECEPTABLES

COMMUNITY IDENTITY FEATURE



MOSAIC ON PRECAST CONCRETE



GATEWAY FEATURE



PAVING



PRECAST CONCRETE PAVERS - BANDING PATTERN

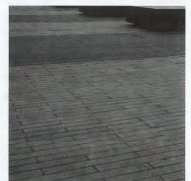

PRECAST CONCRETE PAVERS - WEAVE PATTERN

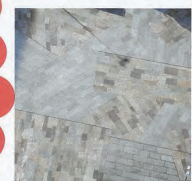

# CONCEPT B

THIS DESIGN UTILIZES A WEAVING PAVING PATTERN THAT IS REFLECTIVE OF THE VARIOUS CULTURES THAT EXIST IN THE NEIGHBORHOOD. RAISED STEEL PLANTERS W/ SEATING ELEMENTS ARE BEING PROPOSED THAT ARE ANGULAR AND REFLECTIVE OF MOVEMENT. FREESTANDING 'GATEWAY' STYLE FEATURES WILL BE INSTALLED AT KEY LOCATIONS AND WILL INCLUDE MOSAIC TILE MURALS. THE PLANTING CONCEPTS CELEBRATES THE MEDITERRANEAN CLIMATE OF CALIFORNIA AND WILL INCLUDE LOW WATER USE SUCCULENTS. NEW LIGHTING, BIKE RACKS, & TRASH RECEPTACLES WILL BE INCLUDED. THESE TYPOLOGIES WILL SERVE AS GATHERING SPACES WITHIN THE NEIGHBORHOOD.

\*THE LOCATIONS AND DESIGN OF STREETScape ELEMENTS ARE SUBJECT TO CHANGE DEPENDING ON AVAILABILITY OF MAINTENANCE RESOURCES.

## PEDESTRIAN TYPOLOGY

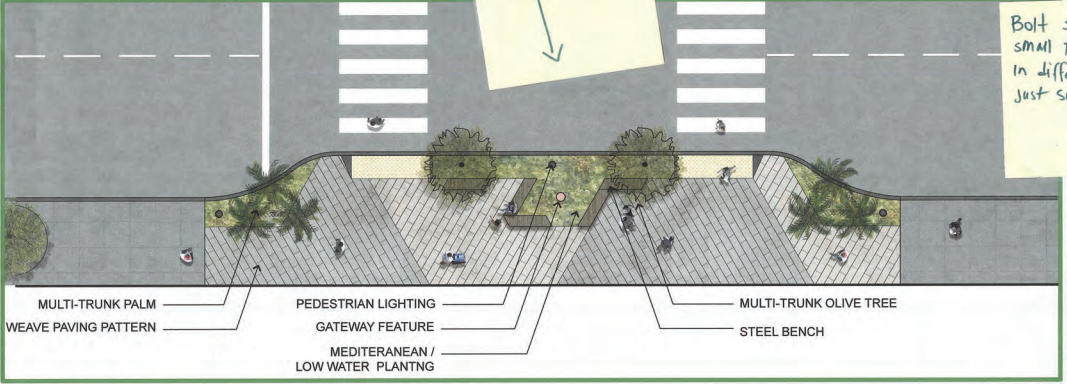

*This is Great, but the width should be narrower.*

*Bolt some small tables down! In different spots. just some :)*

## DESIGN SECTIONS

### BENCH AND PLANTING

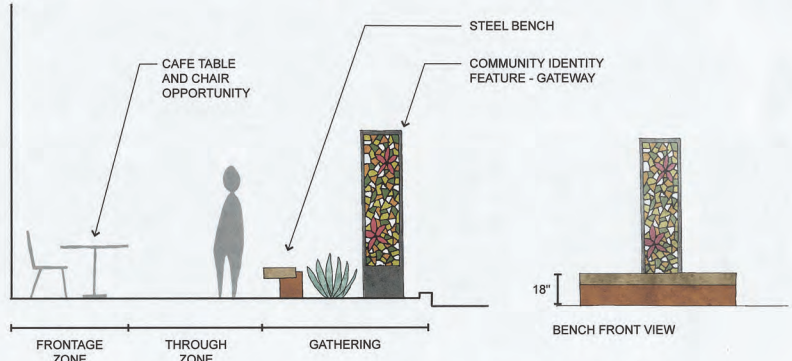

## TRANSIT TYPOLOGY

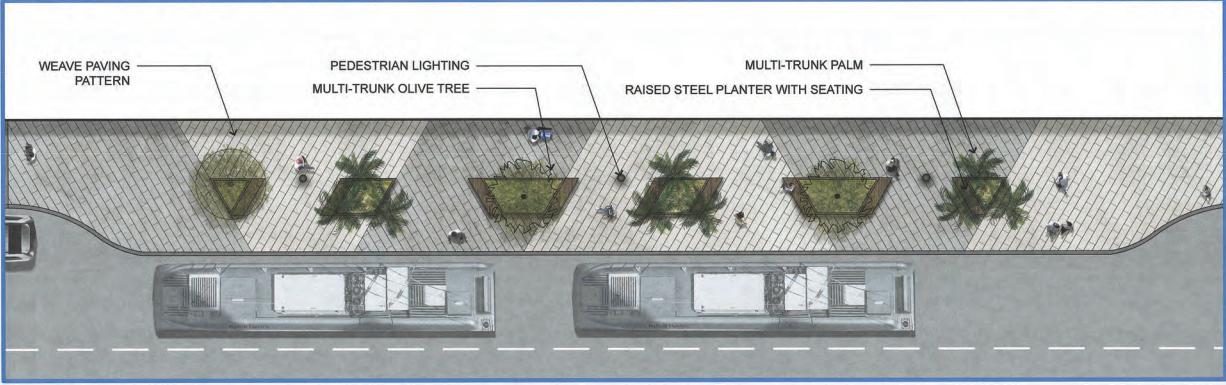

### RAISED PLANTERS

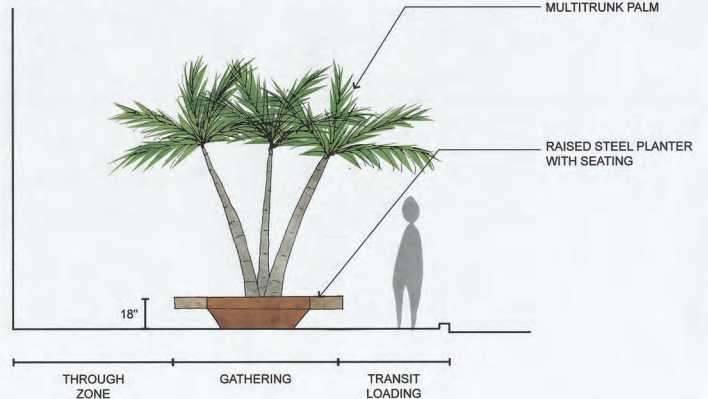

## MISSION STREET EXCELSIOR SAFETY PROJECT



Bus bulbs  
T-Intersection Bulb-out

### CONCEPTUAL DESIGN