

WELCOME!

Japantown Osaka Way Upgrades **COMMUNITY BRIEFING**

January 21, 2025

日本町

大阪ウェイ (ブキャナン モール)

アップグレードプロジェクト

JAPANTOWN

OSAKA WAY (BUCHANAN MALL)

UPGRADES PROJECT

SIMPLIFY

PRESENTATION

- Project Overview
- Outreach Summary
- Design Updates
- Next Steps



PROJECT OVERVIEW

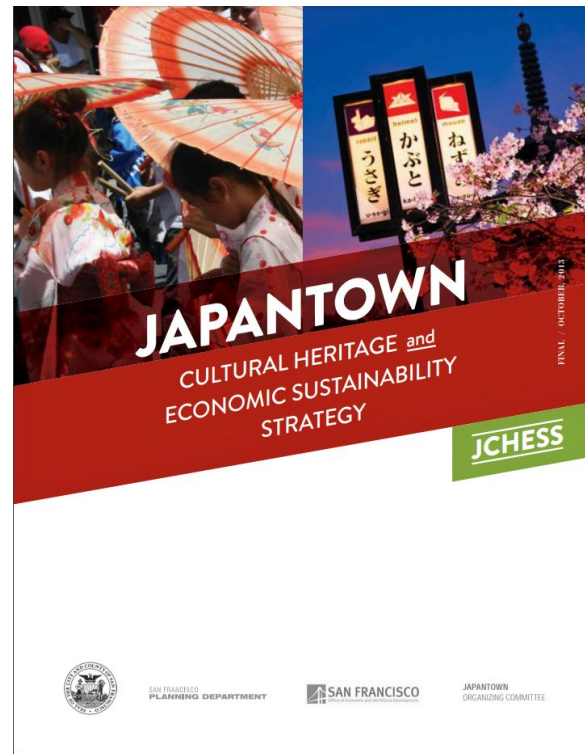
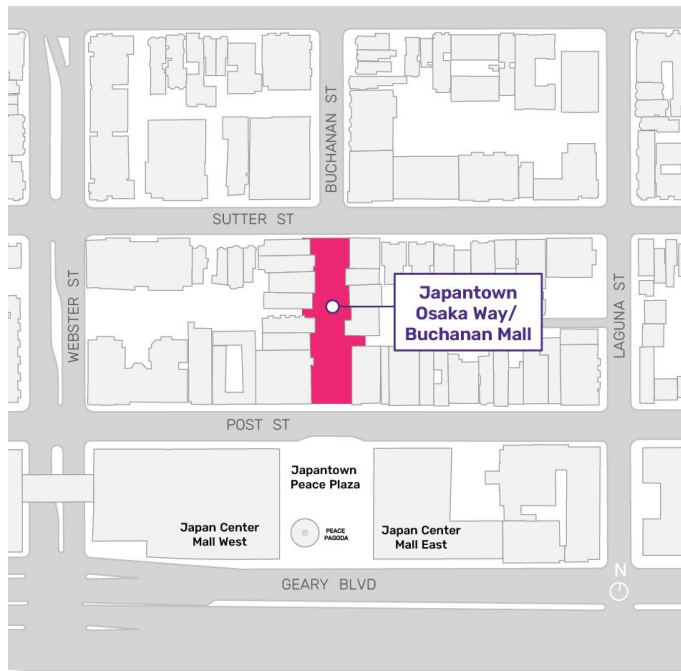

PROJECT GOALS

Allocated Funding: \$7M

1 ENHANCE ACCESSIBILITY



Enhance accessibility of Osaka Way for seniors and people with disabilities and limited mobility.

2 RESTORE THE RUTH ASAWA FOUNTAINS



Rehabilitate the Ruth Asawa fountains that are iconic to Osaka Way.

3 SUPPORT THE BUSINESS COMMUNITY



Support the business community by embellishing the sense of cultural authenticity and enhancing the commercial edges of Osaka Way.

PROJECT TIMELINE

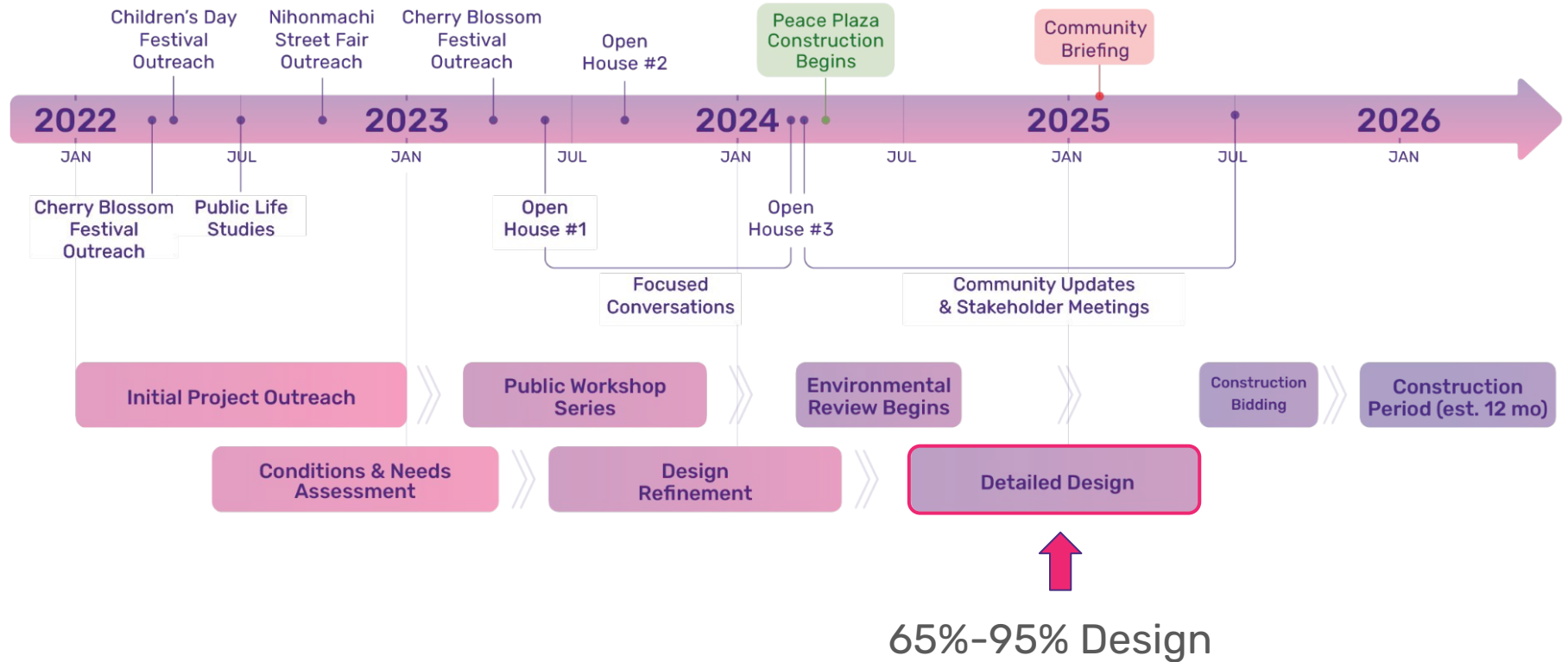

OUTREACH & ENGAGEMENT SUMMARY



STAKEHOLDER SITE VISIT

March 31, 2022

"Ceiling art displays like Lee Tung street in Hong Kong that people will come to in order to take photos"

"Add a sign indicating this is Japantown"



CHILDREN'S DAY FESTIVAL

May 7, 2022

"Better seating around the fountains (more comfortable)"

"Replace pavers with a non-tripping surface"



NIHONMACHI STREET FAIR

August 6, 2022

"Wishing wall (write wishes and hang them)"



CHERRY BLOSSOM FESTIVAL

April 8-9 & 15-16, 2023

"Keep string lights year round"

"Plant more cherry trees"

"Study area for students"



YOUTH ENGAGEMENT

July 2023

STAKEHOLDER CONVERSATIONS

December 2023 - January 2024

- JTF Board Presentation
- Design Charette with core stakeholders (Asawa Family & Estate, Japantown CBD, JTF, NPC)
- Osaka Sister City Association at Deputy Consul General Briefing
- Community Conversations
- Design Charette with Community Consultant Megumi Aihara

DESIGN SURVEYS

- Over 100 responses (online and paper surveys)
- See Design Survey Summary board

OPEN HOUSE #3

February 2024

OPEN HOUSE #2

October 3, 2023

SENIOR ENGAGEMENT

- Surveys with: Kokoro, The Carlisle, Sequoia, Nihonmachi Terrace, Kimochi, Ivy Living
- August 2023

1ST MERCHANT FOCUS GROUPS

- 9/12: In-person Focus Group
- 9/13: Virtual Focus Group September 2023



OPEN HOUSE #1

May 31, 2023

"More trees! Gardens! Modular/Moveable gardens :)"



CHERRY BLOSSOM FESTIVAL

April 9-10 & 16-17, 2022



PUBLIC LIFE STUDIES

July, 2022

2022

025

2023

2024

BEHIND THE SCENES



Material samples review for Stone River.



Fountain consultant kick-off.



Lantern samples review on site.

DESIGN UPDATES

- Preferred Design Direction
- Design Limitations
- Updated Design
 - ◆ Catenary Lighting
 - ◆ Alleys
 - ◆ Gateway Sign
 - ◆ Relocated Cherry Trees



PREFERRED DESIGN DIRECTION - OPEN HOUSE #3



8 pedestrian scale pole lighting (16ft)



9 garden gate lighting



10 lanterns (see options)



11 string lights (see options)



12 reinstall lamp posts



13 movable furnishings + storage structure



1 precast seat walls



2 restored fountains w/ new plumbing and lighting



3 cobble w/ compliant walking surface



4 stone paving w/ metal inlay accents



5 refurbished Ruth Asawa benches



6 ginkgo trees



7 cherry trees

DESIGN LIMITATIONS

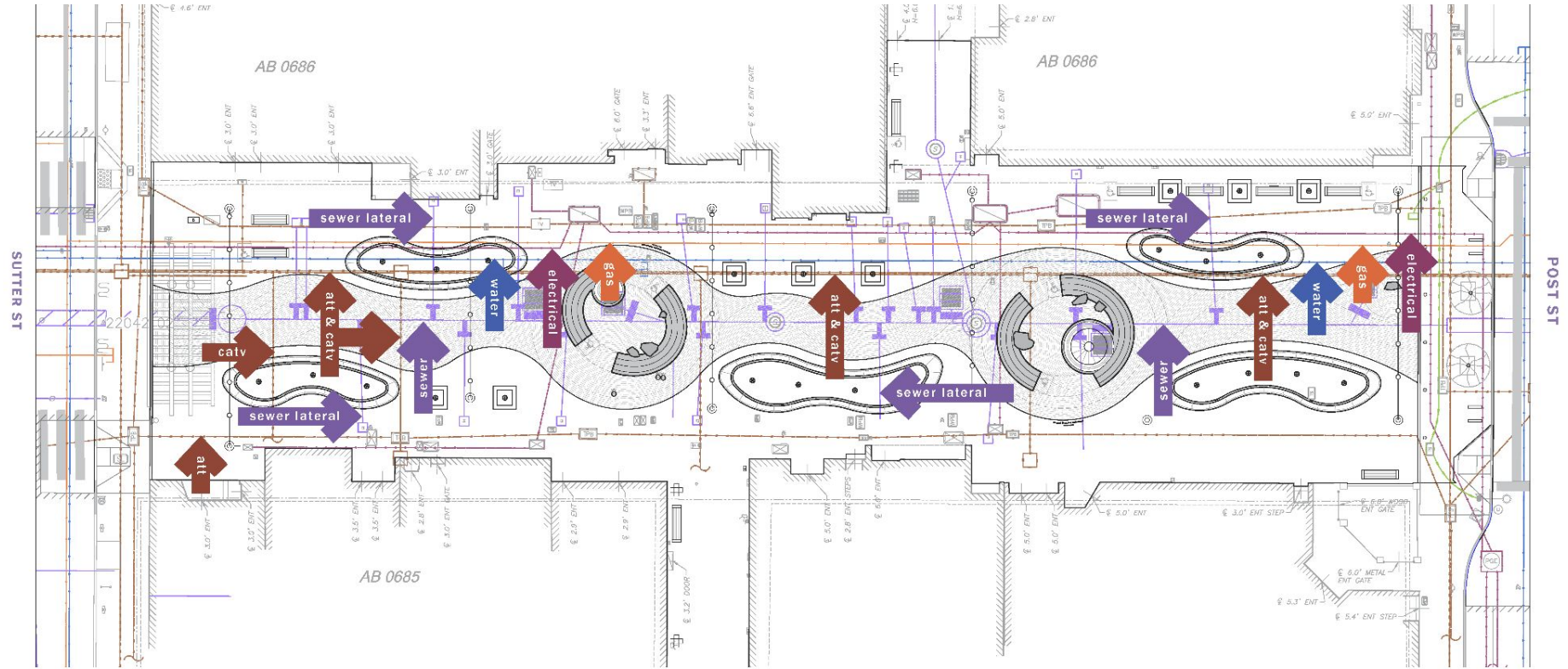

UPDATED PLAN



8 pedestrian scale pole lighting (16ft)



9 garden gate lighting & entry sign

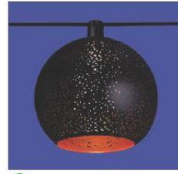

10 catenary lighting (see options)



11 36"x18" pole banners



12 reinstall (5) lamp posts



13 cherry tree plaques



1 precast seat walls



2 restored fountains w/ drainage basin, plumbing, and signage



3 ADA compliant granite cobble river



4 exposed aggregate concrete



5 refurbished Ruth Asawa benches

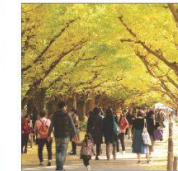

6 ginkgo trees



7 cherry trees

POST ST ENTRY



PLANTER SIDE ELEVATION



CATENARY LIGHTING - OPTION 1: OFF-WHITE/BEIGE



CATENARY LIGHTING - OPTION 1: OFF-WHITE/BEIGE



12" Ambria, 42" spacing, 12'-14' high
-custom metal finish color
-adjustable temperature, but not color



CATENARY LIGHTING - OPTION 2: RED



CATENARY LIGHTING - OPTION 2: RED

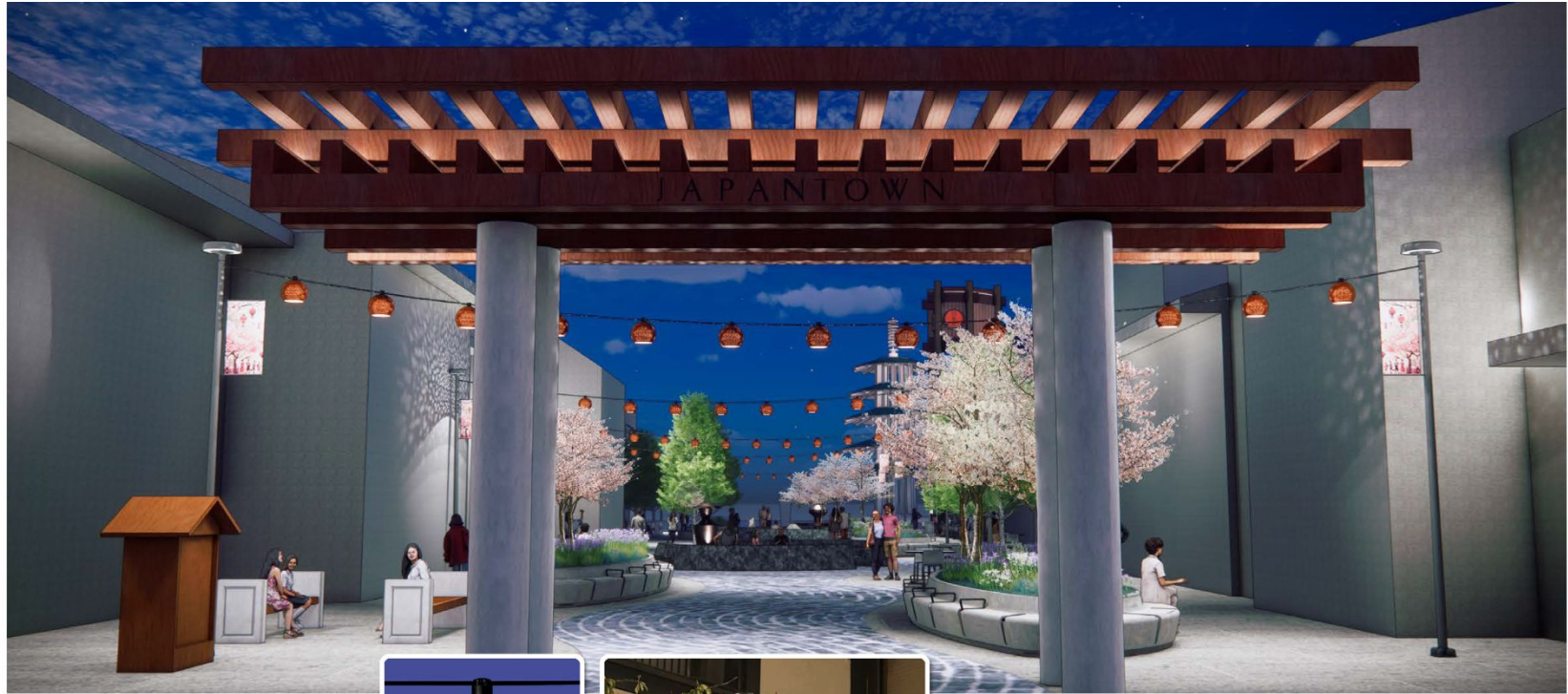

12" Ambria, 42" spacing, 12'-14' high
-custom metal finish color
-adjustable temperature, but not color



CATENARY LIGHTING - OPTIONS COMPARISON

Option 1: Off-white/beige



POST ST - DAY

Option 2: Red



SUTTER ST - NIGHT



ALLEYS



C WEST ALLEY



D EAST ALLEY



GATEWAY SIGN



RELOCATED CHERRY TREES & PLAQUES

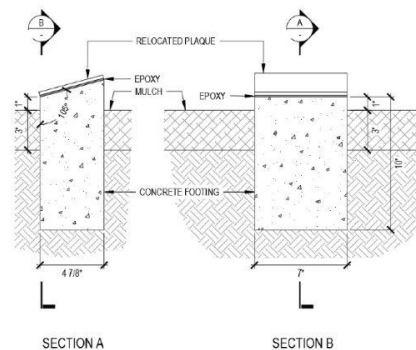
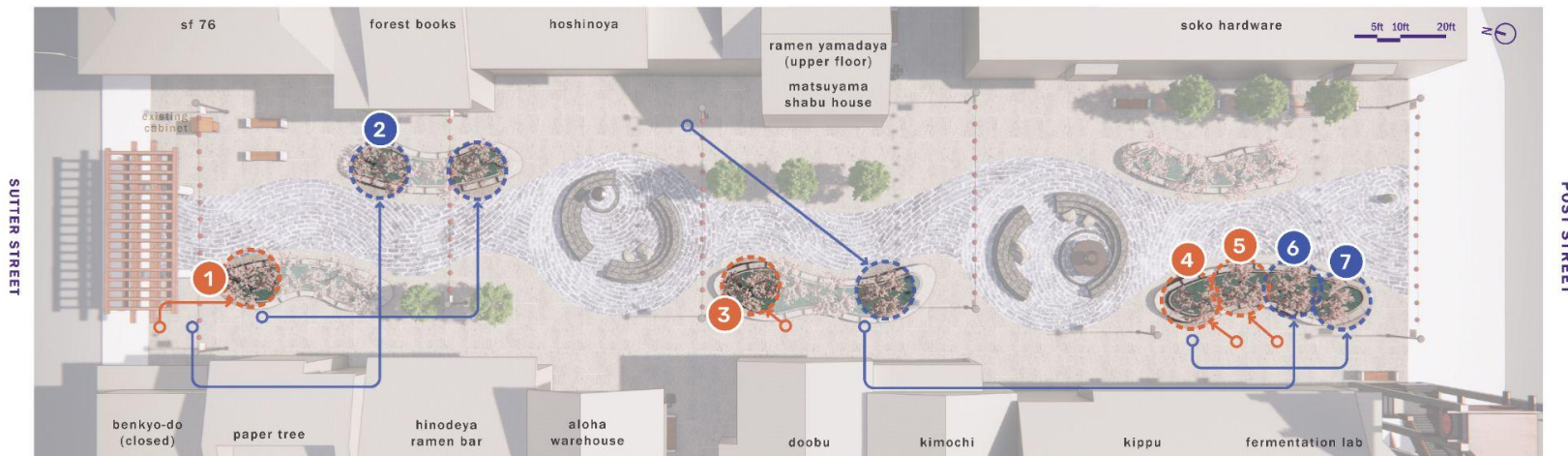

NEXT STEPS

- Fountain Design
- Next Steps
- Timeline Recap



ORIGAMI FOUNTAINS



E NORTH FOUNTAIN

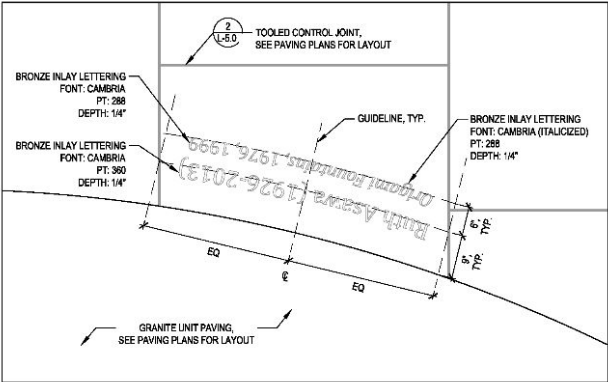

NORTH FOUNTAIN LETTERING

ORIGAMI FOUNTAINS

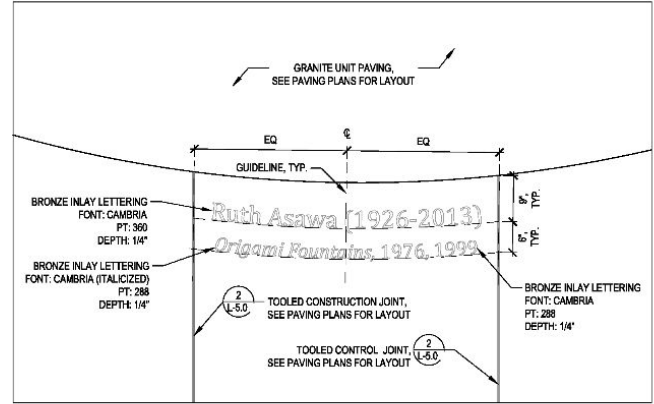

SOUTH FOUNTAIN LETTERING



NEXT STEPS

- 95% Design (February 2025)
 - ◆ Design is almost complete with plans, specifications, details, final engineer's cost estimate
 - ◆ Final design/constructability reviews begin
- 100% Design (April 2025)
 - ◆ Contract document sign-off
 - ◆ Package documents for advertisement
- Construction Contract Advertisement & Bidding Process (May 2025)
 - ◆ ~6 month process
- Construction Start date: Anticipated Fall 2025
 - ◆ Construction period: Estimated 12 months

PROJECT TIMELINE

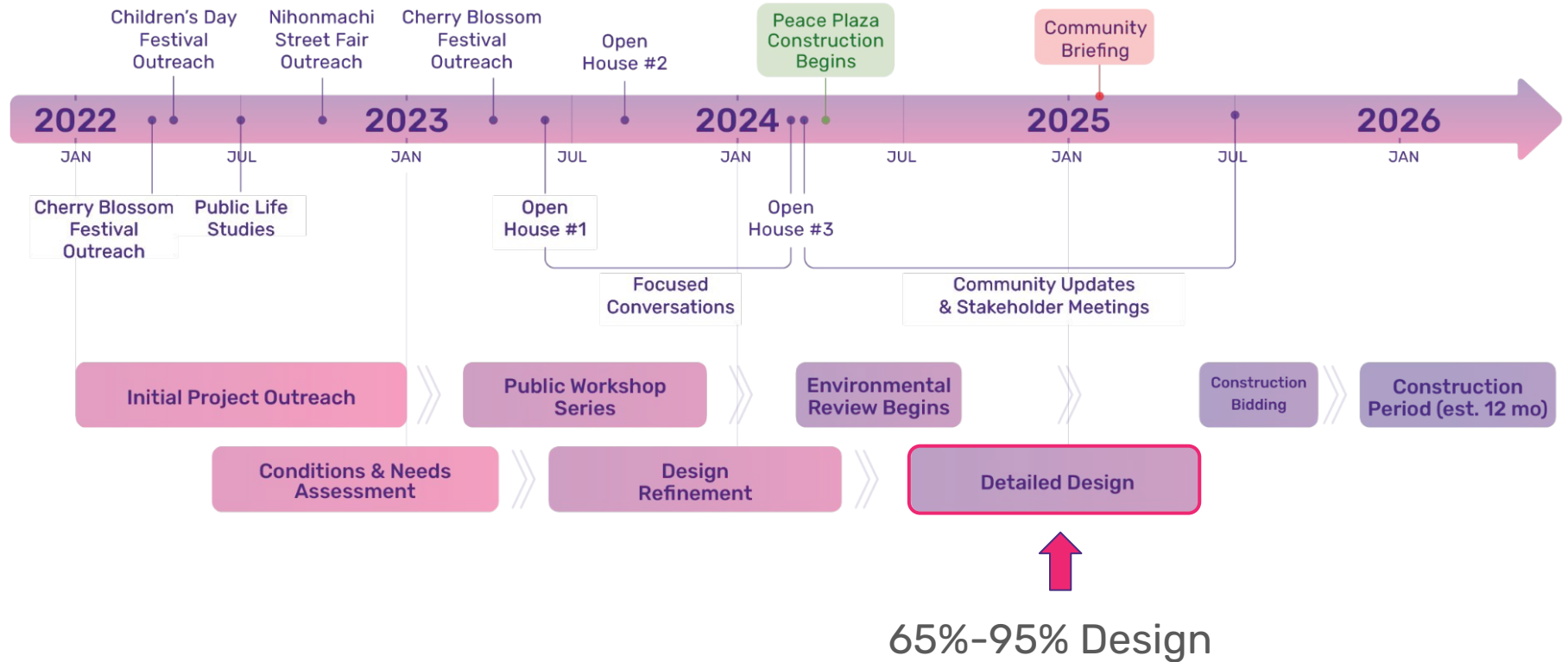

QUESTIONS?



THANK YOU!

osakaway.org

María De Alva, *Outreach and Engagement*

San Francisco Planning
maria.dealva@sfgov.org

Trent Tieger, *Project Manager*

San Francisco Public Works
trent.tieger@sfdpw.org