

JAPANTOWN OSAKA WAY / BUCHANAN MALL

IMPROVEMENTS PROJECT



Japantown Buchanan Mall, looking south towards Peace Plaza

Japantown's Buchanan Mall (Osaka Way) is the pedestrian portion of Buchanan Street that runs for one block between Post and Sutter streets. Along with Peace Plaza, it's the geographic and cultural heart of the neighborhood.

Designed in the 1960s, Osaka Way is paved with a river of cobblestones, connecting two fountain installations, consisting of origami flower forms designed by

renowned artist Ruth Asawa, and surrounded by low, circular stone walls.

This walkway is lined by restaurants, stores, and cultural institutions on both sides, allowing residents and visitors to experience Japantown's culture in a pedestrian environment.

The community has identified a few areas for improvement:

PROJECT GOALS

1

ENHANCE ACCESSIBILITY



Enhance accessibility of Osaka Way for seniors and people with disabilities and limited mobility.

2

RESTORE THE RUTH ASAWA FOUNTAINS



Rehabilitate the Ruth Asawa fountains that are iconic to Osaka Way.

3

SUPPORT THE BUSINESS COMMUNITY



Support the business community by embellishing the sense of cultural authenticity and enhancing the commercial edges of Osaka Way.



EXISTING CONDITIONS



A Origami Fountain - South



B Origami Fountain - North



C Cobblestone River



D Torii Gateway Structure

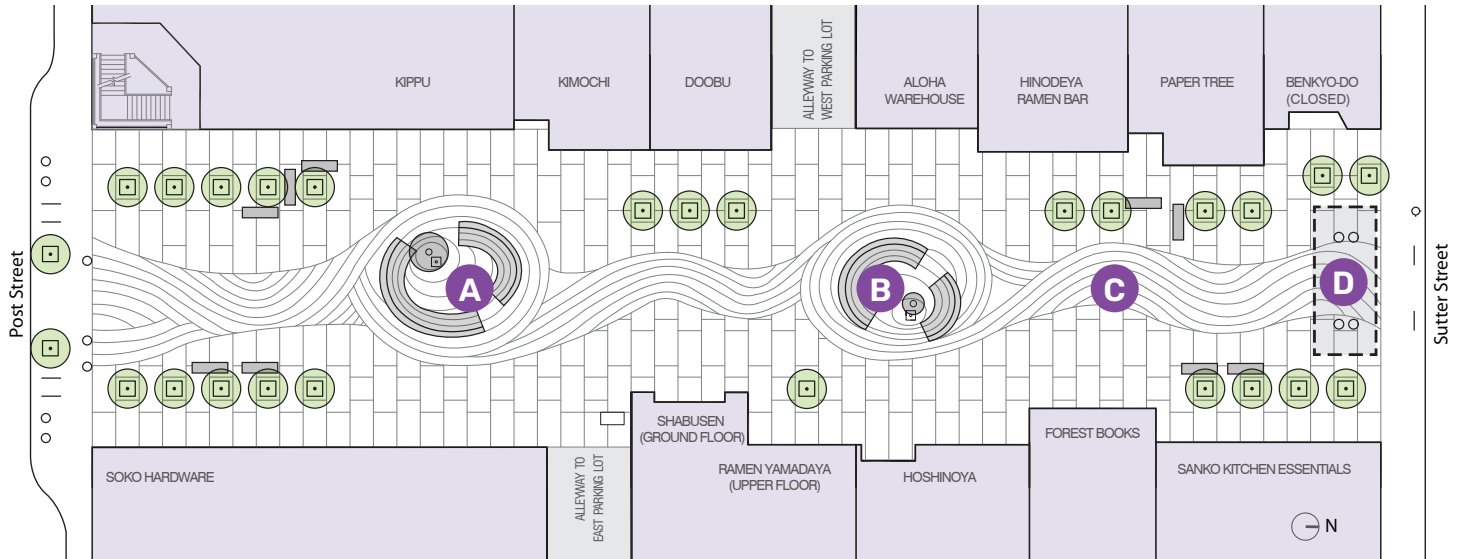

Context map

PROJECT TIMELINE *(subject to changes)*

- **Spring 2022 - Winter 2023**
Conditions & Needs Assessment, Initial Project Outreach
- **Spring 2023 - Summer 2023**
Public Workshop Series and Conceptual Design Development
- **Summer 2023 - Spring 2024**
Design Refinement, Environmental Review
- **Summer 2024**
Detailed Design
- **Spring 2025**
Construction begins

HOW TO GET INVOLVED

CONTACT INFORMATION:

Trent Tieger
Project Implementation
Public Works
Trent.Tieger@sfdpw.org

María De Alva
Community Outreach and Engagement
San Francisco Planning
Maria.DeAlva@sfgov.org

SIGN UP FOR OUR MAILING LIST!

SFPlanning.org/JapantownBuchananMall

